

A500



Material

Body: Polyamide DIN-EN ISO 1043-1 PA6 GFR 30.

Locking Cylinder: die cast zinc.
Seal: PU and Rubber.

Technical Notes

Swing handles ideal for electrical panels or enclosures, and especially where used in conjunction with our A026 rod and guide system to create a full latching system.

Sealed to IP65 or NEMA 4 rating.
Dimension "h" is the distance by which the cam is offset. **To select correct cam offset use "h" calculation formula on page 52.**

Tips

Order cams and key separately.
Keys- A010 page 51.

Suitable Cams- A020, A022 and A024 page 52.

Select cams without projection.

Rods and guides- A030 page 56 to A032 page 57.

Other inserts available, subject to minimum order quantities.

Important Notes

Operation of handle is straight forward, once key has been actuated the lever can be lifted and swung through 90° to actuate cam. For installation information see cut out detail.

Swing Handles, Flexi-System

quarter turn fasteners

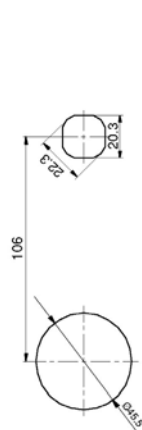

cut out detail

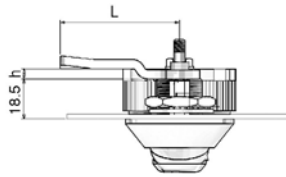
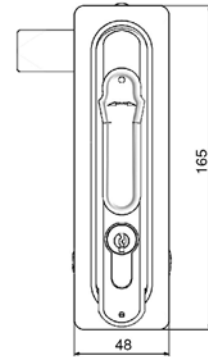
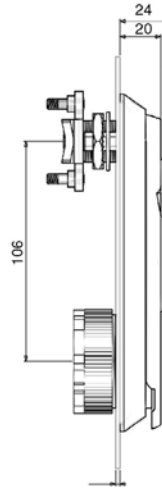

Order No. Standard	Order No. Padlockable	Insert Type
A500.AC010	A500.AC510	Keyed alike
A500.AC020	A500.AC520	Keyed to differ
A500.AC030	A500.AC530	Pin 5 mm
A500.AC040	A500.AC540	Square 8
A500.AC050	A500.AC550	Triangle 9

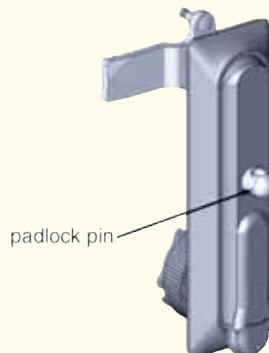

padlock pin

Swing handles - cylinder lock and insert variations:

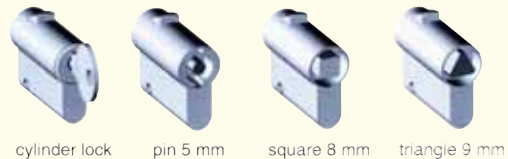

cylinder lock

pin 5 mm

square 8 mm

triangle 9 mm