

## A750 to A790

### electronic locking system

Wixroyd's electronic locking system A750 to A790 provide the ideal combination of ergonomics, productivity and safety for machine guards, enclosures or where ever there is a machine/operator interface.

Wixroyd's electronic locking system incorporates switching, control and monitoring functions exactly at the point they are required - namely the enclosure handle.

All models in the series have been designed on the same basic principles and can incorporate the following functions:

#### Simple operation:

all buttons and controls on the handles are simply activated with the thumb allowing for control and opening of the guard in just one movement.

#### Deactivation of dead lock:

each handle has a button to deactivate and unlock the dead lock, two LED's indicate whether the door is locked or unlocked.

#### Safety:

machine start and stop buttons can optionally be integrated into the handle, as well as a machine emergency stop button.

#### Modular design:

handle A755 has been designed on a modular basis allowing for individual programming of handle functions for your own application.

#### Electromechanical locking:

in combination with our solenoid interlocking devices A790, our electronic locking system provides an electromechanical locking system for both revolving and push doors.

As well as a fully functional handles, basic non-functional handles are available in the same design to act as counter-handles for double door applications.

A multitude of functional capabilities....



#### Release button:

Activating the release button deactivates the dead lock and opens the safety door. Two LED's above the release button indicate to the operator whether the door is locked or unlocked.



#### Emergency stop button:

An optional emergency stop button can be incorporated into the handle and allows the operator, in the event of danger, to bring the entire machine to a stand still. The machine can then be resumed by re-setting the handle via a twist of the emergency button. Emergency button conforms to EN418



#### Start button:

Machine start buttons can be included in the handle to initiate the machine.



The start button can be positioned either above the door release button or, when no emergency stop button is used, can be positioned on the top of the handle.



Solenoid interlocks A790 can be used to bolt doors or enclosures mechanically, with switching contacts enabling the monitoring of the lock/enclosure status:

- door open/ door closed
- door locked/ door unlocked

## A750

### Material:

Handle shanks of extruded aluminium AIMgSi 0,5, black anodized with a mat gloss finish. Tube made of Ø30 x 1,5 mm stainless steel 1.4301, precision ground.

### Electrical Version:

Key lock switch with changeover contact. Key can only be withdrawn in locked position . Connection: Coupling as soldered version.

### Mechanical Version:

For mechanical fastening on frames up to 63 mm. Available in either square key version or safety key version.

Cams are available for the locking system, either plain or hooked (left and right) and with a variety of cam off-sets. Please order cam separately, see A750 technical specification. (Part nos. A750.AC900 to A750.AC923.)



**Electrical version:**  
key switch



**Mechanical version:**  
safety key



**Mechanical version:**  
square key

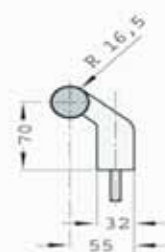

| Order No.<br>Electric Version | Order No.<br>Mechanical<br>Short Stem | Order No.<br>Mechanical<br>Short Stem | Type       | A   | L   |
|-------------------------------|---------------------------------------|---------------------------------------|------------|-----|-----|
| A750.AC037                    | -                                     | -                                     | Key Switch | 300 | 392 |
| -                             | A750.AC137                            | A750.AC237                            | Square Key | 300 | 392 |
| -                             | A750.AC138                            | A750.AC238                            | Safety Key | 300 | 392 |
| A750.AC047                    | -                                     | -                                     | Key Switch | 400 | 492 |
| -                             | A750.AC147                            | A750.AC247                            | Square Key | 400 | 492 |
| -                             | A750.AC148                            | A750.AC248                            | Safety Key | 400 | 492 |
| A750.AC067                    | -                                     | -                                     | Key Switch | 600 | 692 |
| -                             | A750.AC167                            | A750.AC267                            | Square Key | 600 | 692 |
| -                             | A750.AC168                            | A750.AC268                            | Safety Key | 600 | 692 |

## Electrical Versions

A750.AC037  
A750.AC047  
A750.AC067

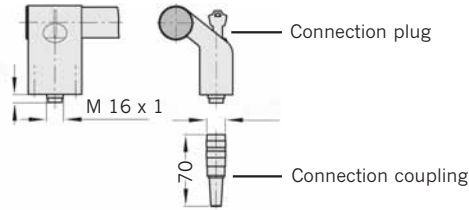

### Connection



### Key can be withdrawn in position A

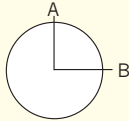

### Switching voltage

28 VDC/125 VAC  
250 VAC

### Switching current

4 A  
2 A

### Connection coupling



## Mechanical Versions

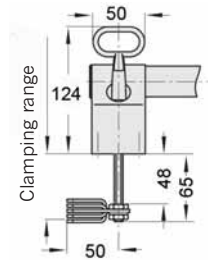
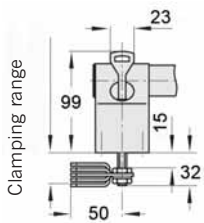

A750. AC137 to AC168  
short stem version

A750. AC237 to AC268  
long stem version

### Plain Cam

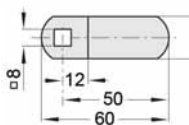

### Hooked Cam

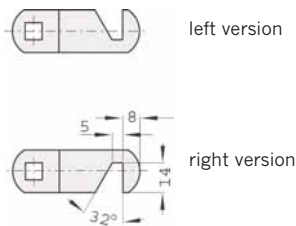

### Cam Off-sets

for plain and hooked cams

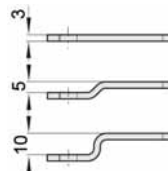

| Order No.<br>Plain Cam | Order No.<br>Hooked Cam<br>Left | Order No.<br>Right<br>Fasteners | Version         | Rotation   | Clamping Range          |    |                        |    |
|------------------------|---------------------------------|---------------------------------|-----------------|------------|-------------------------|----|------------------------|----|
|                        |                                 |                                 |                 |            | Short Stem<br>min - max |    | Long Stem<br>min - max |    |
| A750.AC900             | A750.AC910                      | A750.AC920                      | Straight        | 0°<br>180° | 5                       | 20 | 5                      | 33 |
| A750.AC902             | A750.AC912                      | A750.AC922                      | 5 mm<br>offset  | 0°<br>180° | 0                       | 15 | 0                      | 48 |
| A750.AC903             | A750.AC913                      | A750.AC923                      | 10 mm<br>offset | 0°<br>180° | 0                       | 10 | 0                      | 43 |
|                        |                                 |                                 |                 |            | 15                      | 30 | 15                     | 63 |