

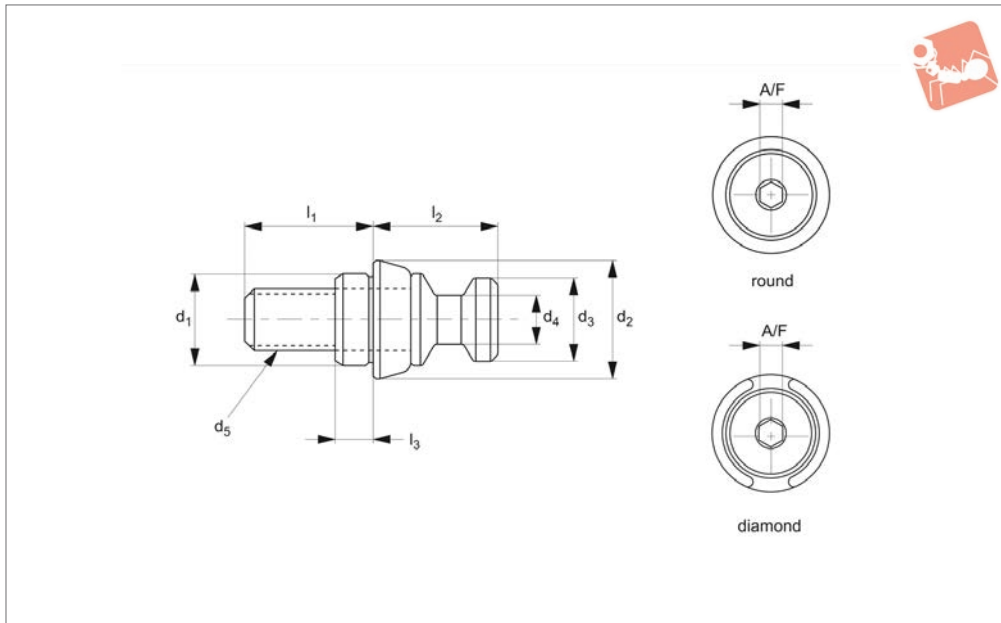

# Tapered Clamping Screws

round and diamond

## Bore Clamping



**12046**

BORE CLAMPING

### Material

Bushing: steel (C45E), black oxide finish, precision ground.

Screw: steel (SCM435), tempered, black oxide finish.

### Technical Notes

For suitable clamping modules, see parts

12043, 12044 and 12045.

Round type can be used for mounting 12044 double clamping module to fixture plate.

Used together, round and diamond type tapered clamping screws can provide x and y location of workpiece with up to 5 micron

repeatability.

Order No.	$l_1$	Suitable clamping module size	Type	Size	$d_1$ tol. g6	$d_2$	$d_3$	$d_4$	$d_5$	$l_2$	$l_3$	A/F	Weight g
12046.W0061	13	8	Round	8	8	11,5	8	4,8	M 6x1,00	10,0	5,0	3	6
12046.W0062	17	11	Round	11	10	15,5	11	6,5	M 6x1,00	16,5	5,0	3	17
12046.W0081	17	11	Round	11	12	15,5	11	6,5	M 8x1,25	16,5	5,0	3	20
12046.W0082	17	16	Round	16	12	24,5	16	9,5	M 8x1,25	25,0	5,0	5	52
12046.W0121	24	16	Round	16	18	24,5	16	9,5	M12x1,75	25,0	6,0	5	70
12046.W0122	24	21	Round	21	18	31,5	21	13,0	M12x1,75	33,0	6,0	6	125
12046.W0161	30	21	Round	21	22	31,5	21	13,0	M16x2,01	33,0	7,5	6	150
12046.W4062	17	11	Diamond	11	10	15,5	11	6,5	M 6x1,01	16,5	5,0	3	17
12046.W4081	17	11	Diamond	11	12	15,5	11	6,5	M 8x1,26	16,5	5,0	3	20
12046.W4082	17	16	Diamond	16	12	24,5	16	9,5	M 8x1,26	25,0	5,0	5	52
12046.W4121	24	16	Diamond	16	18	24,5	16	9,5	M12x1,75	25,0	6,0	5	70
12046.W4122	24	21	Diamond	21	18	31,5	21	13,0	M12x1,75	33,0	6,0	6	125
12046.W4161	30	21	Diamond	21	22	31,5	21	13,0	M16x2,01	33,0	7,5	6	150