

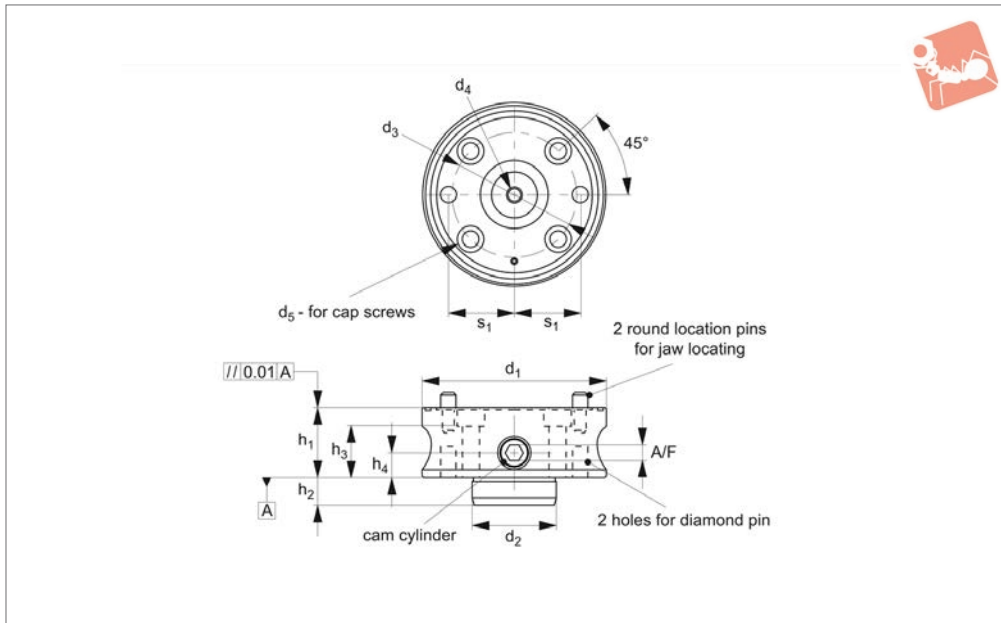

Flexible Form Clamping Base

use with flexible form holding jaws 12056 or 12057

Bore Clamping

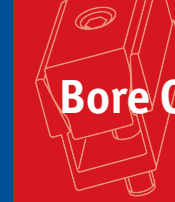

12055.1

BORE CLAMPING

Material

Body: steel.

Technical Notes

For use with jaws part no.s 12056 and 12057 for clamping on the external of a component (jaw no. 12056) or for clam-

ping on internal bore of a component (jaw no. 12057). Order jaws separately.

Supplied with one diamond locating pin to suit.

Can achieve part location repeatability of $\pm 0,03$ and jaw repeatability of $\pm 0,02$. Max.

clamping stroke of 0,3mm diameter.

To prevent damage or deformation, do not tighten the cam cylinder without a holding jaw installed.

Order No.	h_1 ± 0.01	h_2	h_3	Type	Size	d_1	d_2 tol. G6	d_3	d_4	d_5	h_4	Stroke s_1 ± 0.02	A/F	Torque to Nm max.	External form no. 12056 clamping force kN	Internal form no. 12057 clamping force kN	Weight g
12055.W0065	35	27	12	Base	65	65	28	42	M 8x1,25	M 6	12	22	8	15	4,5	4,5	800
12055.W0090	40	30	14	Base	90	90	42	60	M10x1,5	M 8	14	30	8	25	7,0	7,0	1700
12055.W0120	45	33	16	Base	120	120	55	80	M10x1,5	M10	18	43	10	40	10,0	10,0	3500
12055.W0160	50	36	18	Base	160	160	63	110	M12x1,75	M12	24	60	10	40	12,0	10,0	7100

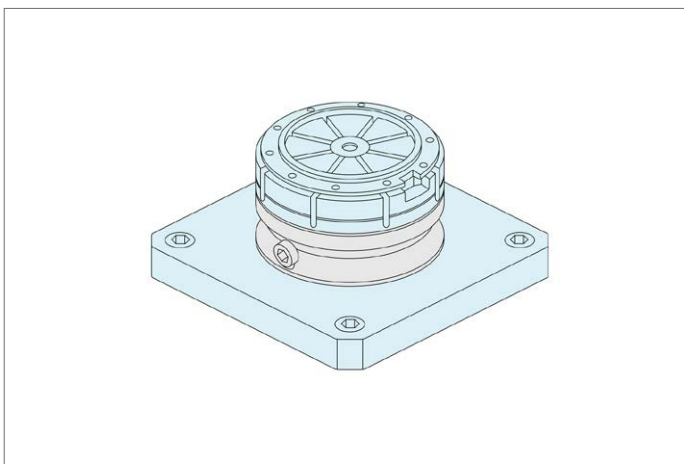



Feature

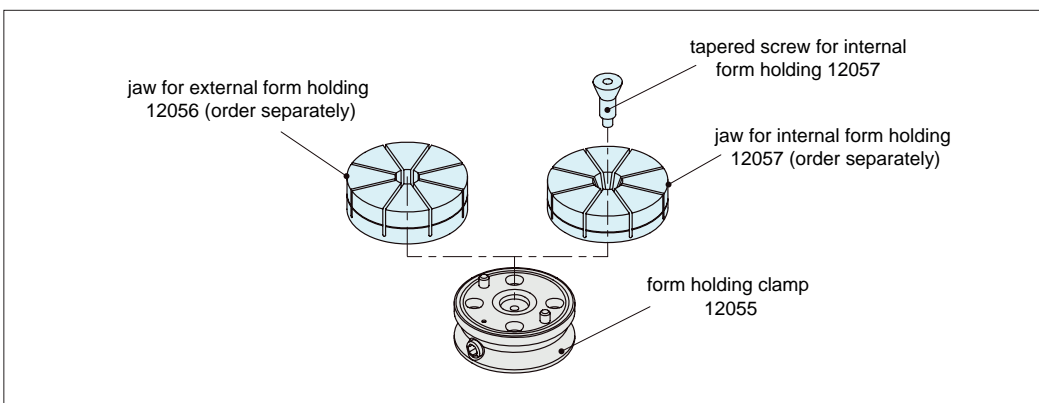

Two optional jaws allow clamping a workpiece both on its external form and internal form.

How to Use

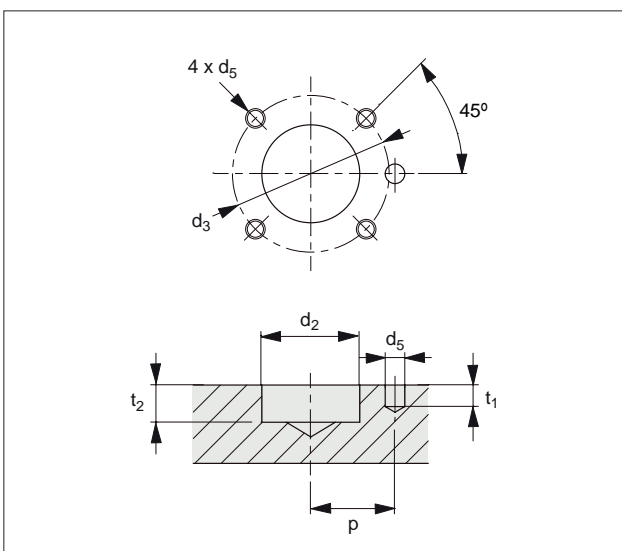

Part Number	d ₂ (H7)	t ₁	d ₅ (G7)	t ₂
12055.W0065	28	13	6	6
12055.W0090	42	15	8	8
12055.W0120	55	19	10	11
12055.W0160	63	25	12	13

Part Number	P (±0,02)	d ₅	d ₃
12055.W0065	22	M 6X1	42
12055.W0090	30	M 8X1,25	60
12055.W0120	43	M10X1,5	80
12055.W0160	60	M12X1,75	110

Installation Instruction

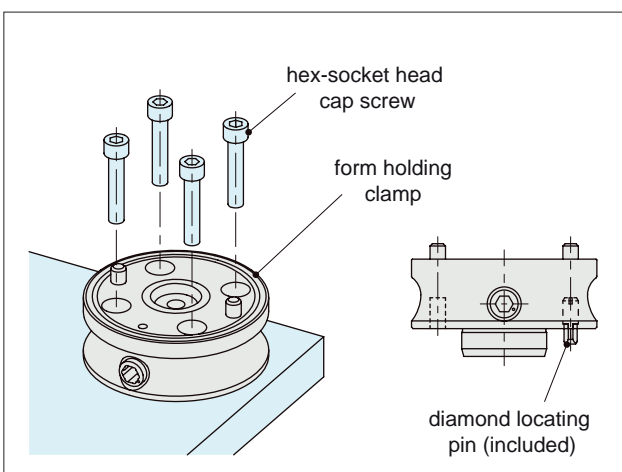

Insert an included diamond locating pin into the body for locating and secure the body to the fixture plate with 4 socket-head cap screws.

Note: use either of the holes for the diamond locating pin for your application.

Dimension of Diamond Locating Pin

Part Number	diameter
12055.W0065	Ø 6h6
12055.W0090	Ø 8h6
12055.W0120	Ø 10h6
12055.W0160	Ø 12h6



Flexible Form Holding Clamp

12055- 12057
Clamping & Height Setting

Versatile holding of complex shaped workpieces on either the external or internal form - quick, secure, versatile.

Single clamping base designed to accept either external form or internal form clamping jaws, fully flexible holding of custom forces.

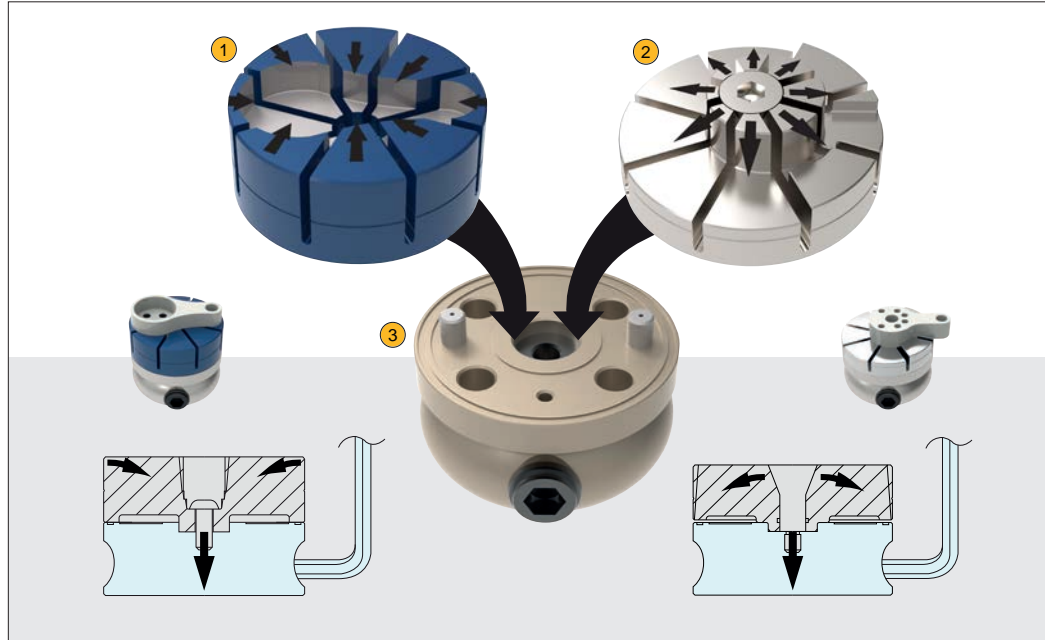

- ① External Form Jaw - 12056
- ② Internal Form Jaw - 12057
- ③ Flexible Form Clamping Base - 12055

BORE CLAMPING

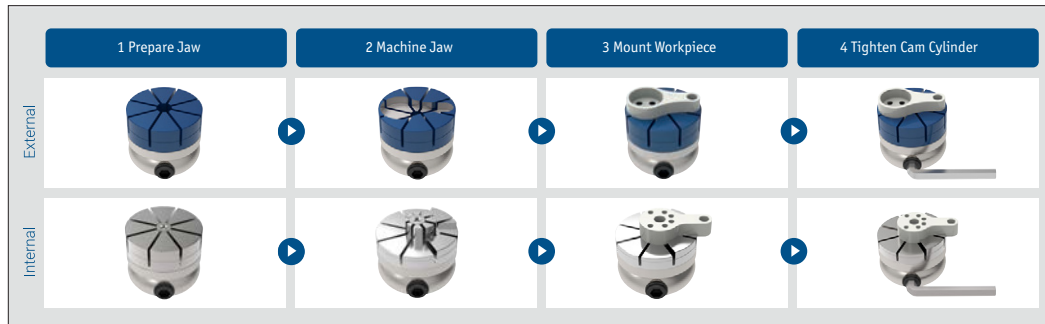

External

Parts 12055, 12056

Internal

Parts 12055, 12057

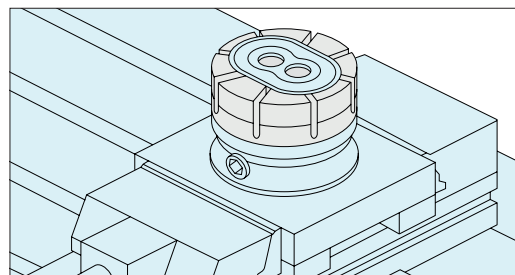
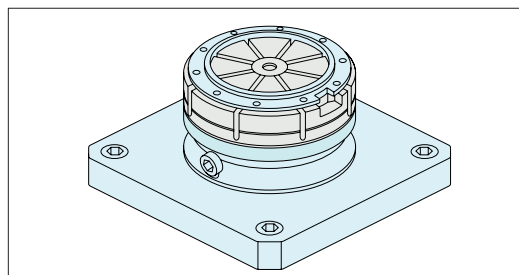

Clamping Low Profile Workpiece
Parts 12055 and 10257. 8 jaw clamping sections distribute clamping force to workpiece for deformation prevention.

Note to control the tightening torque using adequate tools in reference to the data provided by the performance curve.



Fixture for Temporal Job
Parts 12055 and 10256. Can be mounted on the existing vise by attaching the clamp on plate.

ov-W12055.1-A-T-W12057-A-T-Flexible-form-moulding-clamp-rnh - Updated -24-10-2022