

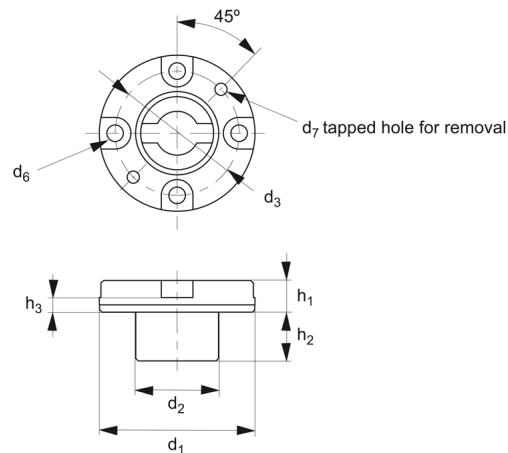

One-Touch Flex Locator Bushings



Pull Back Inserts



12085.3

PULL BACK INSERTS

Material

Stainless steel (AISI 304, 1.4301).

no. 12108. Use plates to avoid any deformation to workpiece during clamping.

Technical Notes

Clamping plates for spiral cam clamp, part

Order No.	Size	d ₁	d ₂	d ₃	d ₄	d ₅	d ₆	d ₇	h ₁	h ₂	h ₃	h ₄	h ₅	Weight g
12085.W0506	6	28	12.5	21.5	13.5	28	3.4	M 3x0,5	5.5	8	2	15	6	20
12085.W0508	8	32	17	25.5	18.0	32	3.4	M 3x0,5	6.5	10	3	18	7	32

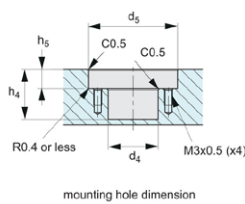

mounting hole dimension

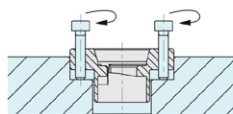

how to remove

insert screws (M3x0.5) into the tapped holes to lift up the bushing for removal

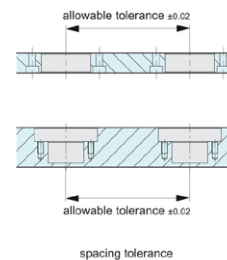

spacing tolerance

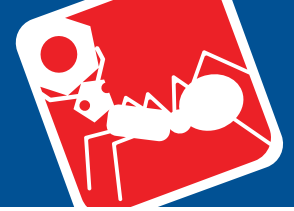

Feature

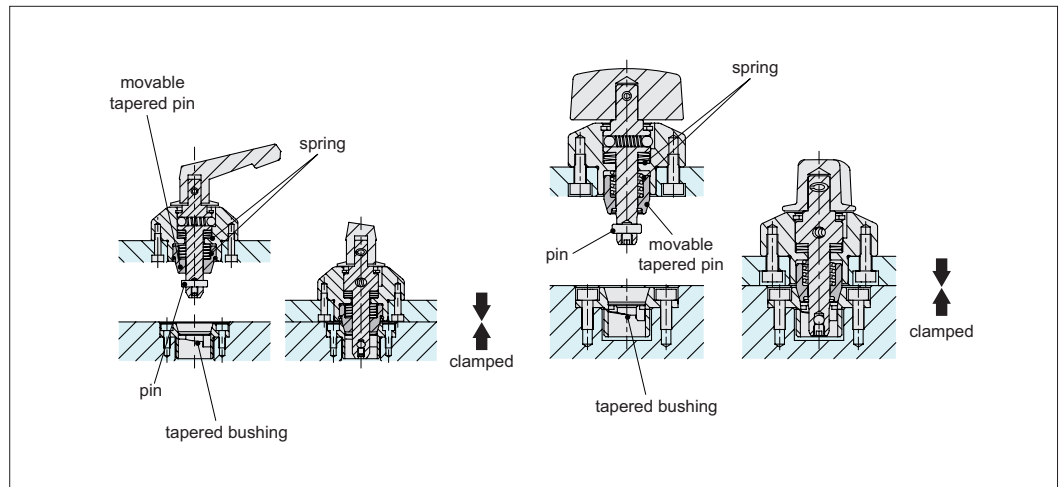

- The plates are located by fitting the tapered pin and the tapered bushing.
- The pin contacts the cam surface inside the bushing, and it compresses the inner spring, then the plates are clamped.

Note: 12085.W0108 does not have locating function.

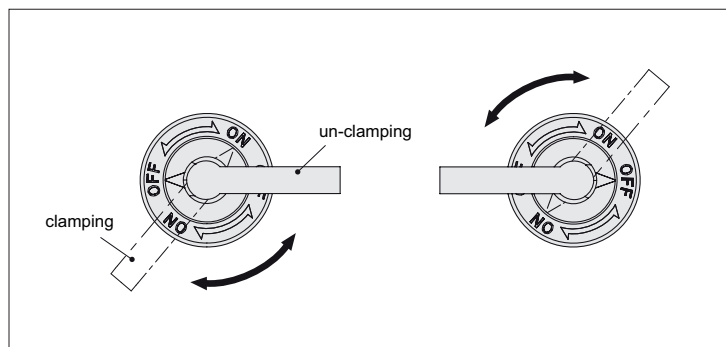

Two clamping and unclamping positions of handle can be chosen for 12085.W0008/W0108

How to Operate

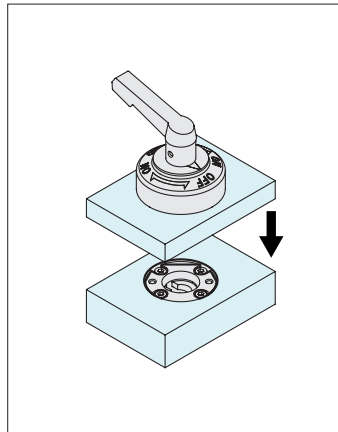

1. Ensure the handle is positioned at 'OFF' mark.

*Follow back these steps for unclamping

*Same operation for knob style.

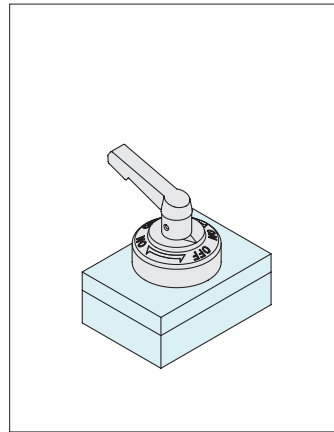

2. Insert the clamper to the bushing.

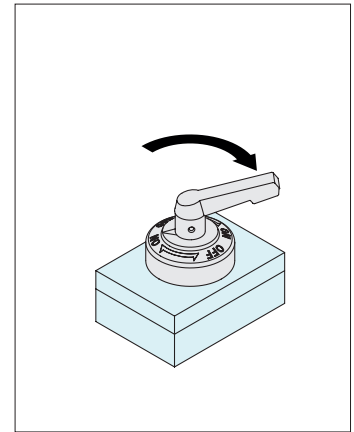

3. Turn the handle to 'ON' mark for clamping.



One Touch Flex Locator Clampers

how to use



12085

Clamping & Height Setting

Tightening Order

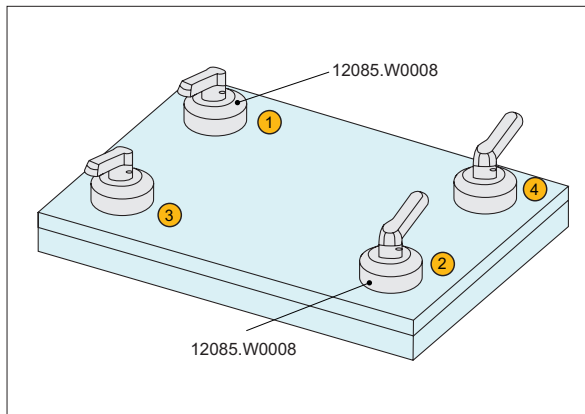

Ensure the handle is positioned at 'OFF' mark and lift down the fixture plate.

Turn the handle and clamp in order of

1 - 2 - 3 - 4

*For unclamping, ensure the handle is positioned at 'OFF' mark and disassemble the fixture plate.

If the handles are not tightened in the correct order, the locating repeatability may exceed 10 μ m.

How to Use

Horizontal Assembly of Fixture Plate

Note: Ensure not to lift the fixture plate up and down with gripping the handle of the clampers.

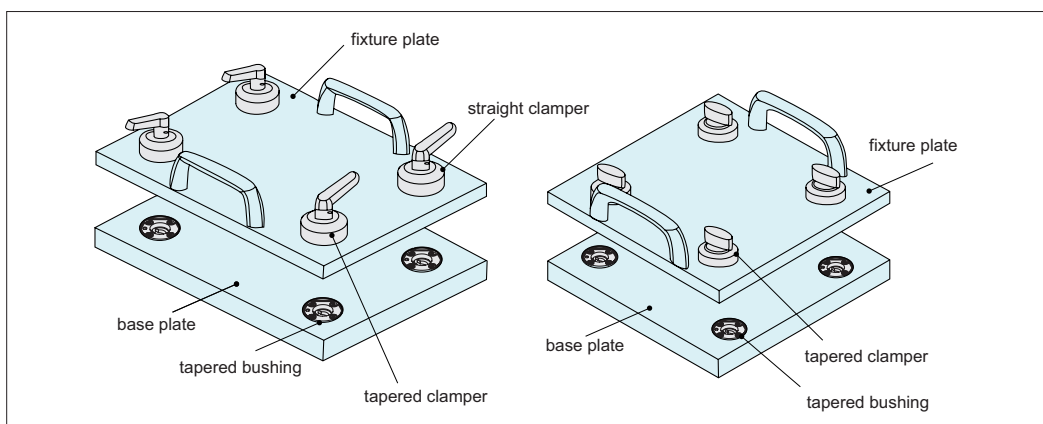

Vertical Assembly of Fixture Plate

Note: Locating repeatability is 10 μ m.

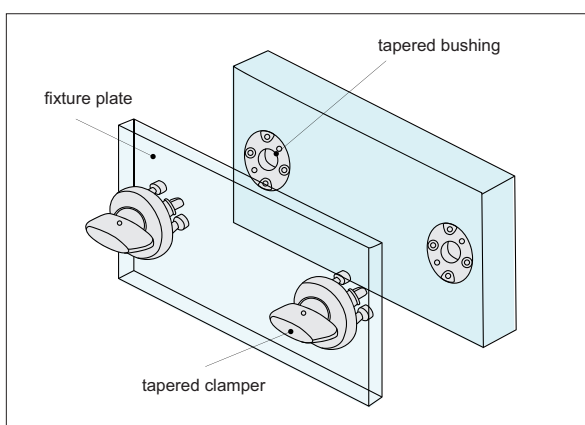

Clamp and Bush Combination		Max. Loading Capacity (N)
12085.W0206	Ø6	120
12085.W0008	Ø8	400
12085.W0108	Ø8	400
12085.W0208	Ø8	400

Note: The maximum load is the entire sum of the load of fixture plates, fixtures and workpieces.

The maximum loading capacity shown is the value when two sets of tapered clamber and tapered bushing are used.