



# Modular Screw Jack Base

adjustable



## Screw Jacks

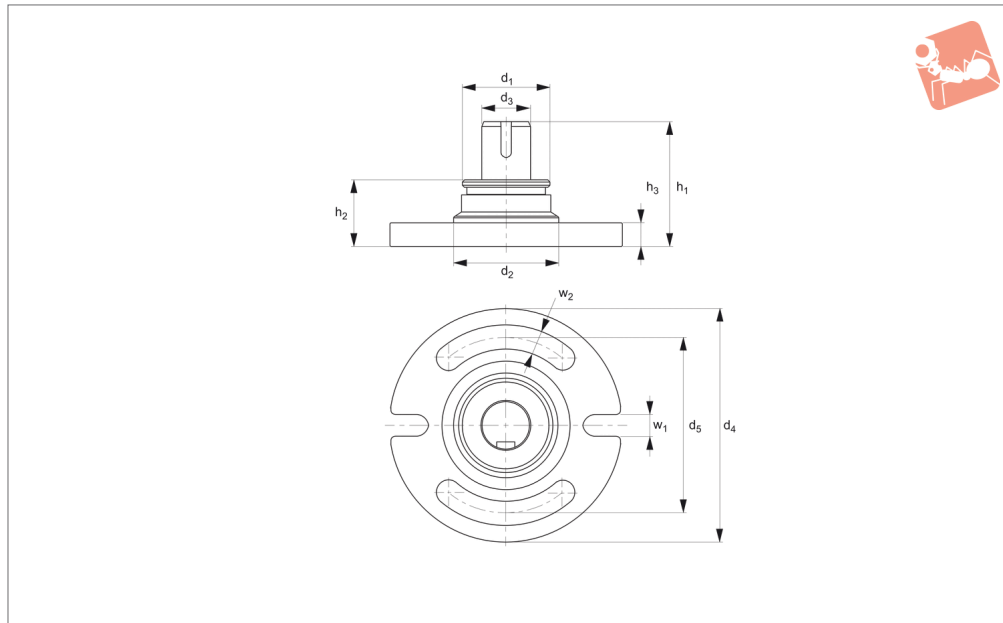

15370.4

SCREW JACKS

### Material

Steel, tempered, burnished.

### Technical Notes

Can be used on T-slots and grid plates. The

individual elements are easily joined together.

Enables easy positioning on a machine table.

Order No.	$h_1$	$h_2$	$h_3$	$w_1$	$w_2$	$d_1$	$d_2$	$d_3$	$d_4$	$d_5$	Weight g
15370.W0356	106	56	20	17	20	M76x3	90	42.5	200	150	5717



With the modular screw jack your production becomes even more flexible and economical. When combined you can achieve a maximum height of 1620mm.

### Benefits

- Maximum height of 1620mm.
- Quick set-up time.

### The Elements

- 1 Bearing pads, 15374.W0075, 15374.W0175, 15374.W0275
- 2 Screw jack, 15370.W0040, 15372.W0023
- 3 Spacer, 15370.W0116, 15370.W0126, 15370.W0135
- 4 Base, 15370.W0236, 15370.W0356, 15370.W0456
- 5 Thread adapter 15374.W0016, 15374.W0020, 15374.W0024

