



Contact-Bolt Extensions

for workpiece support



Supports & Stops

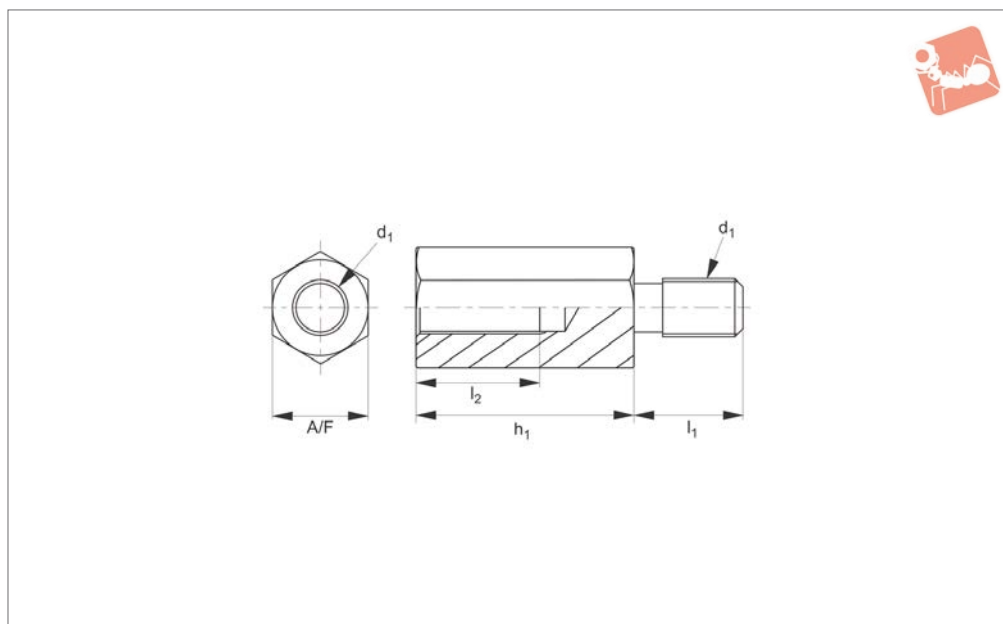

17005.2

SUPPORTS & STOPS

Material

Steel (C45), tempered and black oxide finish.

| Order No. | h_1 | d_1 | l_1 | l_2 | A/F | Weight g |
|-------------|-------|----------|-------|-------|-----|-------------|
| 17005.W0825 | 25 | M 8x1,25 | 13 | 16 | 13 | 25 |
| 17005.W0832 | 32 | M 8x1,25 | 13 | 16 | 13 | 35 |
| 17005.W0840 | 40 | M 8x1,25 | 13 | 16 | 13 | 45 |
| 17005.W1032 | 25 | M10x1,50 | 16 | 20 | 17 | 60 |
| 17005.W1050 | 32 | M10x1,50 | 16 | 20 | 17 | 95 |
| 17005.W1075 | 40 | M10x1,50 | 16 | 20 | 17 | 145 |
| 17005.W1232 | 25 | M12x1,75 | 18 | 20 | 22 | 95 |
| 17005.W1250 | 32 | M12x1,75 | 18 | 20 | 22 | 165 |
| 17005.W1275 | 40 | M12x1,75 | 18 | 20 | 22 | 250 |