

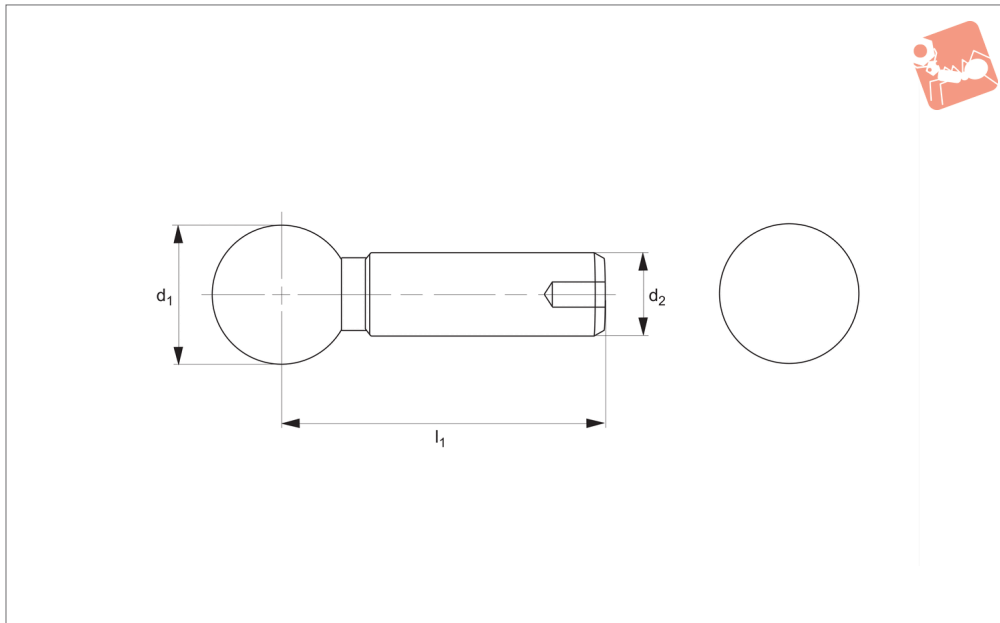

# Tooling Balls - Imperial standard - one piece construction

## Gauging & Inspection



### 20510

GAUGING & INSPECTION

#### Material

Hardened and ground steel (8620 steel).

#### Technical Notes

Concentricity of ball to shank: ,0002 T.I.R.

#### Important Notes

Used as reference points for inspection applications in conjunction with CMMs to accurately measure the work piece.

All dimensions in inches.

Order No.	Type	$d_1$ $\pm 0.0002$	$d_2$ $+0.0000 \mid -0.0004$	$l_1$	Weight oz
20510.W0025I	Slip Fit	0.250	0.125	9/16"	1
20510.W0037I	Slip Fit	0.375	0.188	3/4"	1
20510.W0050I	Slip Fit	0.500	0.250	15/16"	3
20510.W0051I	Slip Fit	0.500	0.250	1-1/2"	3
20510.W0052I	Slip Fit	0.500	0.375	1-1/2"	10