

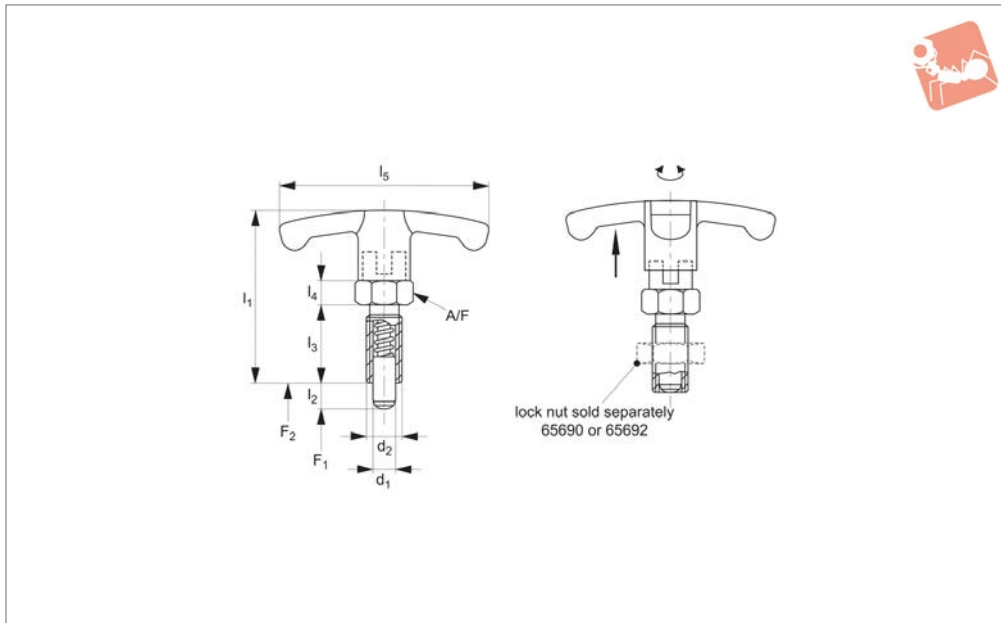

Index Plungers - T-handle Grip

compact - locking

Index Plunger & Pins



32504

INDEX PLUNGER & PINS

Material

Free cutting Steel Type-

Body: free cutting steel, blackened.

Pin: steel, hardened.

Grip: thermplastic PA6, black, dull.

Stainless Steel Type-

Body: stainless steel 1.4305 (AISI 303).

Pin: stainless steel 1.4305 (AISI 303), nickel plated.

Grip: thermosplastic PA6, black, dull.

Technical Notes

T-handle grip makes for improved hand-

ling, especially when operator is using safety gloves etc.

Thread recess on body allows full engagement of thread length. Hexagon collar improves leverage for secure installation.

„Locking“ type- enable pin to be held in retracted/non-projecting position; pull back grip, turn 90° to engage ‚locking‘ on a notched catch.

Lock nuts sold separately. See products 65690 and 65692

Tips

Distance collars no. 32750 can be used to adapt screw length.

Grip non-removable.

Spring loads* = statistical average.

| Order No. | Type | Material | d ₁ | l ₂ | d ₂ | l ₁ | l ₃ | l ₄ | l ₅ | A/F | Spring load F ₁ N ≈ | Spring load F ₂ N ≈ | Weight g |
|--------------------|---------|-----------|----------------|----------------|----------------|----------------|----------------|----------------|----------------|-----|--------------------------------------|--------------------------------------|-------------|
| 32504.W0832 | Locking | Steel | 6 | 6 | M12x1,5 | 48 | 22 | 6 | 54 | 14 | 6.5 | 19 | 33.0 |
| 32504.W0834 | Locking | Steel | 6 | 9 | M12x1,5 | 48 | 22 | 6 | 54 | 14 | 6.0 | 25 | 34.0 |
| 32504.W0836 | Locking | Steel | 8 | 8 | M16x1,5 | 59 | 26 | 8 | 59 | 17 | 8.5 | 26 | 68.0 |
| 32504.W0838 | Locking | Steel | 8 | 12 | M16x1,5 | 59 | 26 | 8 | 59 | 17 | 8.5 | 28 | 71.0 |
| 32504.W0840 | Locking | Steel | 10 | 12 | M16x1,5 | 59 | 26 | 8 | 59 | 17 | 9.5 | 38 | 72.0 |
| 32504.W0842 | Locking | Steel | 12 | 15 | M20x1,5 | 68 | 33 | 10 | 59 | 22 | 11.5 | 40 | 127.0 |
| 32504.W0932 | Locking | Stainless | 6 | 6 | M12x1,5 | 48 | 22 | 6 | 54 | 14 | 6.5 | 19 | 33.0 |
| 32504.W0934 | Locking | Stainless | 6 | 9 | M12x1,5 | 48 | 22 | 6 | 54 | 14 | 6.0 | 25 | 34.0 |
| 32504.W0936 | Locking | Stainless | 8 | 8 | M16x1,5 | 59 | 26 | 8 | 59 | 17 | 8.5 | 26 | 68.0 |
| 32504.W0938 | Locking | Stainless | 8 | 12 | M16x1,5 | 59 | 26 | 8 | 59 | 17 | 8.5 | 28 | 71.0 |
| 32504.W0940 | Locking | Stainless | 10 | 12 | M16x1,5 | 59 | 26 | 8 | 59 | 17 | 9.5 | 38 | 72.0 |
| 32504.W0942 | Locking | Stainless | 12 | 15 | M20x1,5 | 68 | 33 | 10 | 59 | 22 | 11.5 | 40 | 127.0 |



A Wide Selection of Solutions

Applications

- Locating and positioning.
- Indexing.
- Securing.
- Positive locking.
- Rapid adjustment of all kinds of tables, platforms and fixtures.
- Machine and fixture design.
- OEM products.
- Sports equipment.
- Medical aides (wheelchairs etc.).
- Aerospace.
- Machine cabinets.

Materials



Steel with plastic grip



Stainless with plastic grip



Stainless body and grip

Locking or Non Locking



Locking (park)



Non locking (spring back)



Push pull

Handling and Actuation Methods



Standard grip



Lever grip



T-handle



Pull ring



Threaded for bespoke handle

Mounting Options



Fine threaded (standard)



Coarse thread



Flange mount



Thin wall mount



Weldable

Additional Technical Notes

- Unless otherwise stated, grips on index plungers are not removable.
- Many of the pins on index plungers are toleranced to either the pin or the hole. Please refer to the specific product table.
- Index plungers are not recommended for shear load applications.

| | Pin Tol. | Hole Tol. |
|---|----------------|----------------|
| ① | h_9 | +0,03 +0,08 |
| ② | -0,02 -0,04 | H_7 |

Spring Loads

- s** Stroke, or movement of plunger's pin.
- f₁** The force required in Newtons (N) to overcome the static strength of the spring and achieve initial movement of the plunger's pin.
- f₂** The force required in Newtons (N) to fully compress the spring until the pin is fully depressed against the plunger's body.

