

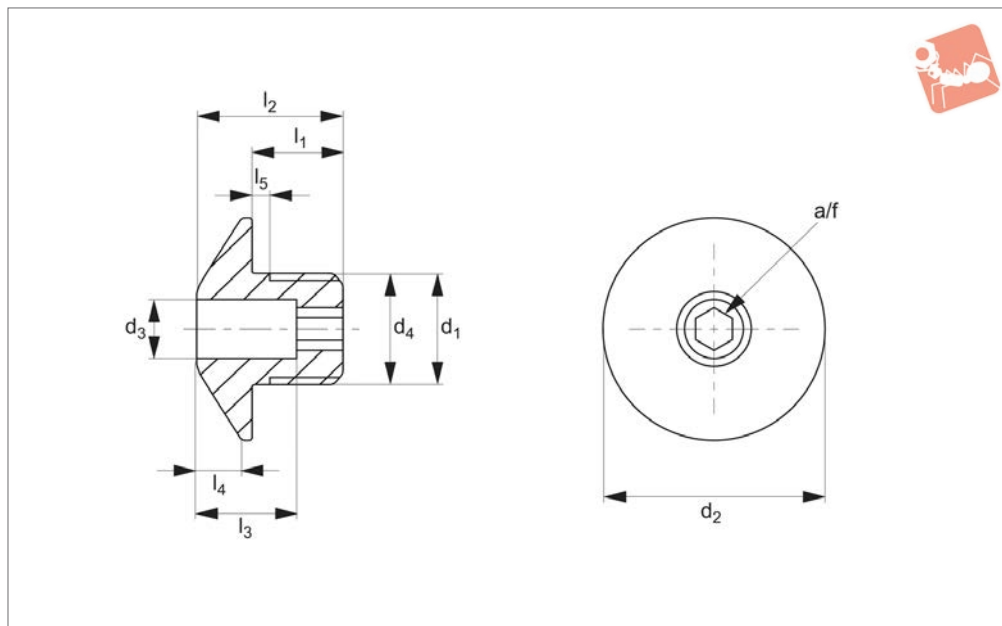

# Locating Bushes - Hardened for index plungers

## Index Plunger & Pins



**32753**

INDEX PLUNGER & PINS

### Material

Body:

Steel: Hardened, blackened

Stainless: Stainless steel hardened

### Technical Notes

For use with our wide range of index bolts

and plungers. Provide a durable location bush for index plunger pins of diameter  $d_3$ , refer to individual index plunger production information for matching pin diameters.

### Tips

Low wear option due to hardened material.

Order No.	Type	$d_1$	$d_2$	$d_3$ +0,1	$d_4$ -0,05	$l_1$	$l_2$	$l_3$	$l_4$	$l_5$ +0,5	For pin	A/F	Weight g
<b>32753.W0464</b>	Steel	M12x1,5	24	4.2	12	10	16	11	5	1.5	4	4	17
<b>32753.W0465</b>	Steel	M12x1,5	24	5.2	12	10	16	11	5	1.5	5	4	16
<b>32753.W0466</b>	Steel	M12x1,5	24	6.2	12	10	16	11	5	1.5	6	4	16
<b>32753.W0468</b>	Steel	M16x1,5	32	8.2	16	12	20	13	7	1.5	8	6	36
<b>32753.W0470</b>	Steel	M16x1,5	32	10.2	16	12	20	13	7	1.5	10	6	33
<b>32753.W0472</b>	Steel	M16x1,5	32	12.2	16	12	20	13	7	1.5	12	6	33
<b>32753.W0474</b>	Stainless	M12x1,5	24	4.2	12	10	16	11	5	1.5	4	4	17
<b>32753.W0475</b>	Stainless	M12x1,5	24	5.2	12	10	16	11	5	1.5	5	4	16
<b>32753.W0476</b>	Stainless	M12x1,5	24	6.2	12	10	16	11	5	1.5	6	4	16
<b>32753.W0478</b>	Stainless	M16x1,5	32	8.2	16	12	20	13	7	1.5	8	6	36
<b>32753.W0480</b>	Stainless	M16x1,5	32	10.2	16	12	20	13	7	1.5	10	6	33
<b>32753.W0482</b>	Stainless	M16x1,5	32	12.2	16	12	20	13	7	1.5	12	6	33