



One-Touch Fastener - Ball Locking

quarter turn lock - t-handle grip - plastic



One Touch Fasteners

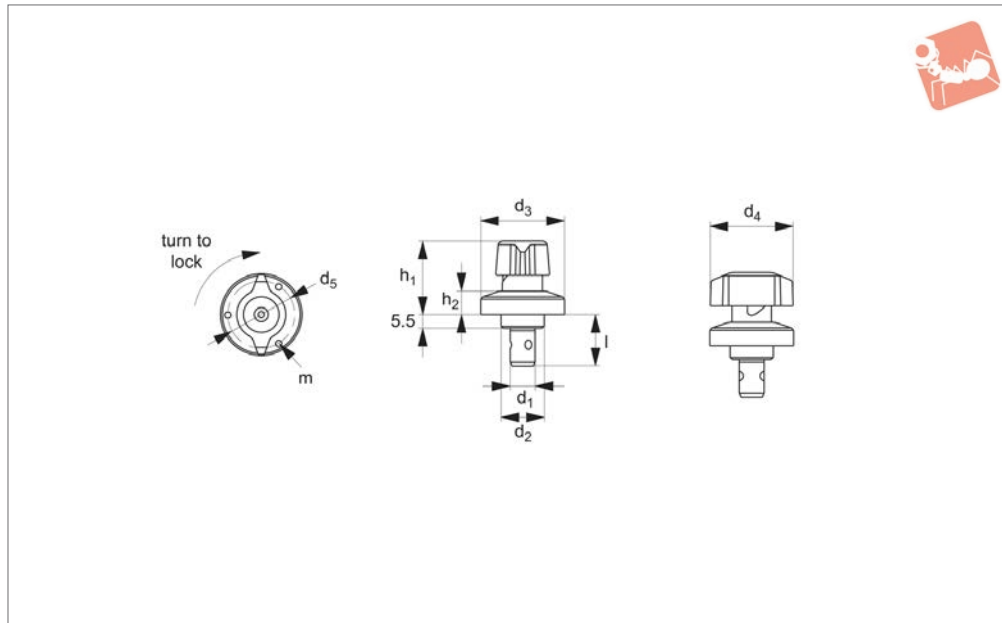

33916

ONE TOUCH FASTENERS

Material

Body & Shank: steel, nickel plated.
Knob: plastic, black.
Ball & Spring: Titanium G5.

Technical Notes

One-touch fasteners are the ideal solution for applications requiring rapid and recurring change over of tooling or set ups. Use in applications as diverse as bottling processes, machine covers, changing of cogs and drive belts. One-touch fasteners

provide a quick, simple and secure change over solution - no time wasted in unfastening screws or other permanent fixings, and no opportunity for lost fixings in your machinery.

Important Notes

Suitable for panels/enclosures of 6 to 20mm thickness.
For locating bushes see part no. 33920.
Quarter turn handle, easy-to-read on/off position of the one-touch fastener for

increased security.
Temperature resistant to 180°C.

Actuation:

- Turn handle to off position: locking balls retract and are held in retracted position via notched catch.
- Pass fastener through panel.
- Turn handle 45° to on position: locking balls engage with locating bush, panels are securely fastened.

| Order No. | For single panel thickness | d_1 -0.05 -0.10 | d_2 tol. h9 | d_3 | d_4 | d_5 | h_1 | h_2 | l | m | Clamping force N | Weight g |
|-------------|----------------------------|----------------------|------------------|-------|-------|-------|-------|-------|------|---------|---------------------|-------------|
| 33916.W1006 | 6-10 | 6 | 14 | 25 | 25 | 21 | 24.5 | 6.5 | 19.5 | M 2x0,4 | 30 | 40 |
| 33916.W1410 | 6-14 | 10 | 18 | 34 | 34 | 28 | 31.0 | 10.0 | 21.5 | M 3x0,5 | 50 | 95 |
| 33916.W2010 | 12-20 | 10 | 18 | 34 | 34 | 28 | 31.0 | 10.0 | 27.5 | M 3x0,5 | 50 | 100 |

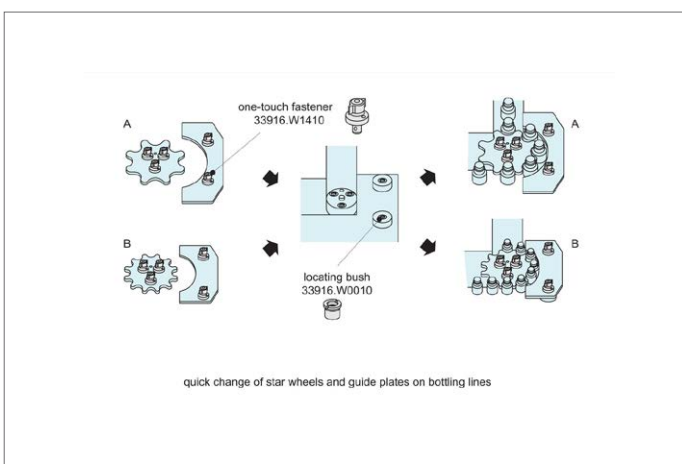



One-Touch Fasteners - Alternatives to Screws

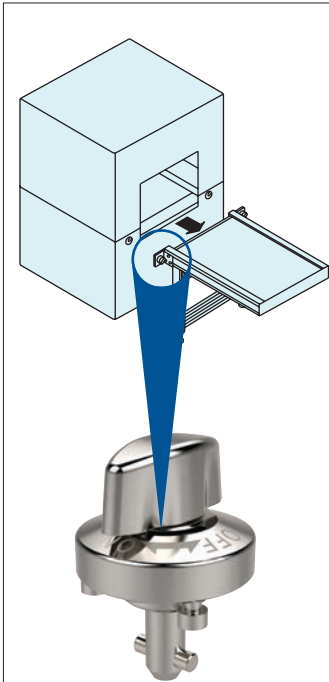

Installation and removal of conveyor sub assemblies

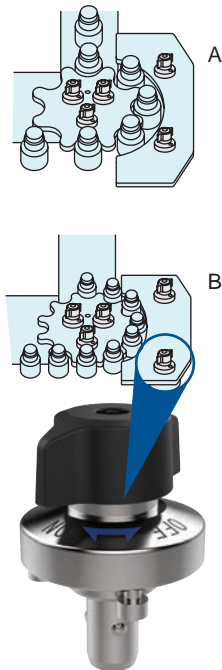

Changes of star wheels and guide plates

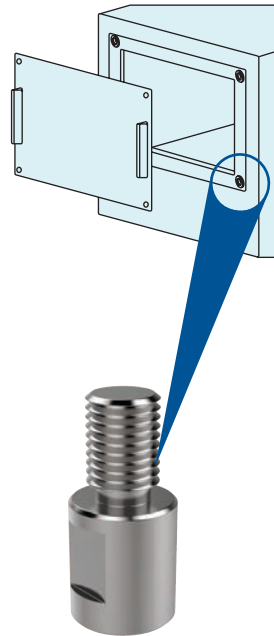

Installation and removal of panels or covers

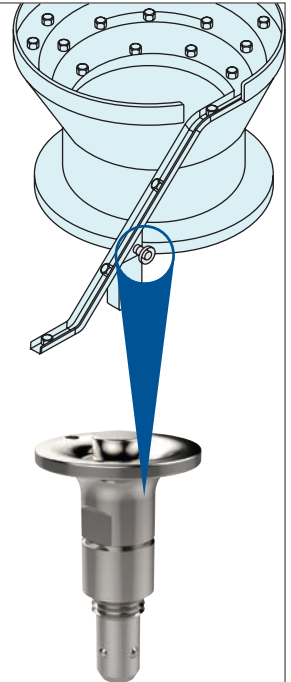

Change of shoots or production guides

Easy & Secure! For Quick Changeover with No Tools!





One-Touch Change Over

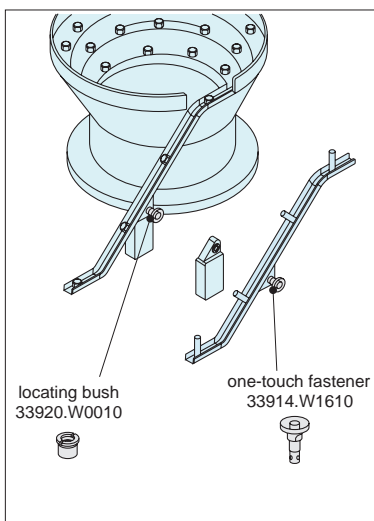
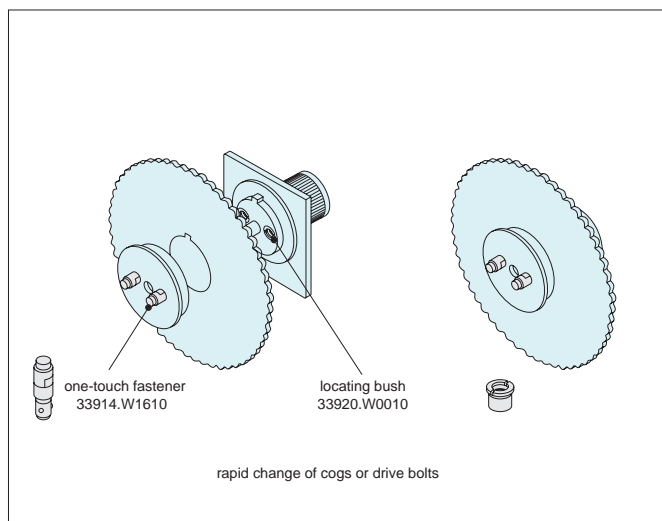

Installation and Removal of Rotary Blades and Changes of Shooters

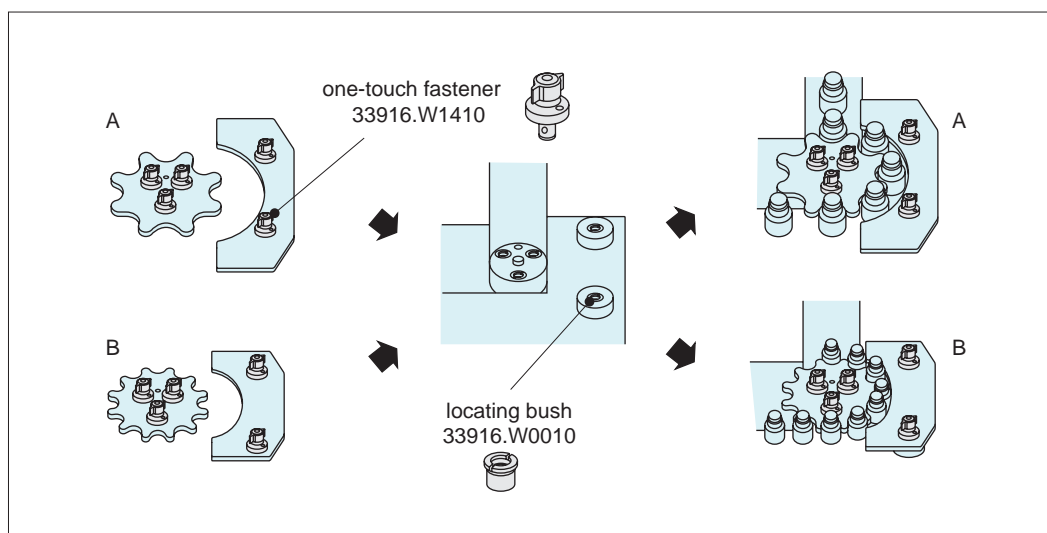

Changes of Star Wheels and Guide Plates

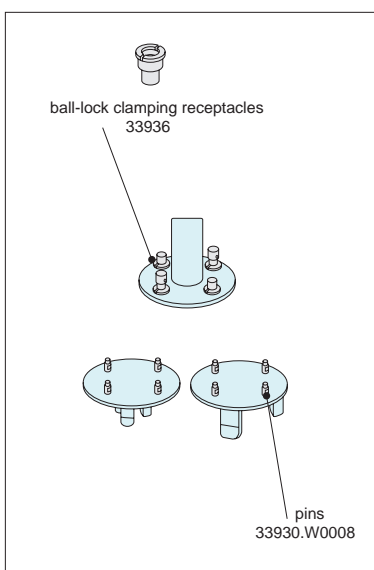
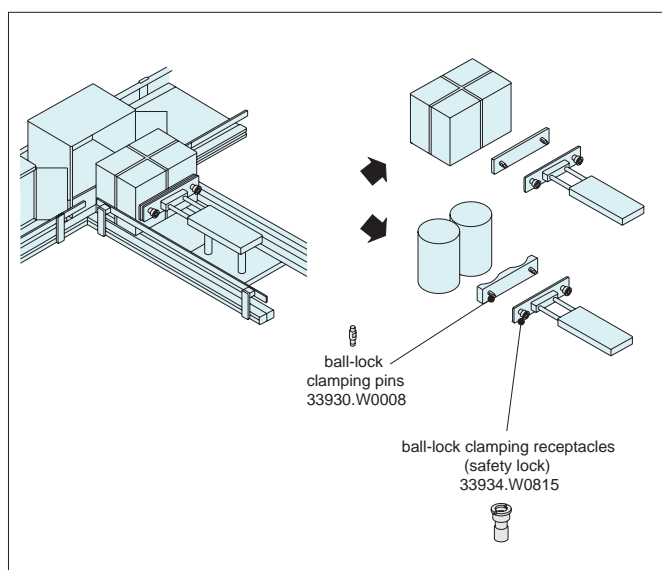

Changes of Pusher and Changes of Chuck Handling Machines



Operating Instructions

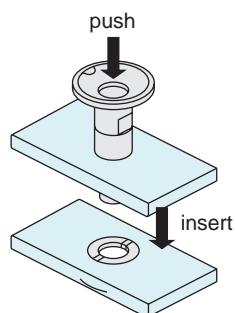

depress button,
align pin and insert

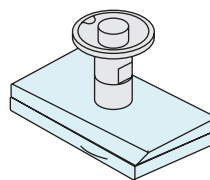

when the button is released,
clamping is complete

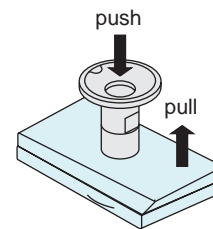

depress button to release,
and pull out

Operating Principle

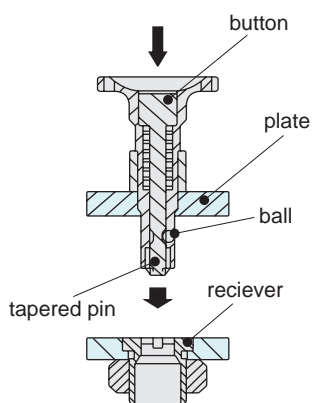

activation button
press = unlock
release = lock

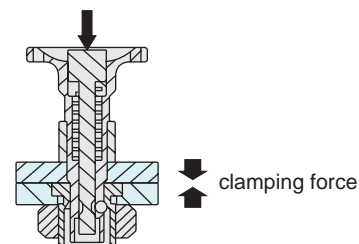

during clamping the tapered pin pushes out the ball bearing, into the recessed holes of the reciever, securely clamping the two surfaces together



One-Touch Fastener - Ball Locking

quarter turn - installation instructions

33916 - 33918
Positioning Elements

Operating Instructions

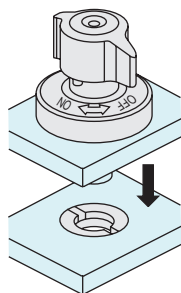

ensure that the knob is positioned at the "OFF" mark

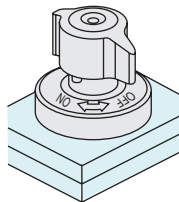

align pin and receiver

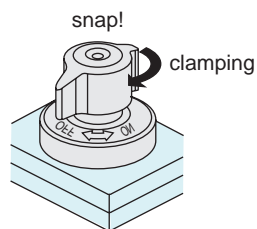

turn the knob to the "ON" mark to clamp

Easy Status Identification

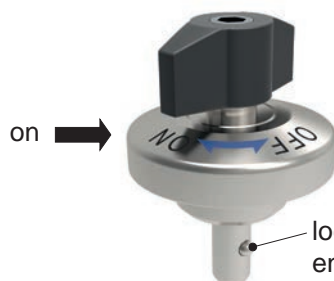

At ON position

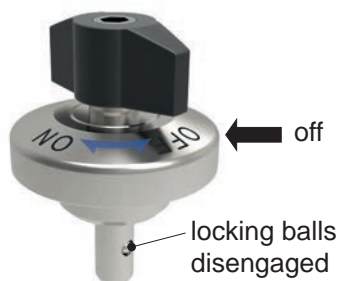

At OFF position

Installation Dimensions for 33916-33918

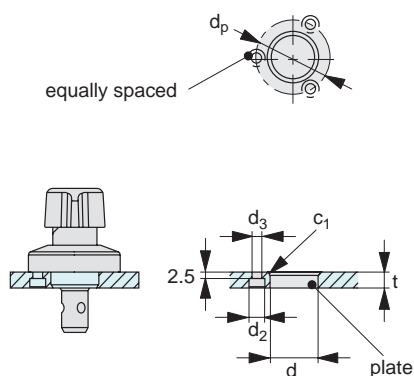

Installation for 6mm panels

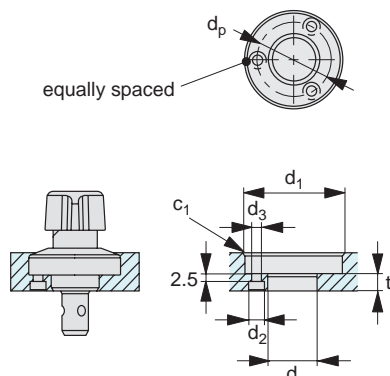

Installation for 6mm to 20mm panels

| 33916/17/18 | Single panel thickness $t \pm 0,2$ | $d_6 +0,1$ $+0,0$ | d_7 | d_8 | d_9 | d_5 |
|-------------|---------------------------------------|----------------------|-------|-------|-------|-------|
| .W1006 | 6 | 14 | - | 4,4 | 2,4 | 21 |
| .W1006 | 6 to 10 | 14 | 26 | 4,4 | 2,4 | 21 |
| .W1410 | 6 | 18 | - | 6,5 | 3,4 | 28 |
| .W1410 | 6 to 14 | 18 | 35 | 6,5 | 3,4 | 28 |
| .W2010 | 12 | 18 | - | 6,5 | 3,4 | 28 |
| .W2010 | 12 to 20 | 18 | 35 | 6,5 | 3,4 | 28 |

Note: if two fasteners used, allow spacing tolerance of $\pm 0,1\text{mm}$