



One-Touch Fastener - Ball Clamping

pin - for one touch fasteners 33924 to 33929



One Touch Fasteners

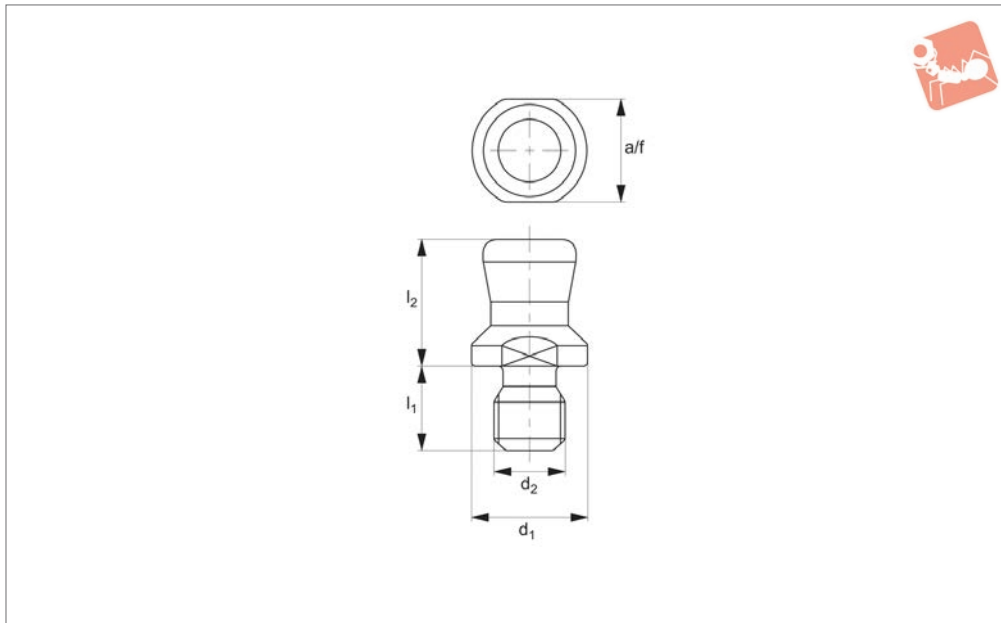

33923

ONE TOUCH FASTENERS

Material

Body: stainless steel, SUS630

Technical Notes

One-touch fasteners are the ideal solution for applications requiring rapid and recurring change over of tooling or set ups. Use in applications as diverse as bottling processes, machine covers, changing of

cogs and drive belts. One-touch fasteners provide a quick, simple and secure change over solution - no time wasted in unfastening screws or other permanent fixings, and no opportunity for lost fixings in your machinery.

Important Notes

Pin 33923 for use in conjunction with one-

touch fasteners, ball clamping; 33924 through 33929. Pins for installation in material to minimum depth 6,0mm or greater.

Recess of 0,5mm +0,1 is recommended to ensure full surface contact and achieve maximum strength of pin.

Order No.	d_1 -0.05 -0.10	d_2	l_1	l_2	A/F	Weight g
33923.W0006	6	M 4x0,7	5.8	7.6	5	2
33923.W0008	8	M 5x0,8	5.8	8.7	7	3



One-Touch Fasteners - Alternatives to Screws

ONE TOUCH FASTENERS

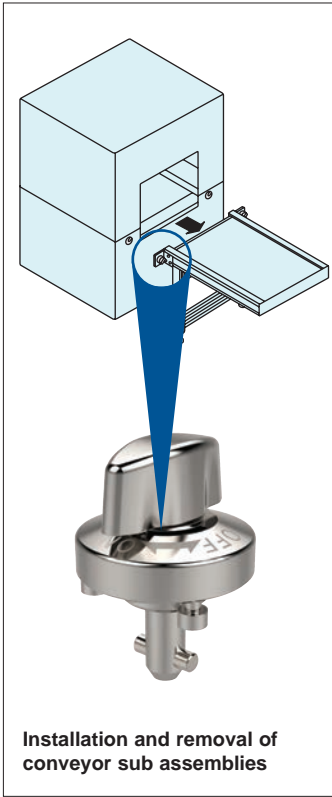

Installation and removal of conveyor sub assemblies

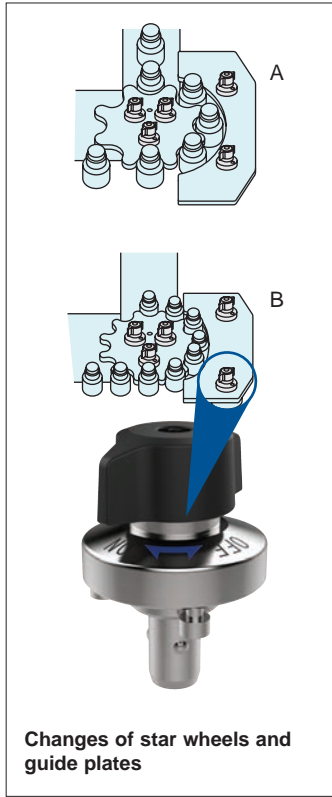

Changes of star wheels and guide plates

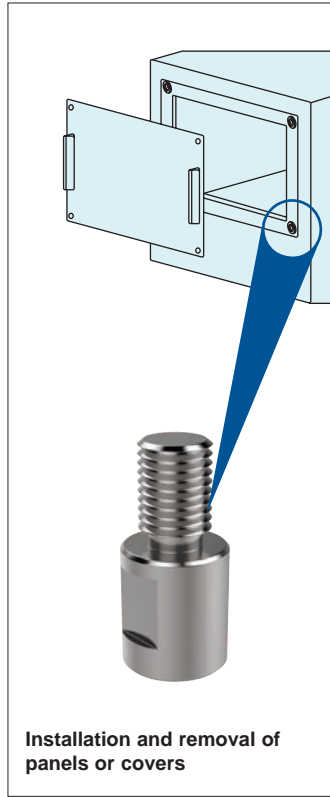

Installation and removal of panels or covers

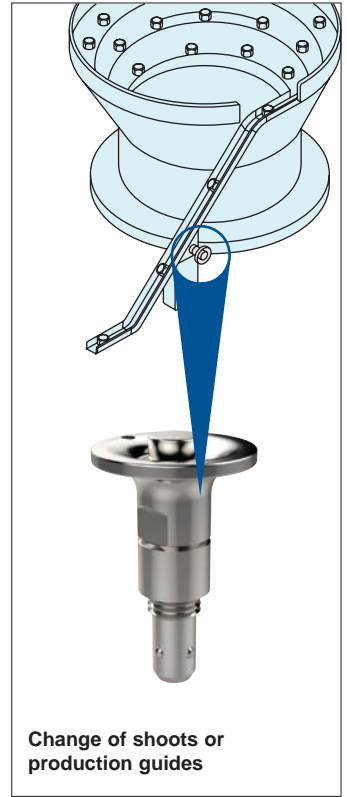

Change of shoots or production guides

Easy & Secure! For Quick Changeover with No Tools!





One-Touch Change Over

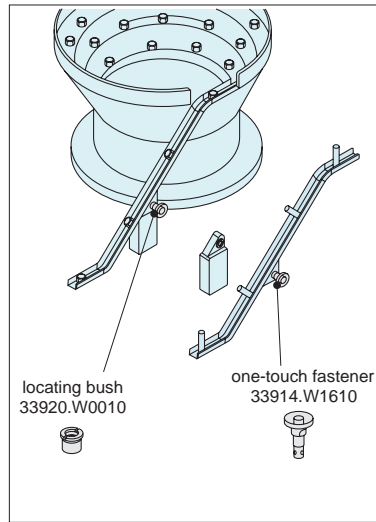
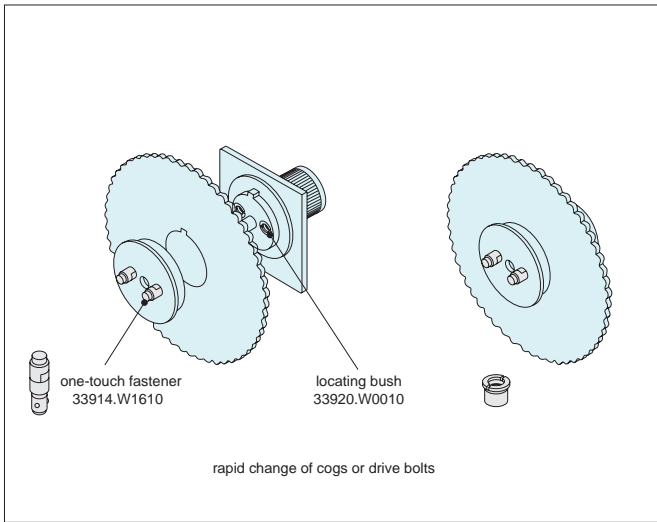

Installation and Removal of Rotary Blades and Changes of Shooters

ONE TOUCH FASTENERS

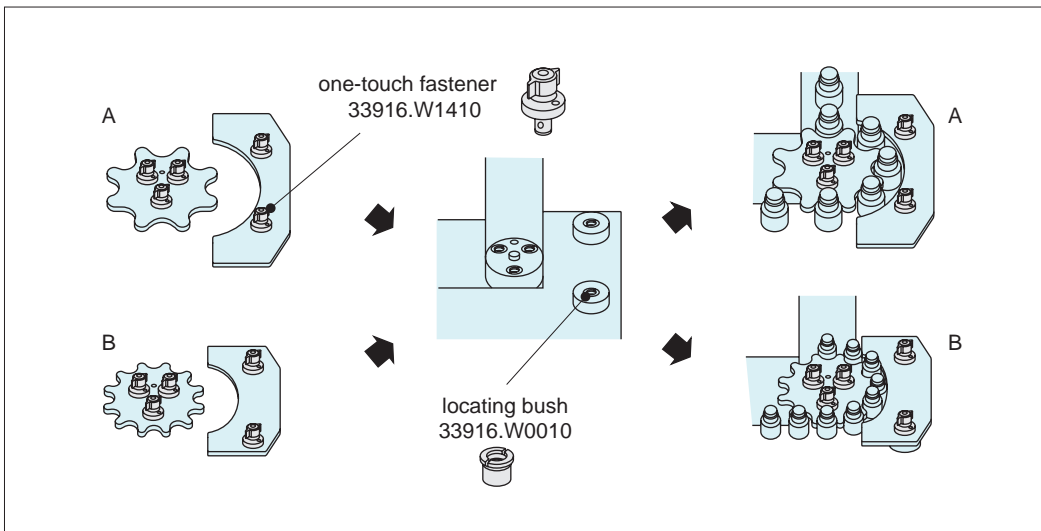

Changes of Star Wheels and Guide Plates

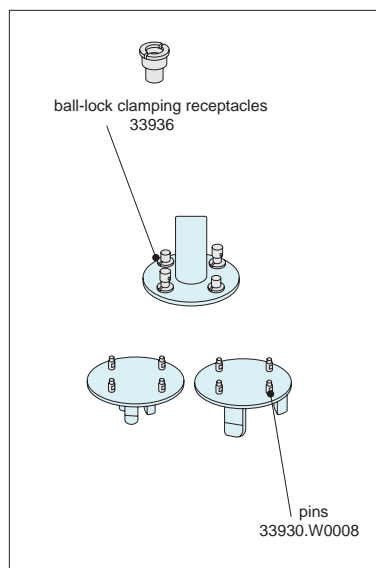
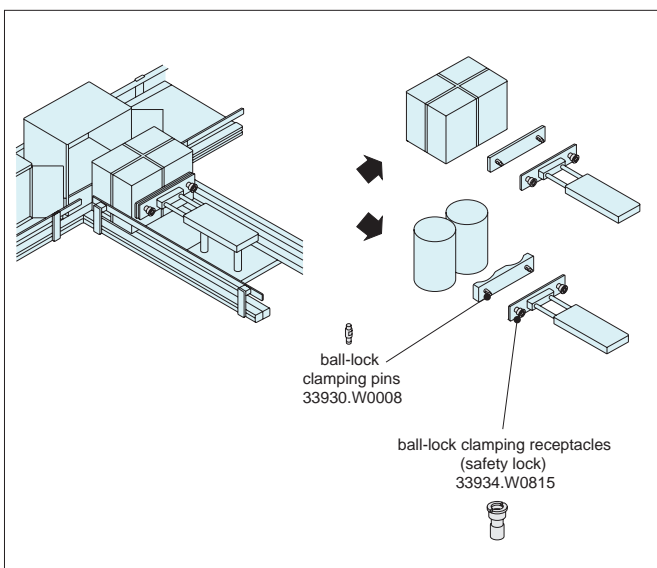

Changes of Pusher and Changes of Chuck Handling Machines

ov-W33910-A-T-W33956-A-T-one-touch-fasteners-b-rmh - Updated - 27-10-2022



Installation Dimensions

Standard Mount

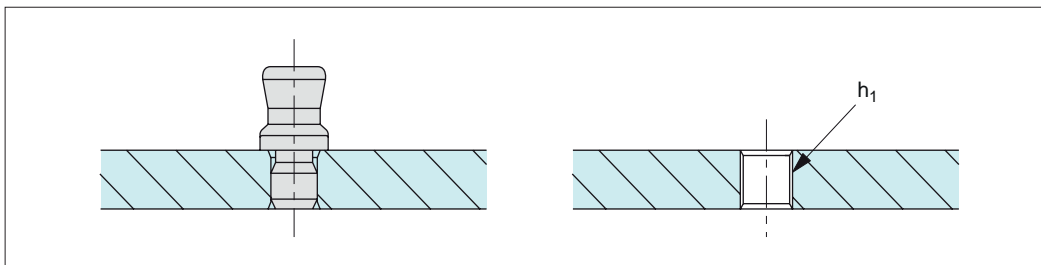

Recessed Mount

Prepare a tapped hole according to the thread of the pin. Ensure a counter bore is machined to depth h_2 to complete pin installation.

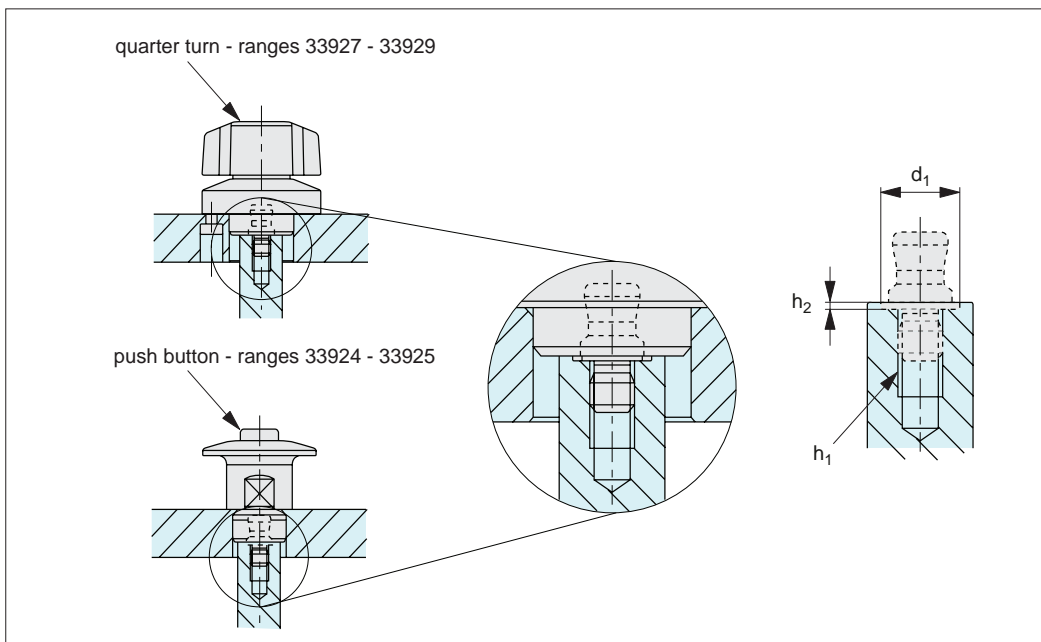

	Mounting type	h_1	h_2 +0,1	d_3
33923.W0006	Standard	M4x0,7	-	-
33923.W0006	Recessed	M4x0,7	0,5	7
33923.W0008	Standard	M5x0,8	-	-
33923.W0008	Recessed	M5x0,8	0,5	9