

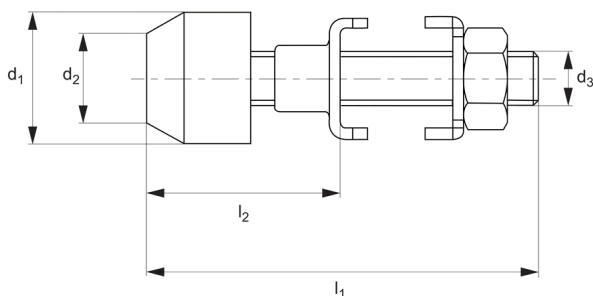

## ESD Clamping Screws for open arm toggle clamps



45060.3

ESD TOGGLE CLAMPS

### Material

Steel, zinc plated and tempered steel.  
Tensile strength class 8.8. With nut and  
removable rubber pad.

### Technical Notes

**The ESD (electrostatically sensitive  
devices) clamping screw is non-  
insulating. It must not be used in areas**

**where open voltages are used.**

Order No.	Size	Type	Washer size	$l_1$	$l_2$	$d_1$	$d_2$	Screw DIN 933 $d_3 \times l_3$	Weight g
45060.W0300	0	Steel	0	32	13-20	11.0	7	M 4x25	5
45060.W0301	1	Steel	1	38	17-24	12.5	8	M 5x30	10
45060.W0302	2	Steel	2	45	18-28	15.0	10	M 6x35	22
45060.W0303	3	Steel	3	58	22-34	15.0	10	M 8x45	40



The ESD toggle clamps have been specially developed for working with electrostatically sensitive components, assemblies or devices in ESD protection zones (EPA) in accordance with the standard DIN EN 61340-5-1. All our toggle clamps have been tested and certified by an independent expert regarding leakage resistance, discharge time and surface tension.

### Features

- Leakage resistance according to DIN IEC / TR 61340-5-2 between  $10^{04}$  and  $10^{09}$  Ohm.
- Discharge time according to DIN IEC / TR 61340-5-2  $< 2$  seconds.
- Surface tension (electric field strength) according to DIN EN 61340-5-1  $< 100$  Volt.

