

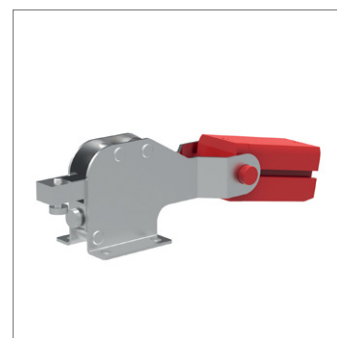

Combi Pneumatic Toggle Clamp with horizontal cylinder attachment

Pneumatic Toggle Clamps

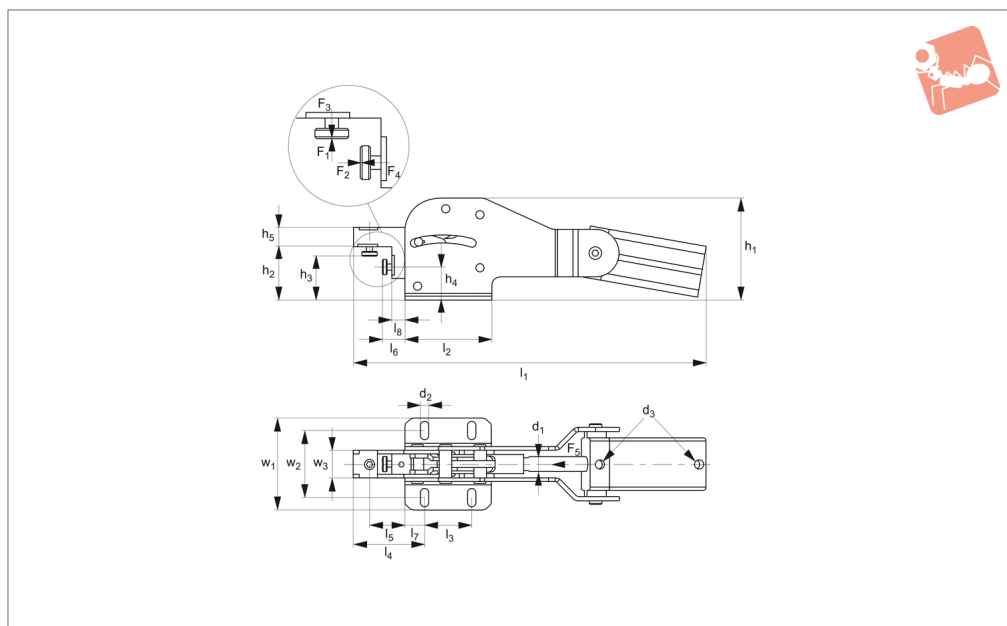

47030

PNEUMATIC TOGGLE CLAMPS

Material

Body: steel, zinc plated and galvanised.
Bushes: case hardened and greased.
Rivets: stainless steel.
Complete with tempered, galvanized clamping screw.

Technical Notes

Bearings are pre-lubricated.
Clamp ready for installation and consists

of:

- vertical toggle clamp no. 40000 (without handle)
 - FESTO-pneumatic cylinder, double acting.
- With magnetic piston for limit position query.
 F_3 and F_4 = max. clamping force at 6 bar.
 V_n = air consumption per double stroke in dm^3 at 6 bar.

Suitable proximity switches for end-position monitoring are available using order 45001. 0.3m PUR cable with M8 connector and rotatable knurled nuts.
Switching function: NOC. Output: PNP.

Tips

The console is self-supporting and must be clear of other surfaces. There is a valve for controlling the speed of operation.

Order No.	Size	F_1/F_2 kN	F_3 kN	F_4 kN	F_5 kN	Piston dia.	d_1	d_2	d_3	h_1	h_2	h_3 min.	h_3 max.	h_4	Weight g
47030.W0001	1	1	0.3	0.1	0.3	25	5.5	10	M 5	68	36.0	25	32	22	770
47030.W0002	2	2	0.5	0.3	0.4	32	6.5	12	G1/8	88	46.0	30	40	28	1450
47030.W0003	3	3	0.7	0.4	0.8	40	8.5	16	G1/8	106	55.5	40	50	34	3050

Order No.	h_5	l_1	l_2	l_3	l_4	l_5	l_6 min.	l_6 max.	l_7	l_8	V_n dm^3	w_1	w_2	w_3
47030.W0001	12	225	55	40	33	15	5	10	7.5	0.5	0.3	53	34,5-39,5	17.0
47030.W0002	16	305	75	50	56	32	10	20	12.5	10.5	0.4	75	55.0	19.5
47030.W0003	20	370	90	50	74	37	20	30	20.0	14.0	0.8	96	70.0	29.0