

Pull Handles

stainless steel

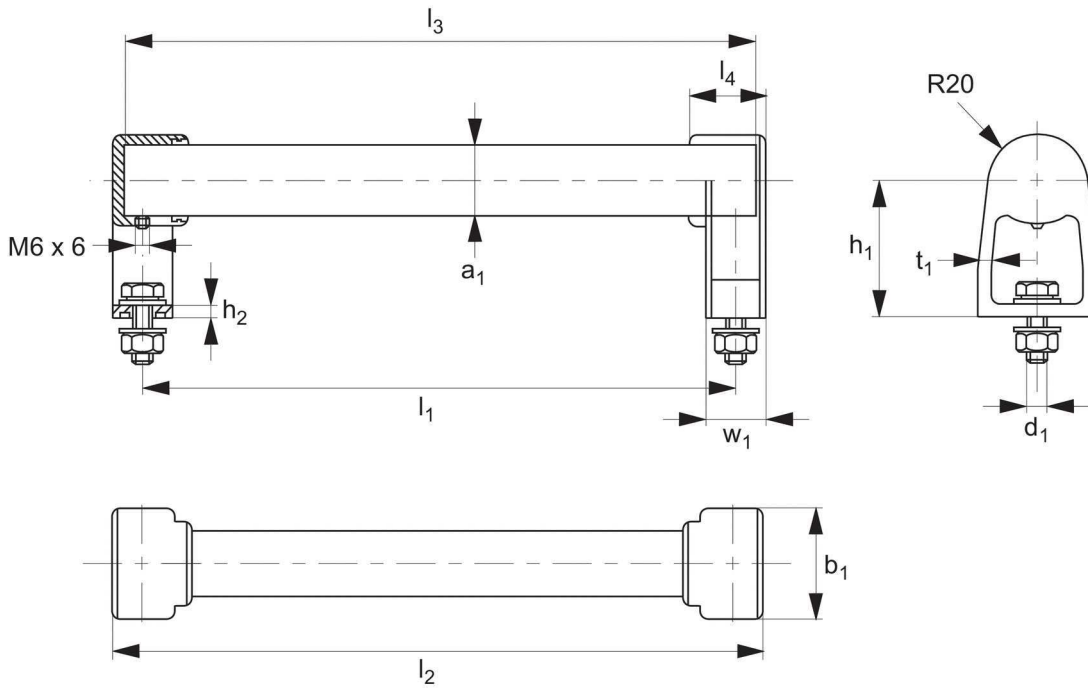

78800



Material

Handle shank: cast stainless steel, G-X7 CrNiMoNb 18 10. Glass blasted, satin matt finish.

Connecting tube: stainless steel, X5 CrNi189, 1.4301. Ground and blasted.

Packing ring: food quality silicon rubber.

Connection tubes finish grounded and brushed. Handle shanks glass blasted and electro polished with half matte finish.

Technical Notes

Standard mounting type (front or rear): with hex screws to DIN 933, M 8x25, washers & nuts.

Safety mounting type (rear only): with bolts to DIN603, M8x25, washers & nuts.

Long term temperature resistance -60°C to + 200°C. Minimum stress resistance >1000N.

Ideal for use in food industry applications.

Order No. Standard Mounting	Order No. Safety Mounting	l_1	a_1 \emptyset	h_1	h_2	b_1	d_1	l_2	l_3	l_4	t_1	w_1
78800.W0200	78800.W0210	200	30x1,5	60	5	48	M 8x25	225	215	32	5	25
78800.W0250	78800.W0260	250	30x1,5	60	5	48	M 8x25	275	265	32	5	25
78800.W0300	78800.W0310	300	30x1,5	60	5	48	M 8x25	325	315	32	5	25
78800.W0350	78800.W0360	350	30x1,5	60	5	48	M 8x25	375	365	32	5	25
78800.W0400	78800.W0410	400	30x1,5	60	5	48	M 8x25	425	415	32	5	25
78800.W0500	78800.W0510	500	30x1,5	60	5	48	M 8x25	525	515	32	5	25
78800.W0600	78800.W0610	600	30x1,5	60	5	48	M 8x25	625	615	32	5	25

