



# Pull Handles - Collapsible

stainless steel



## Pull Handles

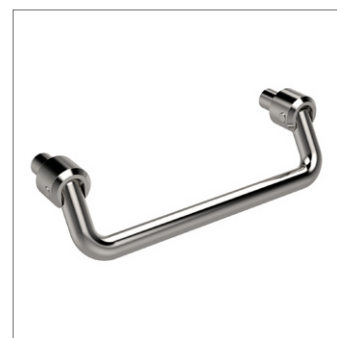
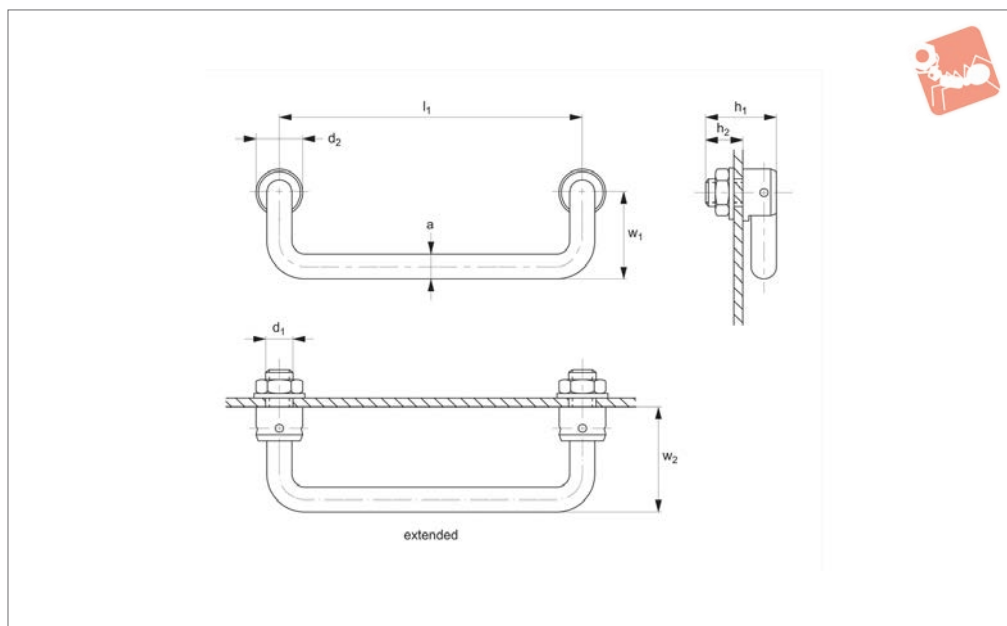

**78970**

PULL HANDLES

### Material

All components made of round bar stainless steel, material no. 1.4305. Finish: vibration ground to a semi-matt finish.

### Technical Notes

Spring-arrest in both retracted and extended positions. One piece pivot bushing. Minimum stress resistance 500N.

### Tips

Supplied complete with nuts and washers.

Order No.	$l_1$	$a$	$d_1$	$d_2$	$h_1$	$h_2$	$w_1$	$w_2$
<b>78970.W0100</b>	100	10	M10x1	18	28	14	34	43
<b>78970.W0120</b>	120	10	M10x1	18	28	14	34	43
<b>78970.W0180</b>	180	10	M10x1	18	28	14	34	43