

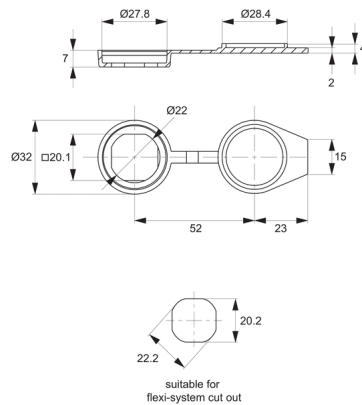

## Dust Cap for flexi-system cam latches and locks

## Cam Latch Accessories



### A0360

CAM LATCH ACCESSORIES

#### Material

Body: polyamide, black.

#### Technical Notes

Fits all Flexi-System cam latches & locks, and other fasteners with a standard instal-

lation cut out of 22,2 dia / 20,2 square.

#### Tips

Note when dust cap used the cam latch useful body length ,lh' is reduced by 2mm. This is important in relation to selection of

suitable cam.

#### Important Notes

Sold subject to pack quantity.

#### Order No.

A0360.AW0010

#### Type

Polyamide

