



# Cam Lock - Clip Fixing

fixed grip - zinc



## Cam Locks

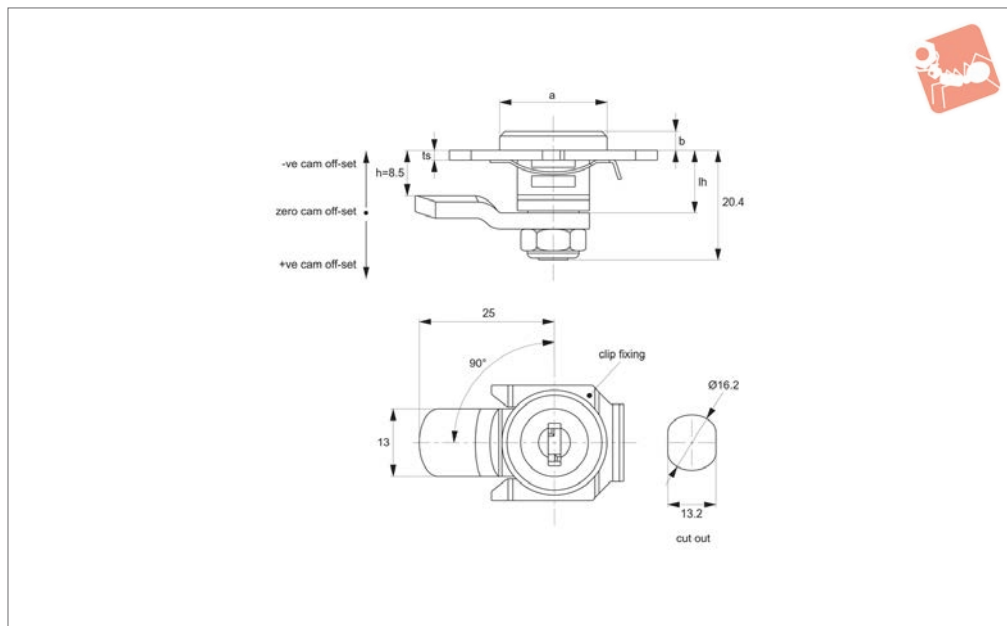

**A2324**

CAM LOCKS

### Material

Body & insert: die cast zinc, pocked black powder coated.

**Supplied with:** Keys: two per lock.

Cam: zinc plated steel.

### Technical Notes

For panel thickness 1.5-5mm. Dimensions

ch & cl relate to cam. Use formula to calculate ch (required cam off-set), and refer to cam selection chart;

**ch = h - lh** where;

**ch** = required cam off-set/ height.

**h** = grip length (distance between inside of latch face and front of cam).

**lh** = body length of cam latch/lock to be used (see product table below).

Order No.	Key type	a	b	lh	ts
<b>A2324.AW0010</b>	Keyed Alike	19.5	3.5	11.5	1,5-5



### A2326

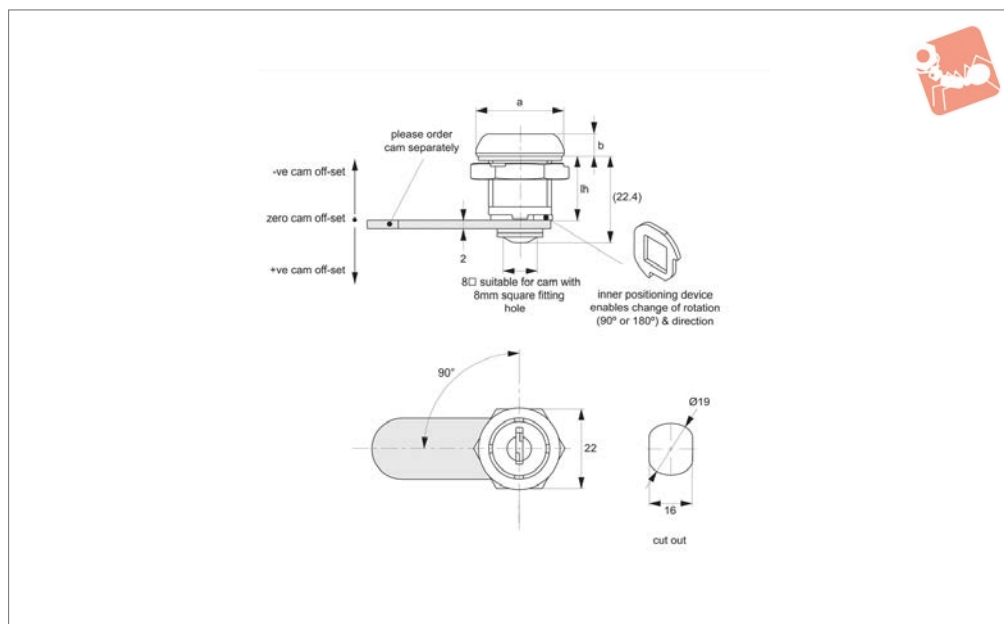

#### Material

Body & inset: plastic.  
Cap: stainless steel, mirror polished.  
Nut: die cast zinc, white zinc plated. Screw: steel, white zinc plated.

#### Supplied with:

Keys: two per lock.

#### Technical Notes

Order cam separately.  
Suitable for use with cam A2326.AW0999

#### Tips

Lock has inner positioning device which can be manipulated to give either 90° or 180° lock rotation, and to can change direction of rotation.

Order No.	Key type	Rotation	a	b	lh
A2326.AW0010	Keyed Alike	90	22.8	5.8	16.5
A2326.AW0020	Keyed Alike	180	22.8	5.8	16.5
A2326.AW0999	Cam	-	-	-	-



# Mini Cam Lock

fixed grip - zinc - extending cam



## Cam Locks

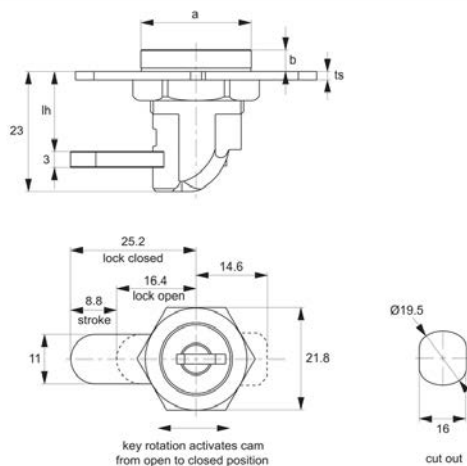

### A2328

CAM LOCKS

#### Material

Body & insert: zinc die cast, black painted.

**Supplied with:** Cam: steel, white zinc plated.

Keys: two supplied per lock.

#### Tips

Actuation of lock by turning key 180°. The

cam extends to lock and retracts to open.  
Cam has effective stroke of 8,8mm.

Order No.	Key type	a	b	lh
A2328.AW0010	Keyed Alike	21.6	4	15



**A2330**

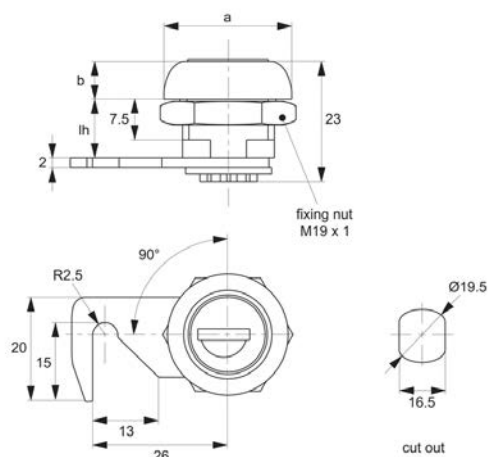

### Material

Body: zinc die cast, bright chrome plated.

**Supplied with:** Cam: steel, white zinc

plated. Keys: supplied two per lock.

to fixed point on frame.

### Technical Notes

Hooked cam allows locking by rotation on

Order No.	Key type	a	b	lh
A2330.AW0010	Keyed Alike	24.0	7.2	11
A2330.AW0020	Keyed to Differ	24.0	7.2	11



## Mini Cam Locks

fixed grip - zinc



## Cam Locks

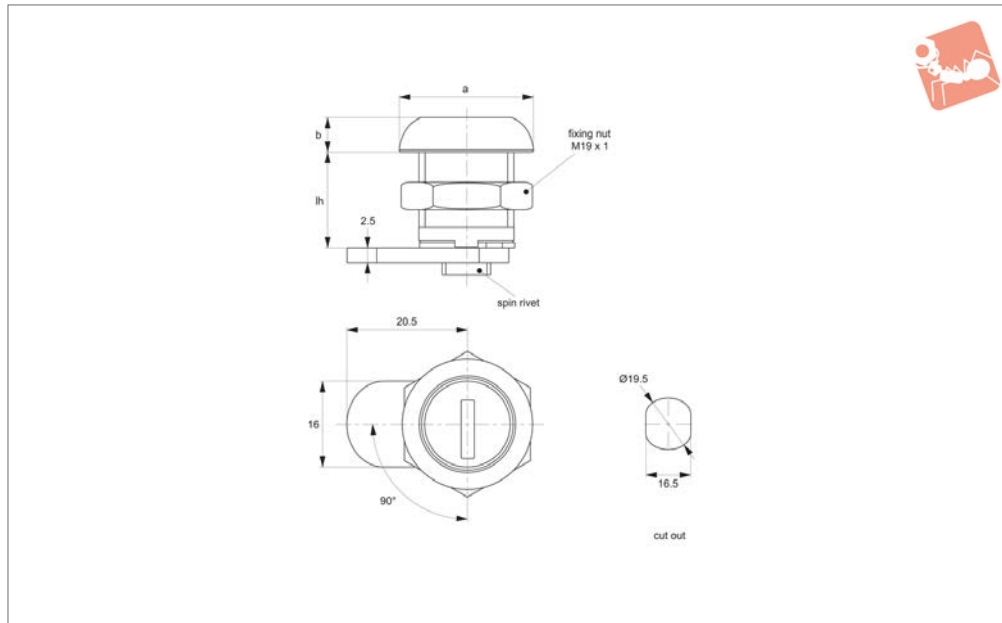

# A2331

CAM LOCKS

### Material

Body: zinc die cast, white zinc plated.

**Supplied with:** Cam: steel.

Keys: two per lock.

### Tips

Quarter turn opening or closing. Ideal for

use in metal cabinets, drawers and machinery covers etc.

Due to compact size of cam and lock body there is no need to remove cam during installation.

Keyed to differ model has a max. 100 key

combinations.

Order No.	Key type	a	b	lh
A2331.AW0010	Keyed Alike	23.0	6	16
A2331.AW0020	Keyed to Differ	23.0	6	16

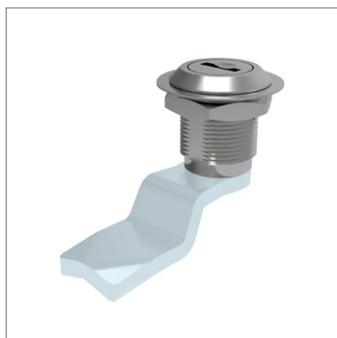

### A2333

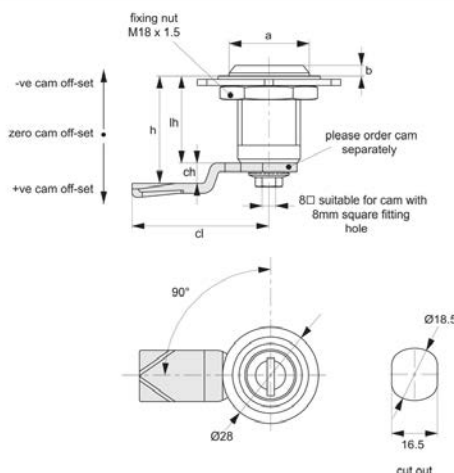

#### Material

Body & insert: zinc die cast, bright chrome plated.

**Supplied with:** Cam: steel, white zinc plated.

Keys: two per lock.

#### Technical Notes

Order cam separately.

**Cams:** see suitable cam A0203, A0224 and A0240. Select „without projection“ cam

type.

Dimensions ch and cl relate to cam. Use formula to calculate ch (required cam off-set), and refer to cam selection chart;

**ch = h - lh** where;

**ch** = required cam off-set/height.

**h** = grip length (distance between inside of latch face and front of cam).

**lh** = body length of cam latch/lock to be used (see product table below).

**Rods & Guides:** to achieve 3-point latching - A0303, A0321, A0325.

#### Tips

Quarter turn opening or closing. Ideal for use in metal cabinets, drawers and machinery covers etc.

Due to compact size of cam and lock body there is no need to remove cam during installation.

Order No.	Key type	a	b	lh
A2333.AW0010	Keyed Alike	22.5	3	16
A2333.AW0110	Keyed Alike	22.5	3	20
A2333.AW0210	Keyed Alike	22.5	3	30
A2333.AW0120	Keyed to Differ	22.5	3	20
A2333.AW0020	Keyed to Differ	22.5	3	16
A2333.AW0220	Keyed to Differ	22.5	3	30

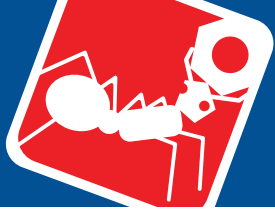

## Mini Cam Lock

fixed grip - zinc



## Cam Locks

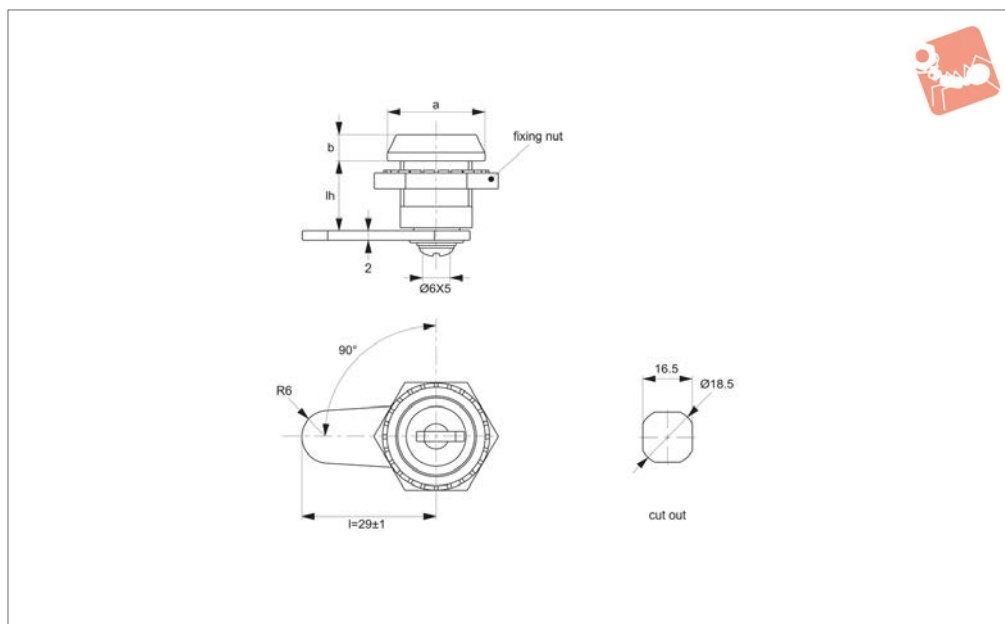

### A2340

CAM LOCKS

#### Material

Body & insert: zinc die cast, bright chrome plated.

**Supplied with:** Cam: steel, white zinc plated. Keys: two per lock.

#### Tips

Quarter turn opening or closing. Ideal for use in metal cabinets, drawers and machinery covers etc.

Due to compact size of cam and lock body

there is no need to remove cam during installation.

Order No.	Key type	a	b	lh
A2340.AW0010	Keyed Alike	22.0	6	15

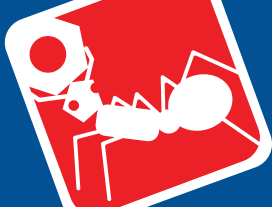

A2342

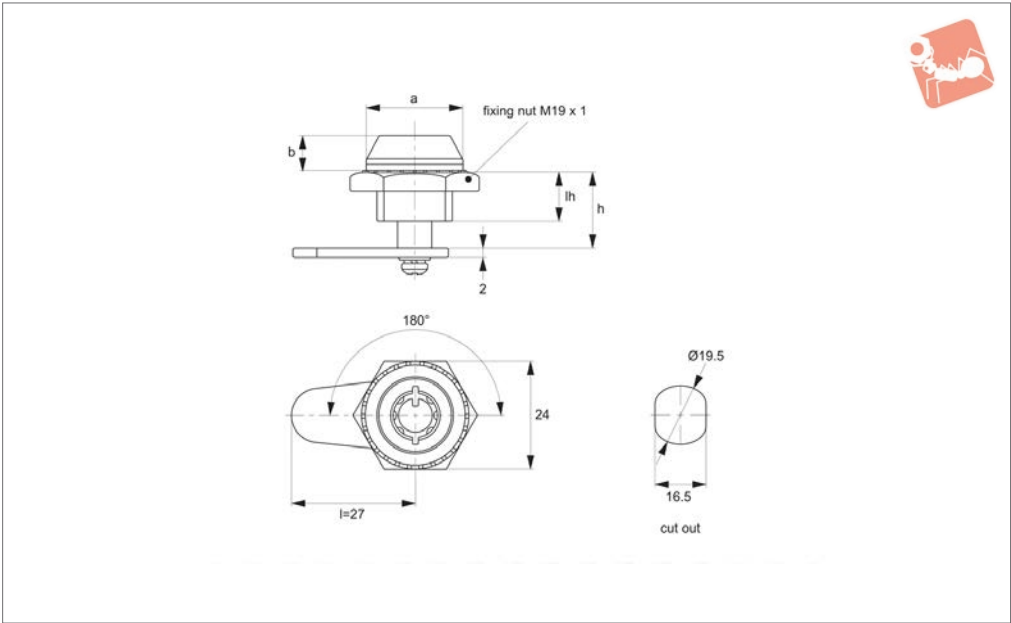

**Material**

Body & insert: zinc die cast, bright chrome plated.  
**Supplied with:** Cam: steel, white zinc

plated. Keys: two per lock.

key offers extra security.

**Tips**

180° rotation opening and closing. Radial

Order No.	Key type	a	b	h	lh
A2342.AW0022	Radial Key	22.0	7.5	19	13





## Mini Cam Lock

cam lock - fixed grip

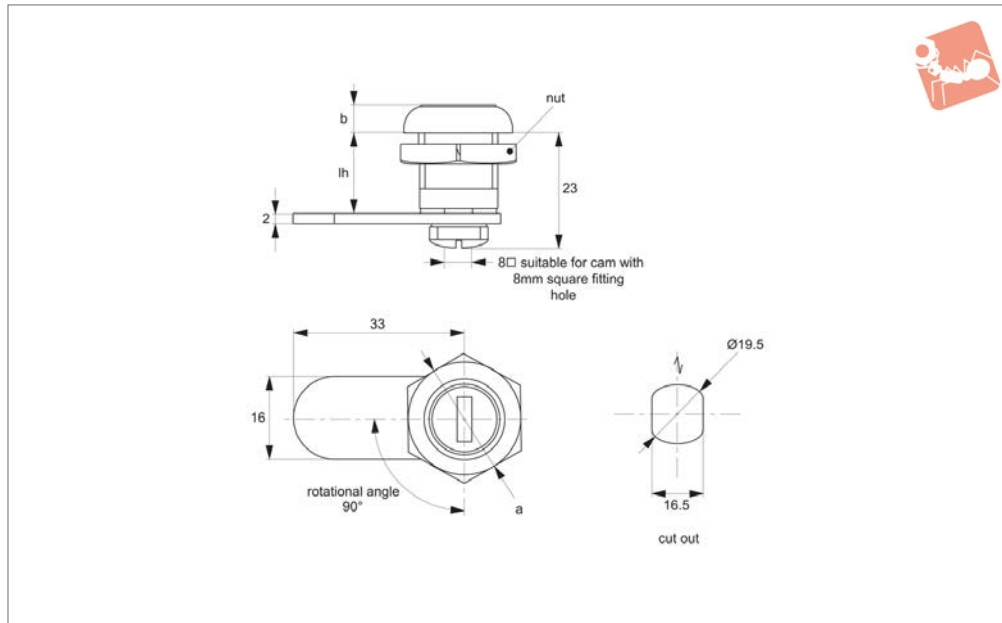

### A2383

CAM LOCKS

#### Material

Body & insert: die cast zinc, bright chrome plated.

Fixed grip: zinc.

**Supplied with:** Nuts, Cam and Keys: two per lock.

#### Tips

Ideal for use in metal cabinets, drawers

and machinery covers etc.

Due to compact size of cam and lock body there is no need to remove cam during installation.

Keyed to differ model has a max. 100 key combinations.

Type Three - 90° key rotation, key non-removable when in unlocked position.

Quarter-turn opening. Locks have dust cover.

Order No.	a	b	lh
A2383.AW0010	22.0	5.5	15.5



### A2390

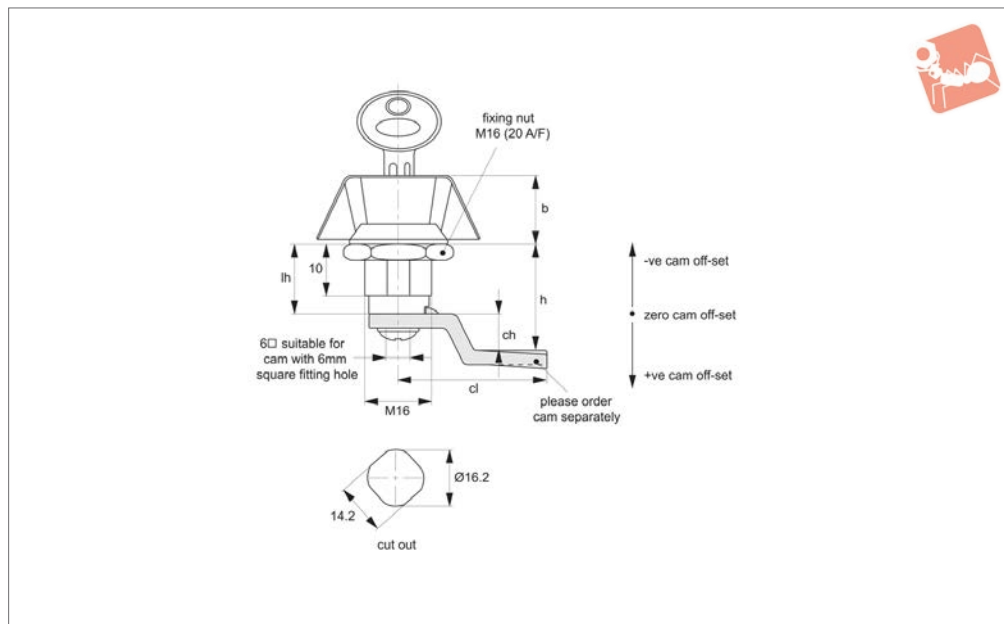

#### Material

Black painted ZDC housing and handle, white zinc plated cam.

**Supplied with:** Keys: two per lock. Nut - steel, zinc plated.

**Not supplied:** CAM - order separately.

#### Technical Notes

Order cam separately.

**Cams:** see suitable cam A0261. Select „with projection“ cam type to prevent cam rotating over 45°.

Dimensions ch and cl relate to cam. Use formula to calculate ch (required cam off-set), and refer to cam selection chart;

**ch = h - lh** where;

**ch** = required cam off-set/height.

**h** = grip length (distance between inside of latch face and front of cam).

**lh** = body length of cam latch/lock to be used (see product table below).

#### Important Notes

Sold subject to pack quantity.

Order No.	Key type	Type	Body finish	b	lh
A2390.AW0010	Keyed Alike	Type One	Chrome Plated	14.5	13.0
A2390.AW0020	Keyed Alike	Type Two	Black Coated	14.5	13.0

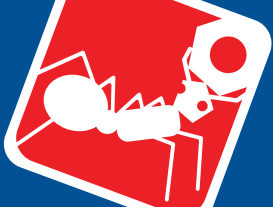

# Mini Cam Locks

wing handle - fixed grip - zinc

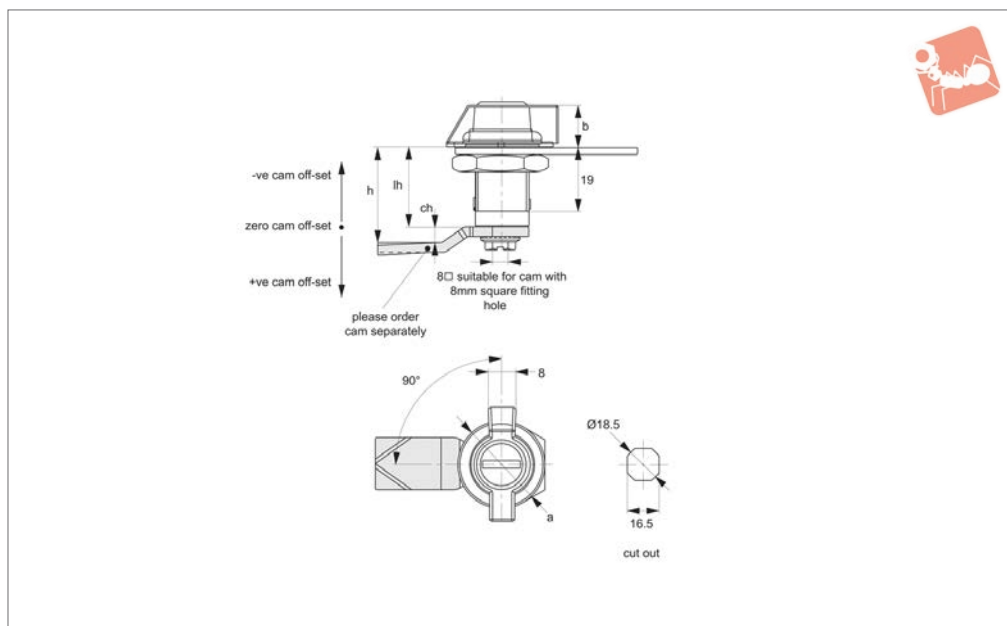

**A2392**

CAM LOCKS

## Material

Body & handle: die cast zinc, black coated.

**Supplied With:** Keys: two per lock.

**Not supplied:** Cam: order separately.

## Technical Notes

Order cam separately.

**Cams:** see suitable cam A0203, A0224 and

A0240. Select „without projection“ cam type.

Dimensions ch and cl relate to cam. Use formula to calculate ch (required cam off-set), and refer to cam selection chart;

**ch = h - lh** where;

**ch** = required cam off-set/height.

**h** = grip length (distance between inside of latch face and front of cam).

**lh** = body length of cam latch/lock to be used (see product table below).

**Rods & Guides:** to achieve 3-point latching - A0303, A0321, A0325.

Order No.	Key type	a	Body finish	b	lh
A2392.AW0010	Keyed Alike	25.0	Chrome Plated	13	24
A2392.AW0020	Keyed Alike	25.0	Black Coated	13	24



### A2393

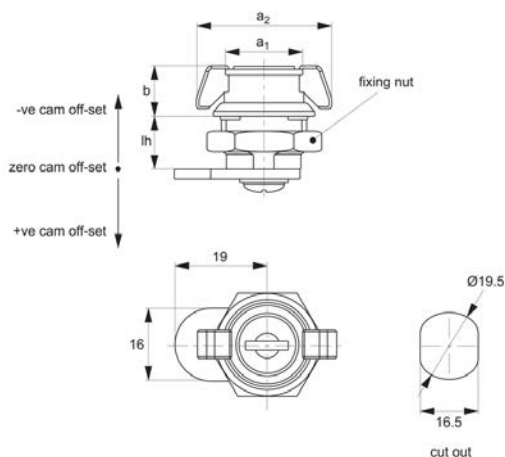

#### Material

Housing and insert: die cast zinc.  
Cam: steel.

**Supplied With:** cam and keys.

#### Tips

Quarter-turn opening or closing. Wing knob acts as grip/handle.

#### Important Notes

Sold subject to pack qty.

Order No.	Body finish	$a_1$	$a_2$	$b$	$lh$
A2393.AW0010	Chrome Plated	17	29.5	11	11
A2393.AW0020	Black Coated	17	29.5	11	11



# Selecting the Correct Cam Latch or Lock

**A1004 - A4260**  
Cam Latches and Locks

When selecting a Wixroyd Cam Latch for your application, you need to answer these questions:

1. Which installation cut out?
2. Which body style?
3. Which locking key?
4. Which accessories?
5. Which cam type and size?

## Cut out

All our Flexi-System cam latches use a standard installation cut out 22,2 dia, 20,2 square, for maximum flexibility. We also provide a number of alternative cut out dimensions for legacy/historical installations.

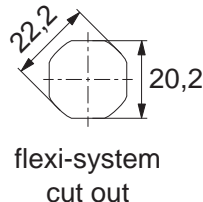

**Step 1:**  
**Which installation cut out?**

## Material and finish

Select from our variety of die cast zinc, polyamide plastic and stainless versions.



Die-cast  
zinc chrome  
plate



Die-cast  
zinc black  
coated



Polyamide  
black



Stainless  
steel

## Actuation and locking method

Standard insert driver type, cylinder lock or wing handle type.



Insert driver



Cylinder lock



Wing handle

## Number of latching points in application

Typically single point latching is required, but the Wixroyd Flexi-System also provides multi-point latching (typically 3 point - at lock point, top and bottom of cabinet).



Single point



Two point



Multi-point

**Step 2:**  
**Which body style?**

## Standard insert driver keys

Our range of insert driver cam latches require a simple key to actuate. Refer to part A0102 and A0103 for correct keys.



## Cylinder locking

Our cam locks with cylinder locks are supplied with two keys per lock. Available as keyed alike or keyed to differ locks.



**Step 3:**  
**Which locking key?**

- Multi-point latching: use our rod set A0303 to A0325 for suitable rods and rod guides.
- Finger pulls: easily installed with any of our flexi-system cam bodies, finger pull no. A0352 is a simple, cost effective handle for your cabinets.
- Dust Cap: to reduce material ingress.

**Step 4:**  
**Which accessories?**

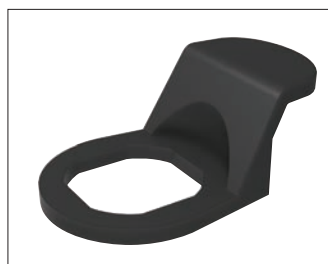



## With or without "Projection"

Different cam bodies require cams either with or without projection.

### Step 5:

#### Which cam type and size?

Wixroyd cams are available in a number of different materials; zinc plated steel, stainless steel (AISI 304) and black plastic.

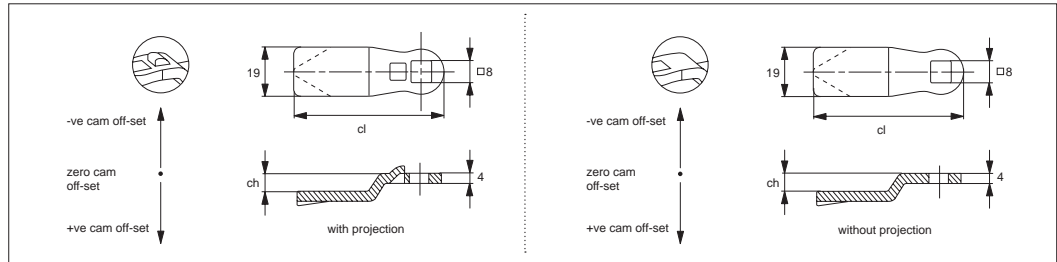

With projection cams prevent turning of the cam over  $45^\circ$ , but is not suited to all cam bodies. For correct projection type please see individual cam body technical pages.

#### Number of Latching Points

Single point cams are suitable where just single point latching is required. Multi-point cams are for applications requiring 2 or 3 latching points.

## Calculation of correct cam off-set

This is the most important aspect of the selection process.

### Cam off-set (dimension ch)

To ensure your cam fully and correctly engages with the frame of your door the correct cam off-set must be selected. A cam off-set can be either negative (-ve) or positive (+ve).

### Cam length (dimension cl)

This impacts the reach of the cam to door frame and hence impacts positioning of cam body for installation. Cam length is measured from the centre of the cam fixing hole to the cam's leading edge. Most typically cams are 45 mm in length.

Use formula to calculate ch (required cam off-set), and refer to the cam selection chart.

$ch = h - lh$  where;

ch = the required cam off-set/height

h = grip length (distance between inside of latch face and front of cam).

lh = body length of cam latch/lock to be used (see example below)

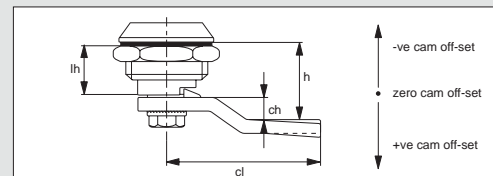

## Example of calculation of correct cam off-set

### Example one

Cam body A1003.AW0010 has been selected for the application. If we refer to the data sheet for this part, suitable cams are parts A0203, A0210 or A0240 - "without projection".

Known application information:  $h = 26$   $lh = 18$

Therefore;  $ch = 26 - 18 = +8$

Cam off set of +8 is required

Using the data tables for cams A0203, A0210, and A0240 we can select the following cams without projection with an off set of +8; A0203.AW5408 (steel), A0210.AW0428 (stainless) or A0240.AW0108 (three point cam).

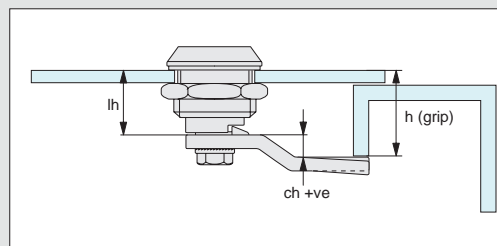

### Example two

Cam body A1003.AW0010 has been selected for the application. If we refer to the data sheet for this part, suitable cams are parts A0203, A0210 or A0240 - "without projection".

Known application information:  $h = 14$   $lh = 18$

Therefore;  $ch = 14 - 18 = -4$

The required cam off set is negative, -4 as the application's door frame is effectively shorter/lower than the length of the cam body

Using the data tables for cams A0203, A0210 and A0240 we can select the following cam without projection with an off set of -4; A0203.AW6404 (steel).

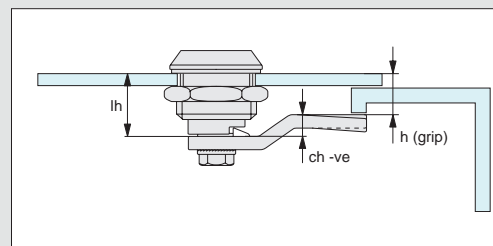

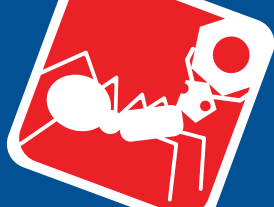

# Wixroyd Cam Latches, Locks and Swing Handles

cam selection chart



CAM LOCKS

Suitable With Projection Cams				
Compatible cam no.	A0261	A0203	A0210	A0240
Cam fitting hole	6 x 6 square 	8 x 8 square 	8 x 8 square 	8 x 8 square 
Cam latch / lock no.	A1261 / A1281 / A2390	A2503 / A2504 A2523 / A2528	A2503 / A2504 A2523 / A2528	A2503 / A2504 A2523 / A2528

Suitable Without Projection Cams Table 1				
Compatible cam no.	A0203	A0210	A0240	A0243
Cam fitting hole	8 x 8 square 	8 x 8 square 	8 x 8 square 	8 x 8 square 
Cam latch / lock no.	A1003 / A1021 / A1103 A1161 / A1168 / A1181 A1203 / A1210 / A1251 A1601 / A1620 / A1801 A2001 / A2203 / A2326 A2333 / A2392 / A2526 A4221 / A4241 / A4260 B1082 / B1086 / B1088 B1091 / B1092 / B1180 B1281 / B1285 / B1380 B1450 / B2091 / B2181	A1003 / A1021 / A1103 A1161 / A1168 / A1181 A1203 / A1210 / A1251 A1601 / A1620 / A1801 A2001 / A2203 / A2326 A2333 / A2392 / A2526 A4221 / A4241 / A4260 B1082 / B1086 / B1088 B1091 / B1092 / B1180 B1281 / B1285 / B1380 B1450 / B2091 / B2181	A1003 / A1021 / A1103 A1161 / A1168 / A1181 A1203 / A1210 / A1251 A1601 / A1620 / A1801 A2001 / A2203 / A2326 A2333 / A2392 / A2526 A4221 / A4241 / A4260 B1082 / B1086 / B1088 B1091 / B1092 / B1180 B1281 / B1285 / B1380 B1450 / B2091 / B2181	A1003 / A1021 / A1103 A1161 / A1168 / A1181 A1203 / A1210 / A1251 A1601 / A1620 / A1801 A2001 / A2203 / A2326 A2333 / A2392 / A2526 A4221 / A4241 / A4260 B1082 / B1086 / B1088 B1091 / B1092 / B1180 B1281 / B1285 / B1380 B1450 / B2091 / B2181

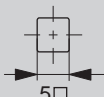
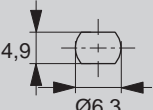
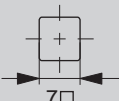
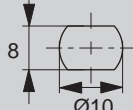
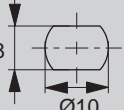
Suitable Without Projection Cams Table 2					
Compatible cam no.	A0250	A0234	A0215	A0231	A0233
Cam fitting hole	5 x 5 square 	6,3 dia. x 4,9 	7 x 7 square 	8 x 10 dia. 	8 x 10 dia. 
Cam latch / lock no.	A4600 / A4620	A1661 / A1667	B2082 / B2084 / B2086 B2088 / B2285 / B2380	A1603 / A1611 A1630 / A1810	A1603 / A1611 A1630 / A1810

## Calculation of correct cam off-set

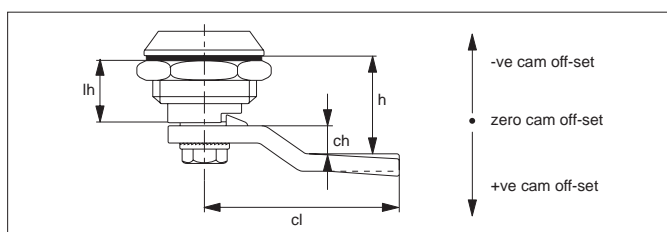

### Cam Off-Set (dimension ch)

To ensure your cam fully and correctly engages with the frame of your door the correct cam off-set must be selected. A cam off-set can be either negative (-ve) or positive (+ve).

### Cam Length (dimension cl)

Impacts reach of the cam to door frame and hence impacts positioning of cam body for installation. Cam length or reach is measured from the centre of the cam fixing hole to the cam's leading edge. Refer to individual cam body datasheets.

### Cam off-set

Use the formula to calculate your correct cam off-set:







$$ch = h - lh$$

ch = the required cam off-set.

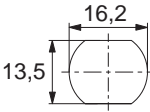
h = distance between inside of lock face and front of cam (also referred to as "grip length").

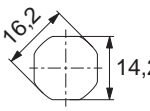
lh = length of cam body to be used (refer to individual cam body data sheets).



 cut out	Actuation Method			Body length (mm)	Body	Finishes	Cam Type		IP Rating
	Insert Driver	Cylinder Lock	Manual/Grip				With Projection	W/O Projection	
A1661 - Mini Compression Latch - Fixed Grip									
	✓			22,5	✓		✓	✓	54
Cams: A0234 - Keys: A0102									
A1667 - Mini Compression Latch - Wing Handle - Fixed Grip									
		✓		22,5	✓		✓	✓	54
Cams: A0234 - Keys: N/A									
 cut out	Actuation Method			Body length (mm)	Body	Finishes	Cam Type		IP Rating
	Insert Driver	Cylinder Lock	Manual/Grip				With Projection	W/O Projection	
A1261 - Mini Cam Latch - Fixed Grip									
	✓			12,5	✓	✓	✓	✓	
Cams: A0261 - Keys: A0102									
A1281 - Mini Cam Latch - Wing Handle - Fixed Grip									
		✓		12,5	✓		✓	✓	
Cams: A0261 - Keys: N/A									
A2390 - Mini Cam Lock - Wing Handle - Fixed Grip									
	✓			13	✓		✓	✓	
Cams: A0261 - Keys: Supplied									

 cut out	Actuation Method			Body length (mm)	Body	Finishes	Cam Type		IP Rating
	Insert Driver	Cylinder Lock	Manual/Grip				With Projection	W/O Projection	
A2326 - Mini Cam Lock - Fixed Grip									
	✓			16,5	✓		✓		✓
Cams: Supplied - Keys: Supplied									
A2328 - Mini Cam Lock - Fixed Grip									
	✓			15	✓		✓		✓
Cams: N/A - Keys: Supplied									
A2330 - Mini Cam Lock - Fixed Grip									
	✓			11	✓		✓		✓
Cams: Supplied - Keys: Supplied									
A2331 - Mini Cam Lock - Fixed Grip									
	✓			16	✓		✓		✓
Cams: Supplied - Keys: Supplied									
A2342 - Mini Cam Lock - Fixed Grip - Radial Key									
	✓			13	✓		✓		✓
Cams: Supplied - Keys: Supplied									
A2393 - Mini Cam Lock - Wing Handle - Fixed Grip									
	✓			11	✓		✓	✓	✓
Cams: Supplied - Keys: Supplied									

 cut out	Actuation Method			Body length (mm)	Body	Finishes	Cam Type		IP Rating
	Insert Driver	Cylinder Lock	Manual/Grip				With Projection	W/O Projection	
A2333 - Mini Cam Lock - Fixed Grip									
	✓			Various	✓		✓		✓
Cams: A0203, A0224, A0240 - Keys: Supplied									
A2340 - Mini Cam Lock - Fixed Grip									
	✓			15	✓		✓		✓
Cams: Supplied - Keys: Supplied									
A2392 - Mini Cam Lock - Wing Handle - Fixed Grip									
	✓			24	✓		✓		✓
Cams: A0203, A0224, A0240 - Keys: Supplied									



