

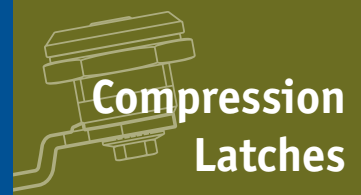

Compression Latch - Flexi System

insert driver - fixed grip - zinc



A1580

COMPRESSION LATCHES

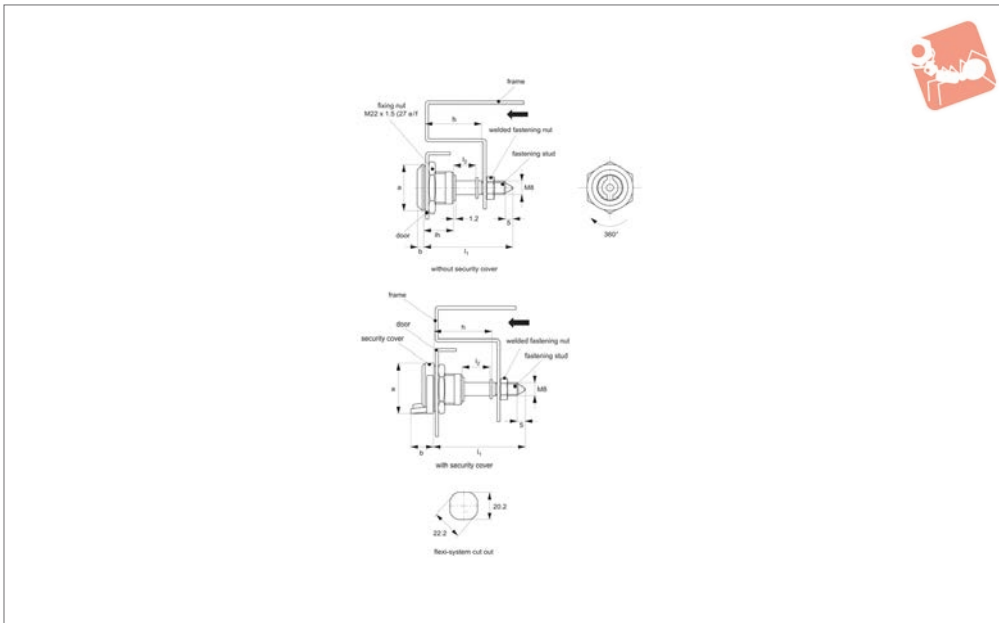

Material

Body: die cast zinc, bright chrome plated.
Insert: steel.

Not supplied: KEY - order separately.

Technical Notes

Order key separately.

Keys: see A0102.AW0060.

Insert driver compression latch enabling tight securing of enclosure door. Via welding a fastening nut (M 8) to the enclosure frame the fastening stud can be engaged and turned until the enclosure door is adequately tightened and secured (use triangle 7 key A0102.AW0060 to activate driver).

vate driver).

Tips

Security cover type can be secured with wire or cable tie for tamper evident security.

h = grip length.

| Order No. | Insert type | Lock type | a | b | lh | l ₁ | l ₂ | h |
|--------------|-------------|---------------------|----|----|----|----------------|----------------|----|
| A1580.AW0023 | Triangle 7 | W/o Security Cover | 28 | 4 | 18 | 40 | 2.5 | 23 |
| A1580.AW0028 | Triangle 7 | W/o Security Cover | 28 | 4 | 18 | 46 | 7.5 | 28 |
| A1580.AW0034 | Triangle 7 | W/o Security Cover | 28 | 4 | 18 | 54 | 13.5 | 34 |
| A1580.AW0223 | Triangle 7 | With Security Cover | 29 | 13 | 18 | 40 | 2.5 | 23 |
| A1580.AW0228 | Triangle 7 | With Security Cover | 29 | 13 | 18 | 46 | 7.5 | 28 |
| A1580.AW0234 | Triangle 7 | With Security Cover | 29 | 13 | 18 | 54 | 13.5 | 34 |

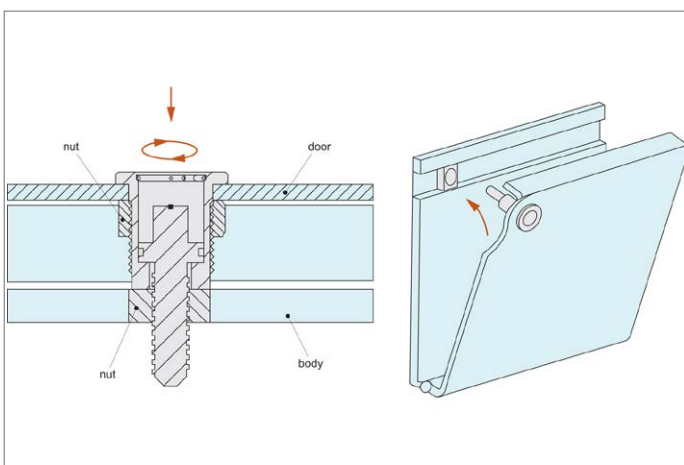



A1601

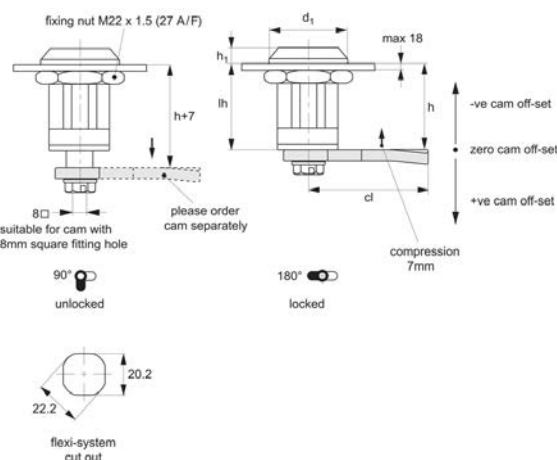

Material

Body & insert: die cast zinc, finished in chrome plate or black powder coating. Insert fitted with O'ring to provide IP54 rating.

Handle: polyamide.

Not supplied: CAM nor KEY - order separately.

Technical Notes

Order cam and key separately.

Cams: see suitable cam A0203 and A0224.

Select „without projection“ cam type.

Dimensions ch and cl relate to cam. Use formula to calculate ch (required cam off-set), and refer to cam selection chart;

$ch = h - lh$ where;

ch = required cam off-set/height.

h = grip length (distance between inside of latch face and front of cam).

lh = body length of cam latch/lock to be used (see product table below).

Keys: see A0102.

Tips

Compression locks provide sealing of enclosures to reduce vibration and to provide noise isolation.

Action:

From unlocked position, first 90° turn moves the cam to the locking position. Turn lock 180° to engage compression, cam moves to final fixing position.

Provides a 7mm compression stroke.

| Order No. | Finish | Insert driver | d_1 | h_1 | lh |
|--------------|---------------|---------------|-------|-------|------|
| A1601.AW0020 | Chrome Plated | Square 8 | 28 | 5.5 | 31 |
| A1601.AW0320 | Black Coated | Square 8 | 28 | 5.5 | 31 |
| A1601.AW0040 | Chrome Plated | Triangle 7 | 28 | 5.5 | 31 |
| A1601.AW0340 | Black Coated | Triangle 7 | 28 | 5.5 | 31 |
| A1601.AW0050 | Chrome Plated | Triangle 8 | 28 | 5.5 | 31 |
| A1601.AW0350 | Black Coated | Triangle 8 | 28 | 5.5 | 31 |
| A1601.AW0080 | Chrome Plated | Slot (2x4) | 28 | 5.5 | 31 |
| A1601.AW0380 | Black Coated | Slot (2x4) | 28 | 5.5 | 31 |
| A1601.AW0085 | Chrome Plated | Hexagon 8 | 28 | 5.5 | 31 |
| A1601.AW0385 | Black Coated | Hexagon 8 | 28 | 5.5 | 31 |



Compression Latches - Flexi-System

insert driver - fixed grip - zinc

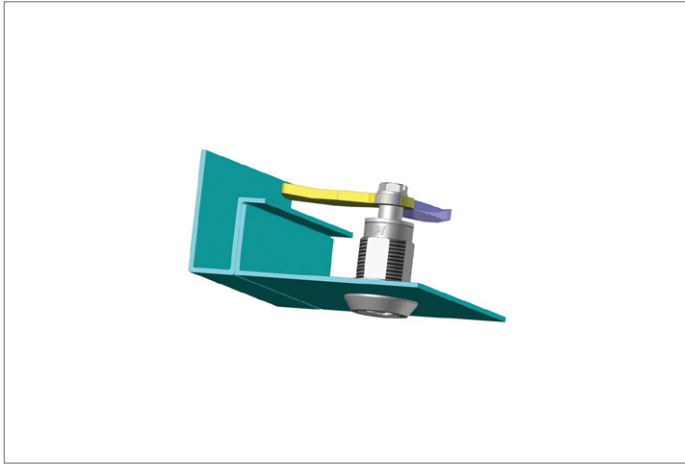
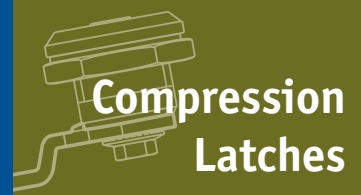



A1603

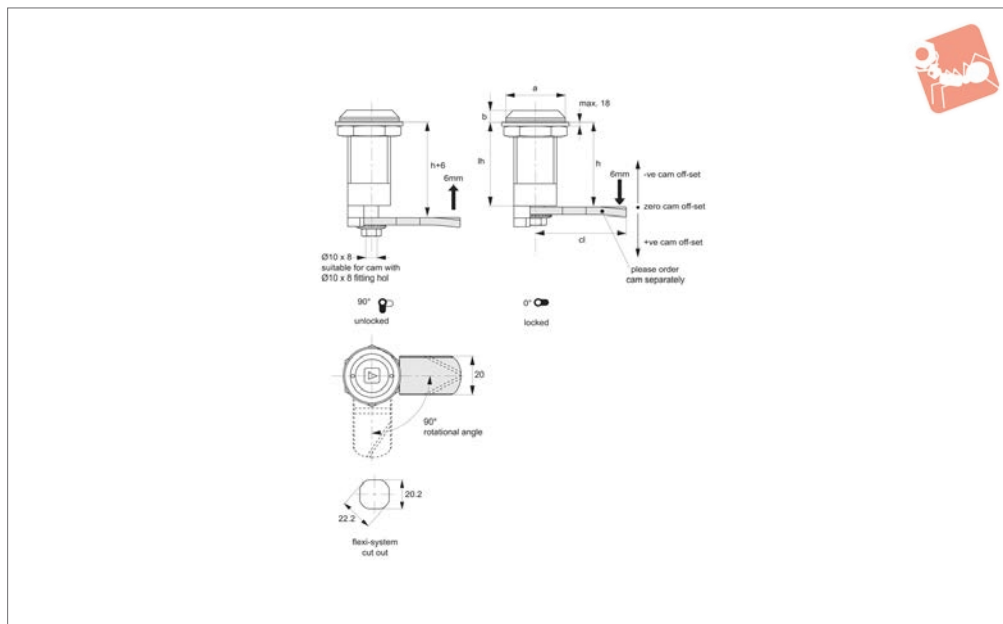

Material

Body & insert: stainless steel, AISI 304.
Insert fitted with O'ring to provide IP54 rating.

Shaft: steel, white zinc plated.

Not supplied: KEY - order separately.

Technical Notes

Order cam and key separately.

Cams: see suitable cam A0231 and A0233.

Select „without projection“ cam type.

Dimensions ch and cl relate to cam. Use

formula to calculate ch (required cam off-set), and refer to cam selection chart;

ch = **h** - **lh** where;

ch = required cam off-set/height.

h = grip length (distance between inside of latch face and front of cam).

lh = body length of cam latch/lock to be used (see product table below).

Keys: see A0102.

Tips

Compression locks provide sealing of

enclosures to reduce vibration and to provide noise isolation.

Action:

From unlocked position, first 90° turn moves the cam to the locking position. Turn lock 180° to engage compression, cam moves to final fixing position.

Provides a 6mm compression stroke.

| Order No. | Insert driver | Type | a | b | lh |
|--------------|---------------|------------|----|---|----|
| A1603.AW0020 | Square 8 | Fixed Grip | 28 | 5 | 38 |
| A1603.AW0050 | Triangle 8 | Fixed Grip | 28 | 5 | 38 |



Wixroyd Cam and Compression Latches

flexi-system cut out product selection charts

Cam Latches and Locks

|  flexi-system cut out | Actuation Method | | | Body length (mm) | Body | | | Finishes | | | Cam Type | | IP Rating | |
|--|---------------------|---------------|-------------|---------------------|---------------|-------------------|-----------------|---------------|--------------|---------|-----------------|----------------|--------------|--|
| | Insert Driver | Cylinder Lock | Manual/Grip | | Die-Cast Zinc | Polyamide Plastic | Stainless Steel | Chrome Plated | Black Coated | Natural | With Projection | W/O Projection | | |
| A1003 - Cam Latch - Fixed Grip | | | | | | | | | | | | | | |
|  | ✓ | | | 18 | ✓ | | | ✓ | ✓ | | | ✓ | 54 | |
| Cams: A0203, A0224, A0240 - Keys: A0102 | | | | | | | | | | | | | | |
| A1021 - Cam Latch - Fixed Grip | | | | | | | | | | | | | | |
|  | ✓ | | | 18 | ✓ | | | | | ✓ | | ✓ | 54 | |
| Cams: A0203, A0224, A0240 - Keys: A0102 | | | | | | | | | | | | | | |
| A1041 - Cam Latch - Push-to-Close - Fixed Grip | | | | | | | | | | | | | | |
|  | ✓ | | | 18 | ✓ | | | ✓ | | | | | | |
| Cams: Supplied - Keys: A0102 | | | | | | | | | | | | | | |
| A1103 - Cam Latch - Fixed Grip | | | | | | | | | | | | | | |
|  | ✓ | | | 18 | | ✓ | | | | ✓ | | ✓ | 54 | |
| Cams: A0210 - Keys: A0102 | | | | | | | | | | | | | | |
| A1161 - Cam Latch - Padlockable - Fixed Grip | | | | | | | | | | | | | | |
|  | | ✓ | | 18 | ✓ | | | ✓ | ✓ | | | ✓ | | |
| Cams: A0203, A0224, A0240 - Keys: Padlockable | | | | | | | | | | | | | | |
| A1168 - Cam Latch - Dust Proof Cap - Fixed Grip | | | | | | | | | | | | | | |
|  | ✓ | | | 18 | ✓ | | | ✓ | | | | ✓ | 54 | |
| Cams: A0203, A0224, A0240 - Keys: A0102 | | | | | | | | | | | | | | |
| A1181 - Cam Latch - Wing Handle - Fixed Grip | | | | | | | | | | | | | | |
| | | ✓ | | 18,5 | ✓ | ✓ | | ✓ | ✓ | ✓ | | ✓ | | |
| Cams: A0203, A0224, A0240 - Keys: N/A | | | | | | | | | | | | | | |

| | Actuation Method | | | Body length (mm) | Body | | | Finishes | | | Cam Type | | IP Rating |
|---|------------------|---------------|-------------|------------------|---------------|-------------------|-----------------|---------------|--------------|---------|-----------------|----------------|-----------|
| | Insert Driver | Cylinder Lock | Manual/Grip | | Die-Cast Zinc | Polyamide Plastic | Stainless Steel | Chrome Plated | Black Coated | Natural | With Projection | W/O Projection | |
| A1203 - Cam Latch - Finger Handle - Fixed Grip | | | | | | | | | | | | | |
|  | ✓ | | | Various | ✓ | | | ✓ | ✓ | | | ✓ | |
| Cams: A0203, A0224, A0240 - Keys: N/A | | | | | | | | | | | | | |
| A1210 - Cam Latch - Tamper Evident | | | | | | | | | | | | | |
|  | ✓ | | | 20 | ✓ | | | ✓ | | | | ✓ | |
| Cams: A0203, A0224, A0240 - Keys: N/A | | | | | | | | | | | | | |
| A1241 - Cam Latch - Stepped Grip | | | | | | | | | | | | | |
|  | ✓ | | | Various | ✓ | | | ✓ | | | | | 65 |
| Cams: Supplied - Keys: A0102 | | | | | | | | | | | | | |
| A1251 - Cam Latch - Fixed Extended Body | | | | | | | | | | | | | |
|  | ✓ | | | Various | ✓ | | | ✓ | | | | ✓ | 54 |
| Cams: A0203, A0224, A0240 - Keys: A0102 | | | | | | | | | | | | | |
| A1580 - Compression Latch - Fixed Grip | | | | | | | | | | | | | |
|  | ✓ | | | 18 | ✓ | | | ✓ | | | | | |
| Cams: N/A - Keys: A0102 | | | | | | | | | | | | | |
| A1601 - Compression Latch - Fixed Grip | | | | | | | | | | | | | |
|  | ✓ | | | 31 | ✓ | | | ✓ | ✓ | | | ✓ | 54 |
| Cams: A0203, A0224 - Keys: A0102 | | | | | | | | | | | | | |
| A1603 - Compression Latch - Fixed Grip | | | | | | | | | | | | | |
|  | ✓ | | | 38 | | ✓ | | | ✓ | | | ✓ | 54 |
| Cams: A0231, A0233 - Keys: A0102 | | | | | | | | | | | | | |

COMPRESSION LATCHES

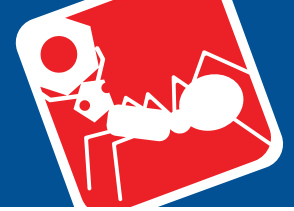

A1611

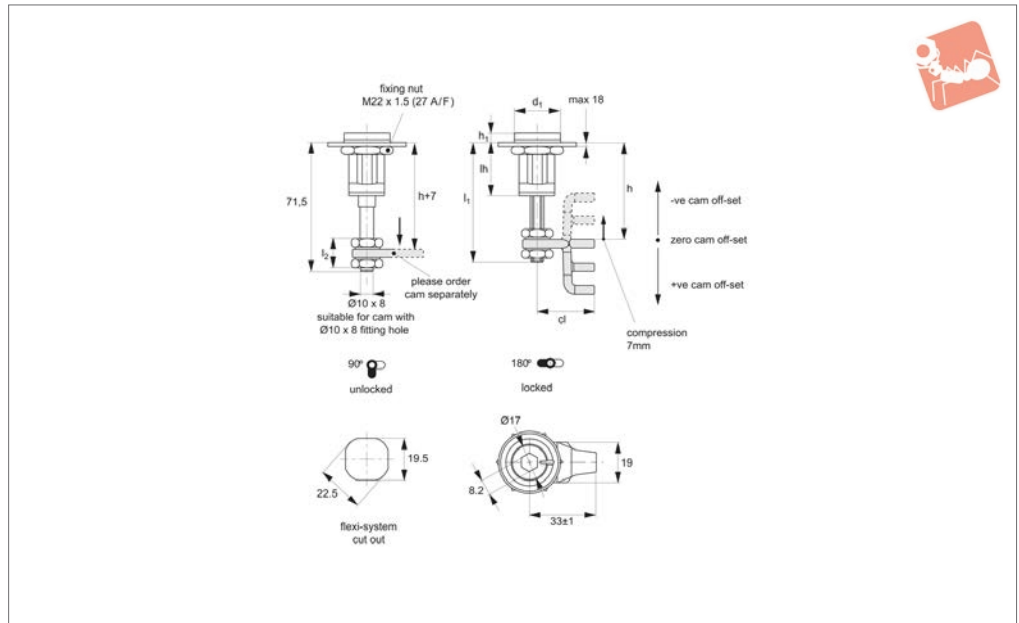

Material

Body & insert: die cast zinc, chrome plate or black coated finish. Insert fitted with O'ring to provide IP54 rating.

Handle: polyamide.

Not supplied: CAM nor KEY - order separately.

Technical Notes

Order cam and key separately.

Cams: see suitable cam A0231 and A0233.

Select „without projection“ cam type.

Dimensions ch and cl relate to cam. Use

formula to calculate ch (required cam off-set), and refer to cam selection chart;

ch = h - lh where;

ch = required cam off-set/height.

h = grip length (distance between inside of latch face and front of cam).

lh = body length of cam latch/lock to be used (see product table below).

Keys: see A0102.

Tips

Compression locks provide sealing of enclosures to reduce vibration and to

provide noise isolation. Adjustable grip type has an extended stem which can be cut in length to best suit your application.

Action:

From unlocked position, first 90° turn moves the cam to the locking position. Turn lock 180° to engage compression, cam moves to final fixing position.

Provides a 7mm compression stroke.

Important Notes

Cam: quarter turn to open or close. Locking function.

| Order No. | Finish | Insert driver | d ₁ | h ₁ | lh | l ₁ | l ₂ useful thread |
|--------------|---------------|---------------|----------------|----------------|----|----------------|------------------------------|
| A1611.AW0020 | Chrome Plated | Square 8 | 28 | 4.5 | 32 | 64.5 | 15 |
| A1611.AW0320 | Black Coated | Square 8 | 28 | 4.5 | 32 | 64.5 | 15 |
| A1611.AW0040 | Chrome Plated | Triangle 7 | 28 | 4.5 | 32 | 64.5 | 15 |
| A1611.AW0340 | Black Coated | Triangle 7 | 28 | 4.5 | 32 | 64.5 | 15 |
| A1611.AW0050 | Chrome Plated | Triangle 8 | 28 | 4.5 | 32 | 64.5 | 15 |
| A1611.AW0350 | Black Coated | Triangle 8 | 28 | 4.5 | 32 | 64.5 | 15 |
| A1611.AW0080 | Chrome Plated | Slot (2x4) | 28 | 4.5 | 32 | 64.5 | 15 |
| A1611.AW0380 | Black Coated | Slot (2x4) | 28 | 4.5 | 32 | 64.5 | 15 |
| A1611.AW0085 | Chrome Plated | Hexagon 8 | 28 | 4.5 | 32 | 64.5 | 15 |
| A1611.AW0385 | Black Coated | Hexagon 8 | 28 | 5.5 | 31 | 64.5 | 15 |



Flexi-System

at the core of all your cam latch requirements



All our cam latches use a standard cut out dimension of 22,2 Ø and 20,2 square which accommodates many industry standards. Flexi-System parts are fully interchangeable, providing a completely flexible hardware system including two or three point latching systems.

Flexi-system



insert driver cam latches



padlockable cam latches



wing handle cam latches



extended grip cam latches

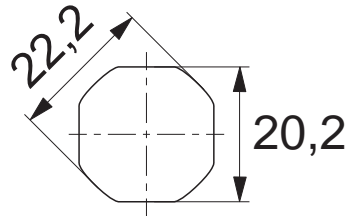

flexi-system cut out



cam locks



t-handle locks



l-handle locks



compression latches



A1620

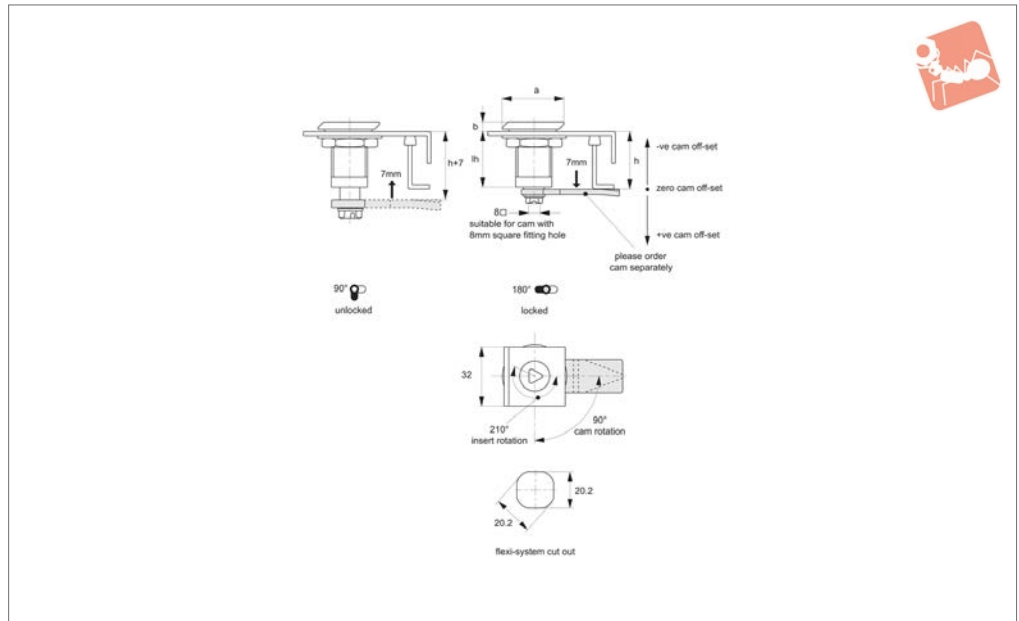

Material

Body & insert: die cast zinc, black powder coated. Fitted with O'ring to provide IP54 rating.

Not supplied: CAM nor KEY - order separately.

Technical Notes

Order cam and key separately.

Cams: see suitable cam A0203 and A0224.

Select „without projection“ cam type.

Dimensions ch and cl relate to cam. Use formula to calculate ch (required cam off-set), and refer to cam selection chart;

$ch = h - lh$ where;

ch = required cam off-set/height.

h = grip length (distance between inside of

latch face and front of cam).

lh = body length of cam latch/lock to be used (see product table below).

Keys: see A0102.

| Order No. | Insert driver | Type | a | b | lh |
|--------------|---------------|-------|----|---|----|
| A1620.AW0020 | Square 8 | Fixed | 34 | 5 | 32 |
| A1620.AW0040 | Triangle 7 | Fixed | 34 | 5 | 32 |
| A1620.AW0050 | Triangle 8 | Fixed | 34 | 5 | 32 |
| A1620.AW0080 | Slot (2x4) | Fixed | 34 | 5 | 32 |
| A1620.AW0085 | Hexagon 8 | Fixed | 34 | 5 | 32 |



9



With or without "Projection"

Different cam bodies require cams either with or without projection.

Step 5:

Which cam type and size?

Wixroyd cams are available in a number of different materials; zinc plated steel, stainless steel (AISI 304) and black plastic.

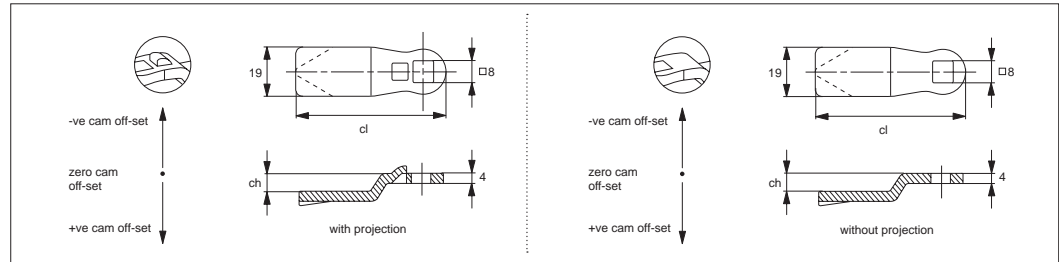

With projection cams prevent turning of the cam over 45° , but is not suited to all cam bodies. For correct projection type please see individual cam body technical pages.

Number of Latching Points

Single point cams are suitable where just single point latching is required. Multi-point cams are for applications requiring 2 or 3 latching points.

Calculation of correct cam off-set

This is the most important aspect of the selection process.

Cam off-set (dimension ch)

To ensure your cam fully and correctly engages with the frame of your door the correct cam off-set must be selected. A cam off-set can be either negative (-ve) or positive (+ve).

Cam length (dimension cl)

This impacts the reach of the cam to door frame and hence impacts positioning of cam body for installation. Cam length is measured from the centre of the cam fixing hole to the cam's leading edge. Most typically cams are 45 mm in length.

Use formula to calculate ch (required cam off-set), and refer to the cam selection chart.

ch = h - lh where;

ch = the required cam off-set/height

h = grip length (distance between inside of latch face and front of cam).

lh = body length of cam latch/lock to be used (see example below)

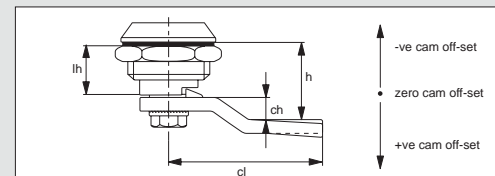

Example of calculation of correct cam off-set

Example one

Cam body A1003.AW0010 has been selected for the application. If we refer to the data sheet for this part, suitable cams are parts A0203, A0210 or A0240 - "without projection".

Known application information: h = 26 lh = 18

Therefore; ch = 26 - 18 = +8

Cam off set of +8 is required

Using the data tables for cams A0203, A0210, and A0240 we can select the following cams without projection with an off set of +8; A0203.AW5408 (steel), A0210.AW0428 (stainless) or A0240.AW0108 (three point cam).

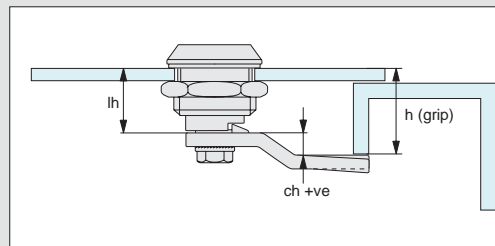

Example two

Cam body A1003.AW0010 has been selected for the application. If we refer to the data sheet for this part, suitable cams are parts A0203, A0210 or A0240 - "without projection".

Known application information: h = 14 lh = 18

Therefore; ch = 14 - 18 = -4

The required cam off set is negative, -4 as the application's door frame is effectively shorter/lower than the length of the cam body

Using the data tables for cams A0203, A0210 and A0240 we can select the following cam without projection with an off set of -4; A0203.AW6404 (steel).

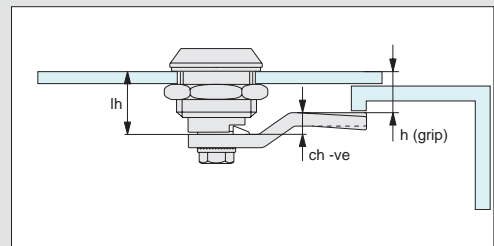



Wixroyd Cam Latches, Locks and Swing Handles

cam selection chart



| Suitable With Projection Cams | | | | |
|-------------------------------|-----------------------|--------------------------------|--------------------------------|--------------------------------|
| Compatible cam no. | A0261 | A0203 | A0210 | A0240 |
| Cam fitting hole | 6 x 6 square | 8 x 8 square | 8 x 8 square | 8 x 8 square |
| Cam latch / lock no. | A1261 / A1281 / A2390 | A2503 / A2504 A2523 / A2528 | A2503 / A2504 A2523 / A2528 | A2503 / A2504 A2523 / A2528 |

| Suitable Without Projection Cams Table 1 | | | | |
|--|---|---|---|---|
| Compatible cam no. | A0203 | A0210 | A0240 | A0243 |
| Cam fitting hole | 8 x 8 square | 8 x 8 square | 8 x 8 square | 8 x 8 square |
| Cam latch / lock no. | A1003 / A1021 / A1103 A1161 / A1168 / A1181 A1203 / A1210 / A1251 A1601 / A1620 / A1801 A2001 / A2203 / A2326 A2333 / A2392 / A2526 A4221 / A4241 / A4260 B1082 / B1086 / B1088 B1091 / B1092 / B1180 B1281 / B1285 / B1380 B1450 / B2091 / B2181 | A1003 / A1021 / A1103 A1161 / A1168 / A1181 A1203 / A1210 / A1251 A1601 / A1620 / A1801 A2001 / A2203 / A2326 A2333 / A2392 / A2526 A4221 / A4241 / A4260 B1082 / B1086 / B1088 B1091 / B1092 / B1180 B1281 / B1285 / B1380 B1450 / B2091 / B2181 | A1003 / A1021 / A1103 A1161 / A1168 / A1181 A1203 / A1210 / A1251 A1601 / A1620 / A1801 A2001 / A2203 / A2326 A2333 / A2392 / A2526 A4221 / A4241 / A4260 B1082 / B1086 / B1088 B1091 / B1092 / B1180 B1281 / B1285 / B1380 B1450 / B2091 / B2181 | A1003 / A1021 / A1103 A1161 / A1168 / A1181 A1203 / A1210 / A1251 A1601 / A1620 / A1801 A2001 / A2203 / A2326 A2333 / A2392 / A2526 A4221 / A4241 / A4260 B1082 / B1086 / B1088 B1091 / B1092 / B1180 B1281 / B1285 / B1380 B1450 / B2091 / B2181 |

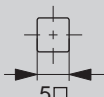
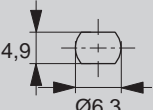
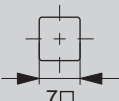
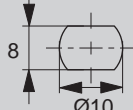
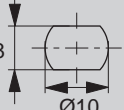
| Suitable Without Projection Cams Table 2 | | | | | |
|--|---|---|---|--|--|
| Compatible cam no. | A0250 | A0234 | A0215 | A0231 | A0233 |
| Cam fitting hole | 5 x 5 square  | 6,3 dia. x 4,9  | 7 x 7 square  | 8 x 10 dia.  | 8 x 10 dia.  |
| Cam latch / lock no. | A4600 / A4620 | A1661 / A1667 | B2082 / B2084 / B2086 B2088 / B2285 / B2380 | A1603 / A1611 A1630 / A1810 | A1603 / A1611 A1630 / A1810 |

Calculation of correct cam off-set

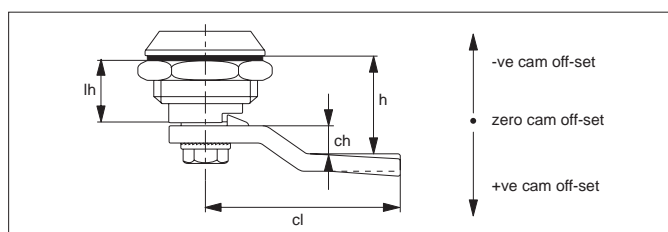

Cam Off-Set (dimension ch)

To ensure your cam fully and correctly engages with the frame of your door the correct cam off-set must be selected. A cam off-set can be either negative (-ve) or positive (+ve).

Cam Length (dimension cl)

Impacts reach of the cam to door frame and hence impacts positioning of cam body for installation. Cam length or reach is measured from the centre of the cam fixing hole to the cam's leading edge. Refer to individual cam body datasheets.

Cam off-set

Use the formula to calculate your correct cam off-set:

$$ch = h - lh$$

ch = the required cam off-set.

h = distance between inside of lock face and front of cam (also referred to as "grip length").

lh = length of cam body to be used (refer to individual cam body data sheets).

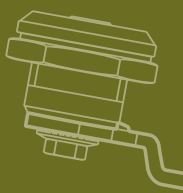

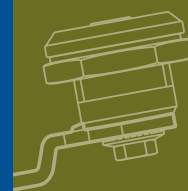
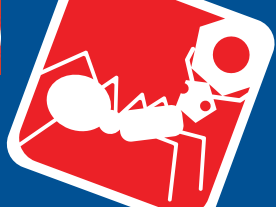

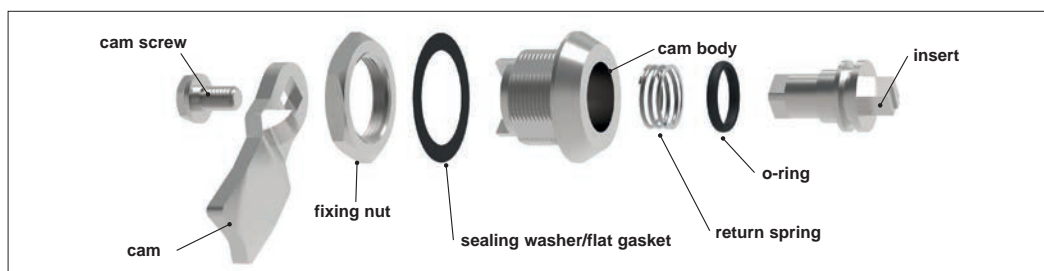

Materials

Physical and chemical characteristics of polyamide

| | |
|---------------------------|-------------------------|
| Physical condition | solid (at 20°C) |
| Density | > 1,0 g/cm ³ |
| Yield Point | 220°C |
| Smell | No particular smell |
| Dissolvability in water | Undissolvable |
| Segregation temperature | > 350°C |
| Fire Point | >390°C |
| Auto ignition temperature | > 400°C |

Zinc

Zinc Alloy is the most fundamental material for the Wixroyd product range. Housings, inserts, handles, spacers, keys, hinges etc, are all die cast products. The zinc used is a zinc alloy with the following contents (except zinc): Al 4,03% Cu 0,83% as well as minor contents of Mg, Fe, Pb, Cd, Sn and Ni.

RoHS Compliance

Our Cam Latches are RoHS Compliant.

RoHS
COMPLIANT

Plastic - Polyamide

Many of our products are made of injection moulded plastic, normally polyamide. When needed, we add fibreglass to the material, in order to optimise qualities of the product. Examples of products made out of polyamide: handles, housings, rod guides etc.

Degrees of sealing protection

IP ratings

A product classified to an IP rating has either been tested in an independent laboratory, or due to the resemblance of its structure to a tested product, classified as IP.

Important note: We can only guarantee our products correspond to the indicated classification when assembled and used correctly.

IP65
RATED

IP 65: Dust Tight and Jetting Secure. Through the application of an o-ring and a flat gasket, this higher classification can be achieved.

IP54
RATED

IP 54: Dust and Splash Protected. This is the standard classification for our products. Equivalent to NEMA3.

Flat gaskets/ Sealing Washer

| Character | Value | Standard |
|------------------------|--------------------------|-----------|
| Density | 1,35 g/cm ³ | DIN 53479 |
| Hardness | 65 Shore A | DIN 53505 |
| Breaking Strain | 5 N/mm ² | DIN 53504 |
| Expansion | 200% | DIN 53504 |
| Heat & cold resistance | max. 70°C, min. -35°C | |

Through the application of a flat gasket between the lock and the door, class IP 65 or NEMA 4 is achieved.

Pressure deformation test

| Time/temp. | Type of test | Standard | Result |
|------------|--------------|-------------|--------|
| 22h/100°C | DVR | DIN 53517 A | 9% |
| 70h/100°C | DVR | DIN 53517 A | 12% |

The flat gasket is made out of a mixture of NBR (Nitrile Rubber) and SBR (Styrolbutadiene Rubber). This gives the gasket a satisfactory chemical resistance and a good constancy to oil.

O Rings

| Character | Value | Standard |
|------------------------|---------------------------|-----------|
| Density | 1,240 g/cm ³ | DIN 53479 |
| Hardness | 71 Shore A | DIN 53505 |
| Breaking strain | 14 N/mm ² | DIN 53504 |
| Expansion | 280% | DIN 53504 |
| Recoil elasticity | 32% | DIN 53512 |
| Heat & cold resistance | max. 120°C, min. -40°C | |

For all O-rings, an NBR material with the following technical characteristics is used.

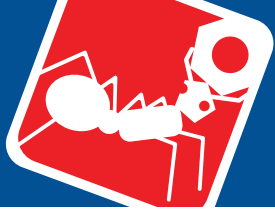

Flexi-system cut out

Our flexi-system is based on a standard installation cut out 22,2 Ø and 20,2 sq.

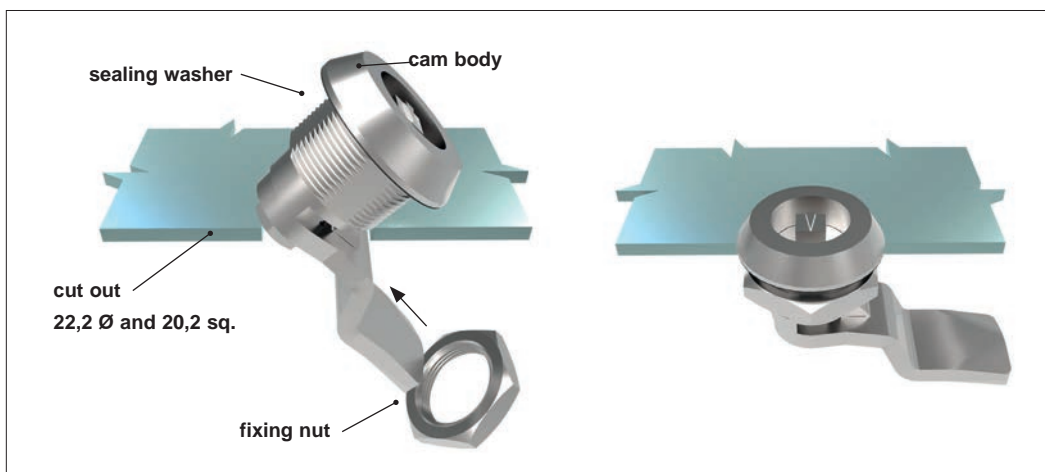
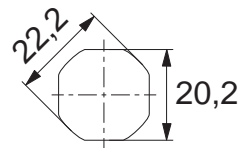

Option 1:
Installation when
fully assembled

When the cam latch grip (h) is 9mm or more this method is possible:-

1. With the cam body and cam fully assembled, attach the sealing washer to cam body.
2. Tilt the latch 45° and pass it, cam first, through the installation cut out in the panel.
3. When in place attach the fixing nut to the cam body to secure. Tighten to 10 Nm max.

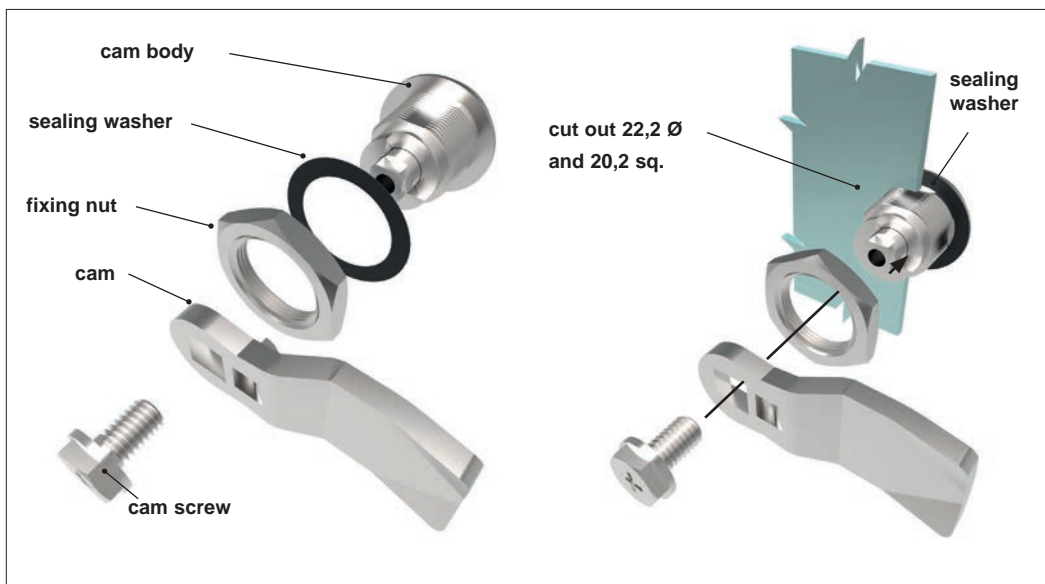

Option 2:
Installation
unassembled

When the cam latch grip (h) is less than 9mm this method is suitable:-

1. Prior to commencing ensure that the cam body, cam, cam screw, fixing nut and sealing washer are completely unassembled.
2. Attach the sealing washer to the cam body and pass through installation cut out in panel.
3. Attach the fixing nut to the cam body to secure. Tighten to 10 Nm max.
4. Attach the cam to the cam body. Once you have ensured that the cam has the correct orientation toward the panel frame, secure the cam screw and tighten to 4 Nm.



A1661

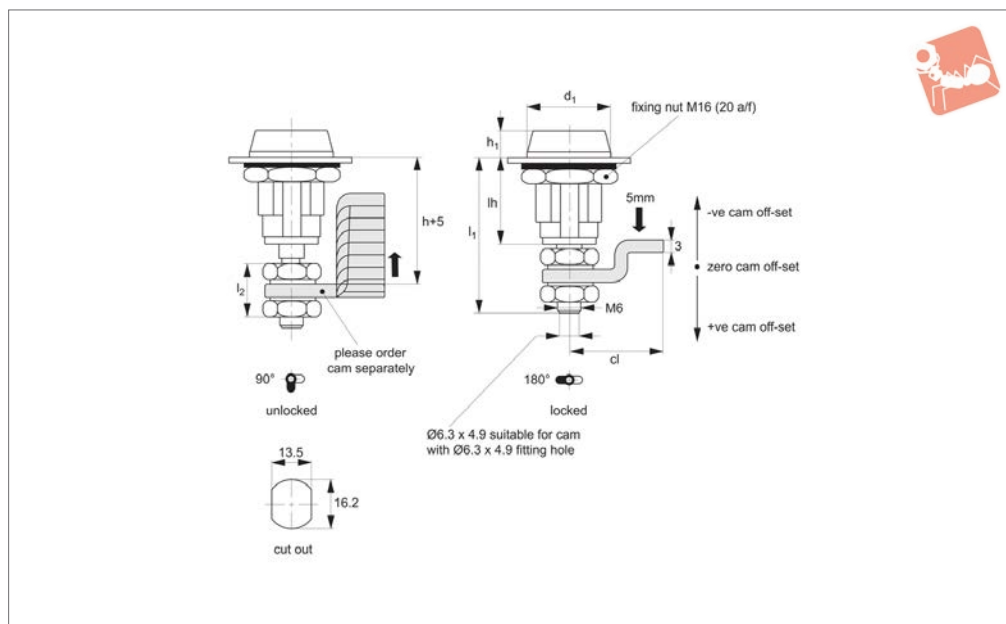

Material

Body & insert: die cast zinc, black paint coated.

Insert fitted with O'ring to provide IP54 rating.

Not supplied: CAM nor KEY: order separately.

Technical Notes

Suitable for material thickness 1-10mm.

Order keys separately.

Cam: see suitable cam A0234. Select „without projection“ cam type.

Dimensions ch & cl relate to cam. Use

formula to calculate ch (required cam off-set), and refer to cam selection chart;

ch = h - lh where;

ch = required cam off-set/height.

h = grip length (distance between inside of lock face and front of cam).

lh = body length of cam latch/lock to be used.

Keys: see A0102. For part A1661.AW0006 (Square 6) use key A0102.AW0306 only.

Tips

Compression locks provide sealing of enclosures to reduce vibration and to

provide noise isolation. Adjustable grip type has an extended stem which can be cut in length to best suit your application.

Action:

From unlocked position, first 90° turn moves the cam to the locking position. Turn lock 210° to engage compression, cam moves to final fixing position.

Provides a 5mm compression stroke.

| Order No. | Insert driver | d ₁ | h ₁ | lh | l ₁ | l ₂ useful thread |
|--------------|---------------|----------------|----------------|------|----------------|------------------------------|
| A1661.AW0006 | Square 6 | 20.8 | 6 | 22.5 | 38 | 15 |
| A1661.AW0080 | Slotted (2x4) | 20.8 | 6 | 22.5 | 38 | 15 |



Mini Compression Latches

adjustable grip - wing handle - zinc

Compression Latches

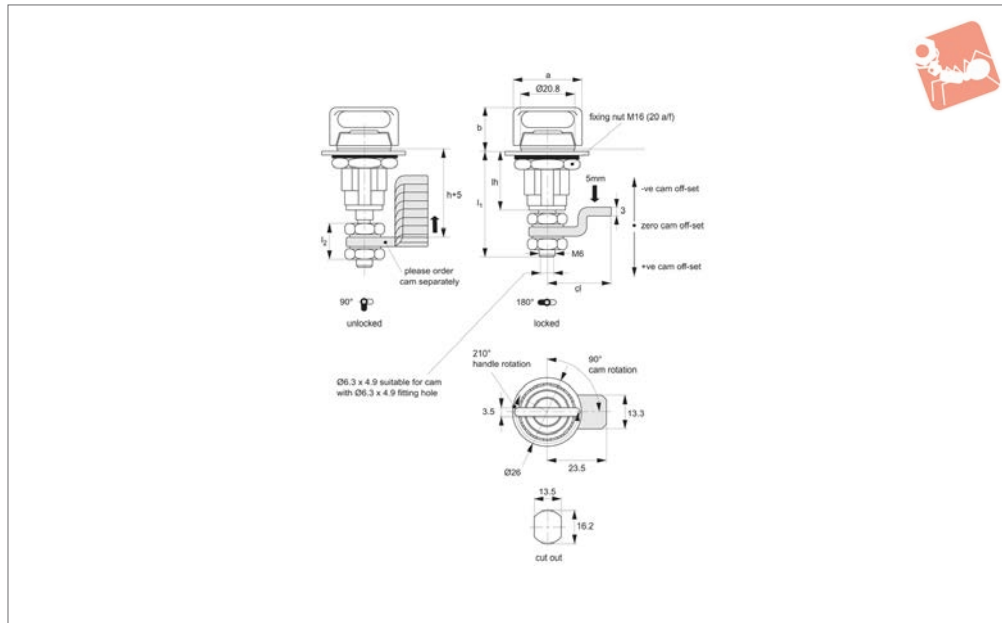

A1667

COMPRESSION LATCHES

Material

Body & insert: die cast zinc, black paint coated. Fitted with O'ring to provide IP54 rating.

Technical Notes

Suitable for material thickness 1-10mm.

Cam: see suitable cam A0234. Select „without projection“ cam type.

Dimensions ch & cl relate to cam. Use formula to calculate ch (required cam off-

set), and refer to cam selection chart;

$ch = h - lh$ where;

ch = required cam off-set/height.

h = grip length (distance between inside of lock face and front of cam).

lh = body length of cam latch/lock.

Keys: see A0102.

Tips

Compression locks provide sealing of enclosures to reduce vibration and to

provide noise isolation. Adjustable grip type has an extended stem which can be cut in length to best suit your application.

Action:

From unlocked position, first 90° turn moves the cam to the locking position. Turn lock 210° to engage compression, cam moves to final fixing position.

Provides a 5mm compression stroke.

| Order No. | Type | Actuation | a | b | lh | l_1 | l_2 useful thread |
|---------------------|-------|-------------|------|----|------|-------|---------------------|
| A1667.AW0010 | Fixed | Wing Handle | 25.5 | 12 | 22.5 | 38 | 15 |



When selecting a Wixroyd Cam Latch for your application, you need to answer these questions:

1. Which installation cut out?
2. Which body style?
3. Which locking key?
4. Which accessories?
5. Which cam type and size?

Step 1: Which installation cut out?

Cut out

All our Flexi-System cam latches use a standard installation cut out 22,2 dia, 20,2 square, for maximum flexibility. We also provide a number of alternative cut out dimensions for legacy/historical installations.

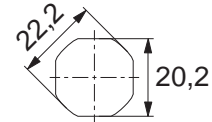

flexi-system
cut out

Step 2: Which body style?

Material and finish

Select from our variety of die cast zinc, polyamide plastic and stainless versions.



Die-cast
zinc chrome
plate



Die-cast
zinc black
coated



Polyamide
black



Stainless
steel

Actuation and locking method

Standard insert driver type, cylinder lock or wing handle type.



Insert driver



Cylinder lock



Wing handle

Number of latching points in application

Typically single point latching is required, but the Wixroyd Flexi-System also provides multi-point latching (typically 3 point - at lock point, top and bottom of cabinet).



Single point



Two point



Multi-point

Step 3: Which locking key?

Standard insert driver keys

Our range of insert driver cam latches require a simple key to actuate. Refer to part A0102 and A0103 for correct keys.



Cylinder locking

Our cam locks with cylinder locks are supplied with two keys per lock. Available as keyed alike or keyed to differ locks.



Step 4: Which accessories?

- Multi-point latching: use our rod set A0303 to A0325 for suitable rods and rod guides.
- Finger pulls: easily installed with any of our flexi-system cam bodies, finger pull no. A0352 is a simple, cost effective handle for your cabinets.
- Dust Cap: to reduce material ingress.

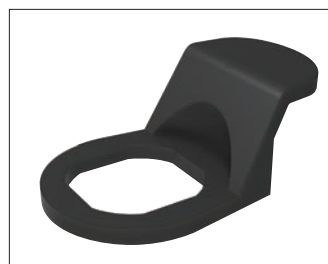



Wixroyd Cam and Compression Latches

product selection charts



Cam Latches and Locks

|  | Actuation Method | | | Body | Finishes | Cam Type | | IP Rating |
|---|------------------|-------------------|-----------------|---------------|--------------|-----------------|----------------|-----------|
| | Insert Driver | Cylinder Lock | Manual/Grip | | | With Projection | W/O Projection | |
| | Body length (mm) | | | | | | | |
| | | | | | | | | |
| | Die-Cast Zinc | Polyamide Plastic | Stainless Steel | Chrome Plated | Black Coated | Natural | | |

A1661 - Mini Compression Latch - Fixed Grip



✓

22,5

✓

✓

✓

54

Cams: A0234 - Keys: A0102

A1667 - Mini Compression Latch - Wing Handle - Fixed Grip



✓

22,5

✓

✓

✓

54

Cams: A0234 - Keys: N/A

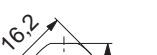
| | | | | | | | | |
|--|-------------------|-----------------|-----------------------------------|--------------|----------|----------|--|-----------|
|  <p>cut out</p> | Actuation Method | | | Body | Finishes | Cam Type | | IP Rating |
| Insert Driver | Cylinder Lock | Manual/Grip | With Projection W/O Projection | | | | | |
| Body length (mm) | | | | | | | | |
| | | | | | | | | |
| Die-Cast Zinc | Polyamide Plastic | Stainless Steel | Chrome Plated | Black Coated | Natural | | | |

A1261 - Mini Cam Latch - Fixed Grip



✓

12,5

✓

✓

✓

✓

✓

✓

Cams: A0261 - Keys: A0102

A1281 - Mini Cam Latch - Wing Handle - Fixed Grip



✓

12,5

✓

✓

✓

✓

Cams: A0261 - Keys: N/A

A2390 - Mini Cam Lock - Wing Handle - Fixed Grip



✓

13

✓

✓

✓

✓

Cams: A0261 - Keys: Supplied

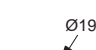
| | | | | | | | |
|---|------------------|-------------|-----------------|---------------|-----------------|----------------|-----------|
|  | Actuation Method | | | Body | Finishes | Cam Type | IP Rating |
| Insert Driver | Cylinder Lock | Manual/Grip | | | | | |
| Body length (mm) | | | | | | | |
| Die-Cast Zinc | | | | | | | |
| Polyamide Plastic | | | Stainless Steel | Chrome Plated | With Projection | W/O Projection | |
| | | | | Black Coated | | | |
| | | | | Natural | | | |

A2326 - Mini Cam Lock - Fixed Grip



✓

16,5

✓

✓

✓

Cams: Supplied - Keys: Supplied

A2328 - Mini Cam Lock - Fixed Grip



✓

15

✓

✓

✓

Cams: N/A - Keys: Supplied

A2330 - Mini Cam Lock - Fixed Grip



✓

11

✓

✓

✓

Cams: Supplied - Keys: Supplied

A2331 - Mini Cam Lock - Fixed Grip



✓

16

✓

✓

✓

Cams: Supplied - Keys: Supplied

A2342 - Mini Cam Lock - Fixed Grip - Radial Key



✓

13

✓

✓

✓

Cams: Supplied - Keys: Supplied

A2393 - Mini Cam Lock - Wing Handle - Fixed Grip



✓

11

✓

✓

✓

✓

Cams: Supplied - Keys: Supplied

| | | | | | | | |
|--|-------------------------|------------------|---------------------------|----------------------|------------------------|--------|--|
|  <p>cut out</p> | Actuation Method | Body length (mm) | Body | Finishes | Cam Type | Rating | |
| Insert Driver | Cylinder Lock | | Body | Finishes | Cam Type | | |
| Manual/Grip | Body length (mm) | | Body | Finishes | Cam Type | | |
| Body length (mm) | Body | | Finishes | Cam Type | | | |
| | | | Die-Cast Zinc | Chrome Plated | With Projection | | |
| | | | nylonamide Plastic | Black Coated | W/O Projection | | |
| | | | Stainless Steel | Natural | | | |

A2333 - Mini Cam Lock - Fixed Grip



✓

Various

✓

✓

✓

Cams: A0203, A0224, A0240 - Keys: Supplied

A2340 - Mini Cam Lock - Fixed Grip



✓

15

✓

✓

✓

Cams: Supplied - Keys: Supplied

A2392 - Mini Cam Lock - Wing Handle - Fixed Grip



✓

24

✓

✓

✓

Cams: A0203, A0224, A0240 - Keys: Supplied

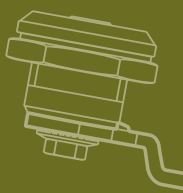

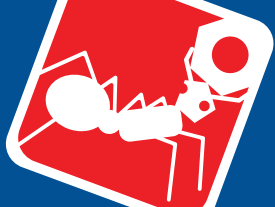

Compression Locks

lever latch - adjustable grip - flush trigger - zinc

Compression Latches

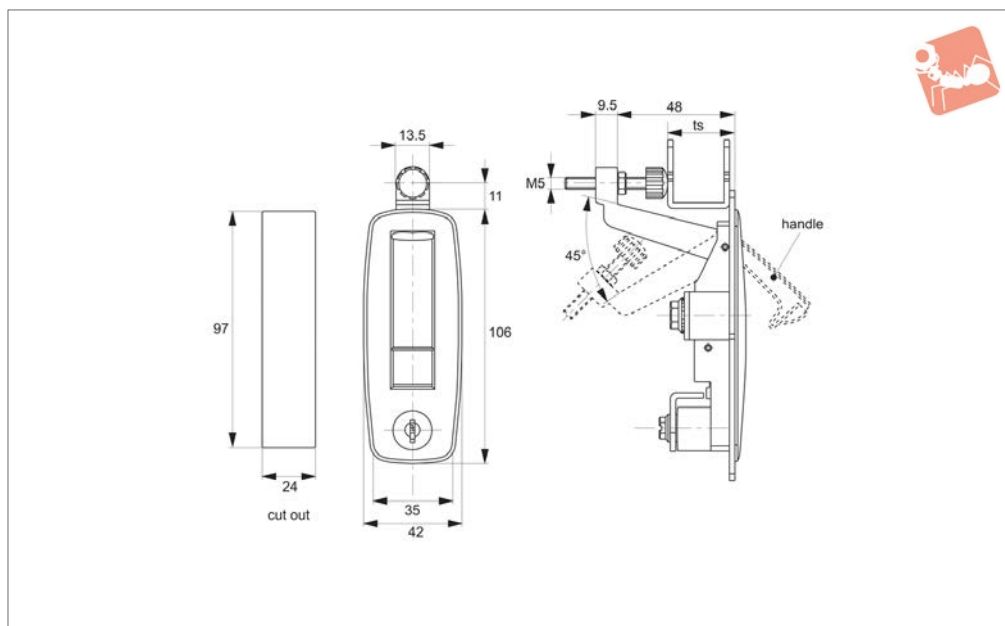

A1701

COMPRESSION LATCHES

Material

Body and handle and button: die cast zinc, black power coated.

Cylinder lock: die cast zinc.

Screw: steel, white zinc plated.

Supplied with: KEY.

Technical Notes

Grip length can be adjusted via M5 clamping screw to suit your application.

Suitable for panel thickness 20-35mm. For installation cut out see diagram.

Tips

Quick-open, easy assembling, by adjusting screw meets the needs of distance control.

| Order No. | Finish | Lock type | ts grip adj. |
|--------------|--------------|---------------|--------------|
| A1701.AW0310 | Black Coated | Std. Cylinder | 20-35 |

Compression Latches

Compression Locks

lever latch - adjustable grip - raised trigger - zinc



COMPRESSION LATCHES



A1707

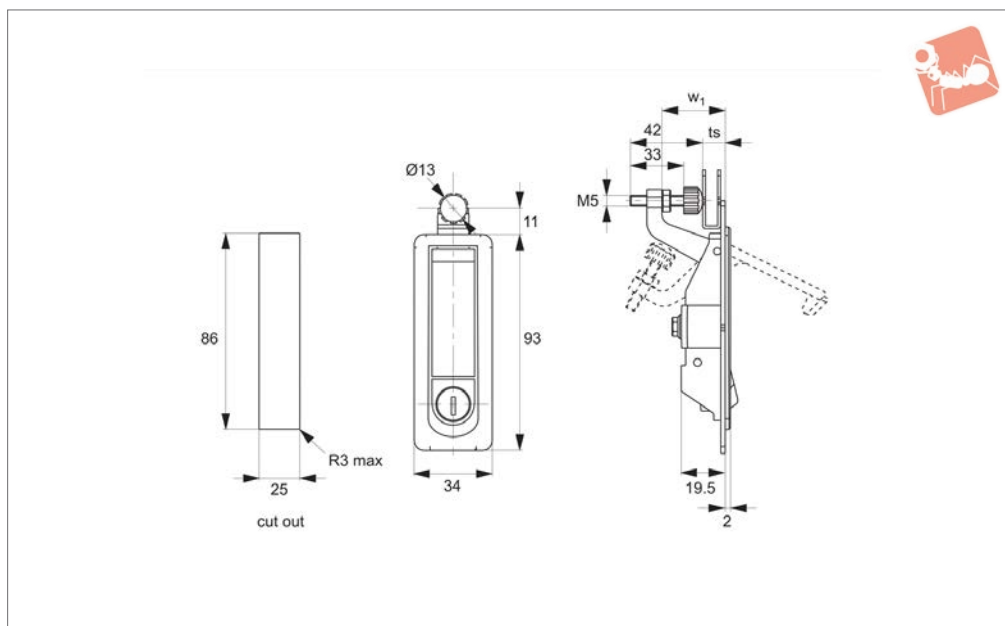

Material

Body and handle and button: die cast zinc, black power coated.

Cylinder lock: die cast zinc.

Screw: steel, white zinc plated.

Supplied with: KEY.

Technical Notes

Grip length can be adjusted via screw between 1 and 20mm. Suitable for panel thickness 1-20mm.

| Order No. | Finish | Lock type | ts grip adj. | w ₁ |
|---------------------|--------------|--------------------------------|--------------|----------------|
| A1707.AW0710 | Black Coated | Std. Cylinder with Keyed Alike | 1-20 | 29 |
| A1707.AW0720 | Black Coated | Blank - No Lock | 1-20 | 29 |
| A1707.AW0910 | Black Coated | Std. Cylinder with Keyed Alike | 17-40 | 50 |
| A1707.AW0920 | Black Coated | Blank - No Lock | 17-40 | 50 |



Compression Locks

lever latch - adjustable grip - zinc

Compression Latches

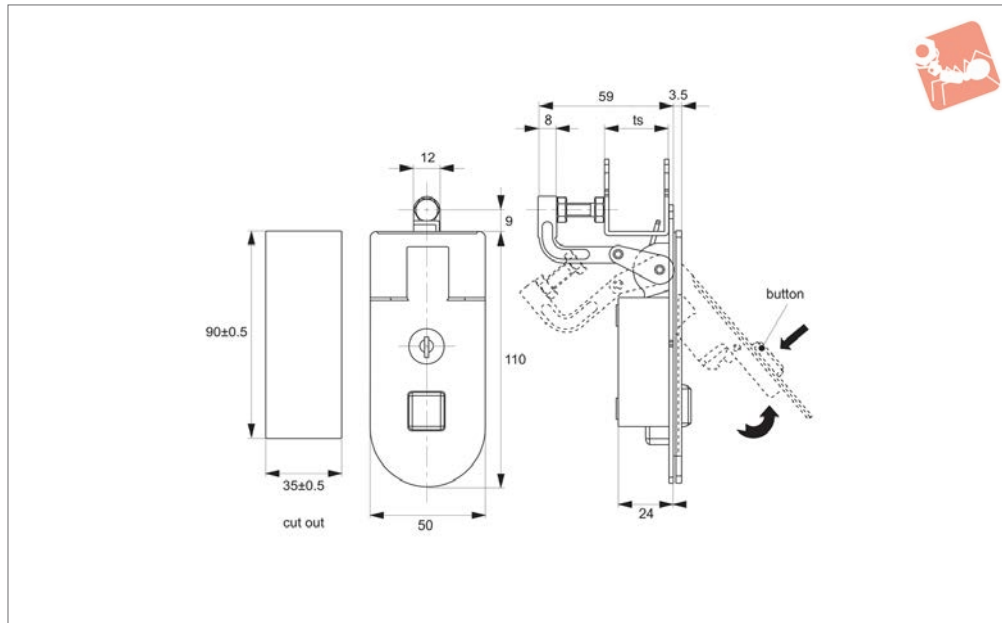

A1751

COMPRESSION LATCHES

Material

Body and handle: die cast zinc, black power coated.
Cylinder lock: die cast zinc.
Screw: steel, white zinc plated.

Supplied with: KEY.

Technical Notes

Grip adjustment 31-48mm.



Tips

Quick-open, easy assembling. Grip length can be adjusted via clamping screw to suit your application.

| Order No. | Finish | Lock type | ts grip adj. |
|--------------|--------------|---------------|--------------|
| A1751.AW0310 | Black Coated | Std. Cylinder | 31-48 |



| Miscellaneous Cut out | Actuation Method | | | Body length (mm) | Body | | | Finishes | | | Cam Type | | |
|---|------------------|---------------|-------------|------------------|---------------|-------------------|-----------------|---------------|--------------|---------|-----------------|----------------|-----------|
| | Insert Driver | Cylinder Lock | Manual/Grip | | Die-Cast Zinc | Polyamide Plastic | Stainless Steel | Chrome Plated | Black Coated | Natural | With Projection | W/O Projection | IP Rating |
| A1192 - Mini Cam Latch - Wing Handle - Fixed Grip | | | | | | | | | | | | | |
|  | | | ✓ | 10 | ✓ | | | ✓ | | | | | |
| Cams: Supplied - Keys: N/A | | | | | | | | | | | | | |
| A1506 - Panel Latches - Fixed Grip | | | | | | | | | | | | | |
|  | ✓ | | | 25 | | ✓ | | | ✓ | | | 54 | |
| Cams: Supplied - Keys: A0102 | | | | | | | | | | | | | |
| A1520 - Cam Lock - Fixed Grip | | | | | | | | | | | | | |
|  | ✓ | | | 18 | ✓ | | | | ✓ | | | | |
| Cams: Supplied - Keys: A0102 | | | | | | | | | | | | | |
| A1546 - Panel Latch - Uncovered | | | | | | | | | | | | | |
|  | | | ✓ | | ✓ | | | ✓ | | | | | |
| Cams: Supplied - Keys: N/A | | | | | | | | | | | | | |
| A1561 - Panel Latch - with Cover | | | | | | | | | | | | | |
|  | ✓ | | | 22,5 | ✓ | | | | ✓ | | | | |
| Cams: Supplied - Keys: N/A | | | | | | | | | | | | | |
| A1701 - Compression Latch - Lever Latch - Flush Trigger | | | | | | | | | | | | | |
|  | ✓ | | | | ✓ | | | ✓ | | | | | |
| Cams: N/A - Keys: Supplied | | | | | | | | | | | | | |
| A1707 - Compression Latch - Lever Latch - Raised Trigger | | | | | | | | | | | | | |
|  | ✓ | | | 19 | ✓ | | | ✓ | | | | | |
| Cams: Supplied - Keys: Supplied | | | | | | | | | | | | | |
| A1751 - Compression Latch - Lever Latch | | | | | | | | | | | | | |
|  | | | ✓ | | ✓ | | | ✓ | | | | | |
| Cams: N/A - Keys: Supplied | | | | | | | | | | | | | |

| Miscellaneous Cut out | Actuation Method | | | Body length (mm) | Body | | | Finishes | | | Cam Type | IP Rating |
|--|------------------|---------------|-------------|------------------|---------------|-------------------|-----------------|---------------|--------------|---------|----------|-----------|
| | Insert Driver | Cylinder Lock | Manual/Grip | | Die-Cast Zinc | Polyamide Plastic | Stainless Steel | Chrome Plated | Black Coated | Natural | | |
| A4241 - Cam Latch - with Rod Control - Extended Cover | | | | | | | | | | | | |
|  | ✓ | | | | ✓ | | | | ✓ | | ✓ | 40 |
| Cams: A0203, A0224, A0240 - Keys: A0102 | | | | | | | | | | | | |
| A4260 - Cam Lock - with Rod Control - Wing Handle - Extended Cover | | | | | | | | | | | | |
|  | | ✓ | | | | ✓ | | | | ✓ | | 54 |
| Cams: A0203, A0224, A0240 - Keys: A0102 | | | | | | | | | | | | |
| A4221 - Cam Latch - with Rod Control - with Cover | | | | | | | | | | | | |
|  | ✓ | | | Various | ✓ | | | | | ✓ | | |
| Cams: A0203, A0224 - Keys: A0102 | | | | | | | | | | | | |



Compression Lock - T-handle - Flexi- T-handle - fixed grip - zinc

Compression Latches

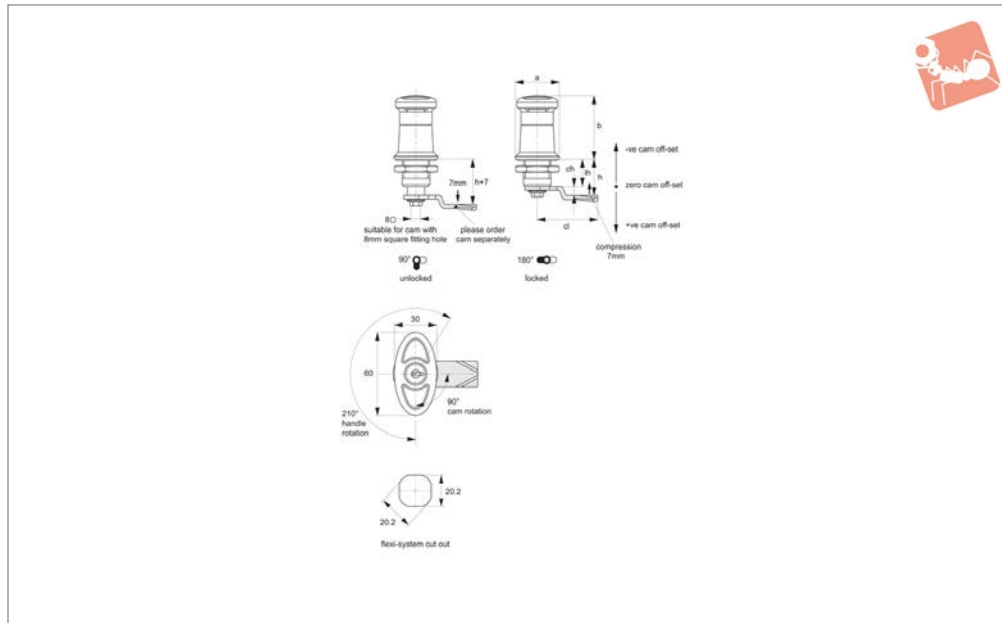

A1801

COMPRESSION LATCHES

Material

Body & handle: die cast zinc, nanometer coated.

Supplied with: Key.

Not supplied: CAM - order separately.

Technical Notes

Order cam and key separately.

Cams: see suitable cam A0203 and A0224. Select „without projection“ cam type.

Dimensions ch and cl relate to cam. Use formula to calculate ch (required cam off-set), and refer to cam selection chart;
 $ch = h - lh$ where;
 ch = required cam off-set/height.
 h = grip length (distance between inside of latch face and front of cam).
 lh = body length of cam latch/lock to be used (see product table below).

Keys: see A0102.

Tips

Compression locks provide sealing of enclosures to reduce vibration and to provide noise isolation.

Action:

210° handle rotation, 90° cam rotation.

| Order No. | Lock type | a | b | lh |
|--------------|-----------------|----|----|----|
| A1801.AW0032 | Std. Cylinder | 32 | 46 | 18 |
| A1801.AW0132 | Blank - No Lock | 32 | 46 | 18 |



Material

Shaft: steel, white zinc plated.

Supplied with: Key.

Not supplied: CAM - order separately.

Technical Notes

Order cam and key separately.

Cams: see suitable cam A0231 and A0233.

Select „without projection“ cam type.

Dimensions ch and cl relate to cam. Use

formula to calculate ch (required cam offset), and refer to cam selection chart;

$$ch = h - lh \text{ where;}$$

ch = required cam off-set/height.

h = grip length (distance between inside of latch face and front of cam).

lh = body length of cam latch/lock to be used (see product table below).

Keys: see A0102.

Tips

Compression locks provide sealing of

enclosures to reduce vibration and to provide noise isolation.

Adjustable grip type has an extended stem which can be cut in length to best suit your application.

Action:

210° handle rotation, 90° cam rotation.

Provides a 7mm compression stroke.

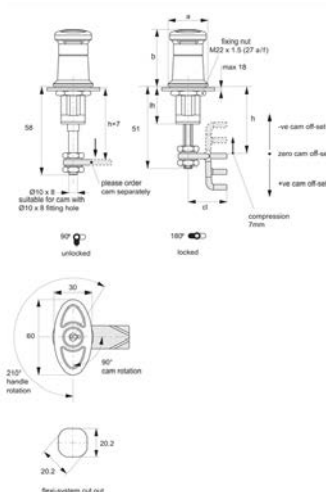

| Order No. | Lock type | a | b | lh |
|--------------|-----------------|----|----|----|
| A1810.AW0032 | Std. Cylinder | 32 | 46 | 18 |
| A1810.AW0132 | Blank - No Lock | 32 | 46 | 18 |